

ELEVATION CERTIFICATE

IMPORTANT: Follow the instructions on pages 1-9.

OMB No. 1660-0008
 Expiration Date: July 31, 2015

SECTION A - PROPERTY INFORMATION

A1. Building Owner's Name Beau Yarbrough		FOR INSURANCE COMPANY USE	
A2. Building Street Address 2112 Victory Avenue		Policy Number:	
City Galveston	State TX	Company NAIC Number:	
A3. Property Description (Lot and Block Numbers, Tax Parcel Number, Legal Description, etc.) Lot 3 Block 18 Hollywood Heights		ZIP Code 77551	
A4. Building Use (e.g., Residential, Non-Residential, Addition, Accessory, etc.) Residential		Horizontal Datum: <input type="checkbox"/> NAD 1927 <input checked="" type="checkbox"/> NAD 1983	
A5. Latitude/Longitude: Lat. 29° 16' 34.99" N Long. 94° 50' 07.74" W			
A6. Attach at least 2 photographs of the building if the Certificate is being used to obtain flood insurance.			
A7. Building Diagram Number 5			
A8. For a building with a crawlspace or enclosure(s):			
a) Square footage of crawlspace or enclosure(s)	N/A sq ft	A9. For a building with an attached garage:	
b) No. of permanent flood openings in the crawlspace or enclosure(s) within 1.0 foot above adjacent grade	N/A	a) Square footage of attached garage	N/A sq ft
c) Total net area of flood openings in A8.b	N/A sq in	b) Number of permanent flood openings in the attached garage within 1.0 foot above adjacent grade	N/A
d) Engineered flood openings? <input type="checkbox"/> Yes <input type="checkbox"/> No		c) Total net area of flood openings in A9.b	N/A sq in
		d) Engineered flood openings? <input type="checkbox"/> Yes <input type="checkbox"/> No	

SECTION B - FLOOD INSURANCE RATE MAP (FIRM) INFORMATION

B1. NFIP Community Name City of Galveston 485469		B2. County Name Galveston		B3. State TX	
B4. Map/Panel Number 485469 0024	B5. Suffix E	B6. FIRM Index Date 12/6/02	B7. FIRM Panel Effective/Revised Date 12/6/02	B8. Flood Zone(s) AE	B9. Base Flood Elevation(s) (Zone AO, use base flood depth) 11
B10. Indicate the source of the Base Flood Elevation (BFE) data or base flood depth entered in Item B9: <input type="checkbox"/> FIS Profile <input checked="" type="checkbox"/> FIRM <input type="checkbox"/> Community Determined <input type="checkbox"/> Other/Source: _____					
B11. Indicate elevation datum used for BFE in Item B9: <input type="checkbox"/> NGVD 1929 <input checked="" type="checkbox"/> NAVD 1988 <input type="checkbox"/> Other/Source: _____					
B12. Is the building located in a Coastal Barrier Resources System (CBRS) area or Otherwise Protected Area (OPA)? <input type="checkbox"/> Yes <input checked="" type="checkbox"/> No Designation Date: _____ / _____ / _____ <input type="checkbox"/> CBRS <input type="checkbox"/> OPA					

SECTION C - BUILDING ELEVATION INFORMATION (SURVEY REQUIRED)

C1. Building elevations are based on: Construction Drawings* Building Under Construction* Finished Construction
 *A new Elevation Certificate will be required when construction of the building is complete.

C2. Elevations - Zones A1-A30, AE, AH, A (with BFE), VE, V1-V30, V (with BFE), AR, AR/A, AR/AE, AR/A1-A30, AR/AH, AR/AO. Complete Items C2.a-h below according to the building diagram specified in Item A7. In Puerto Rico only, enter meters.

Benchmark Utilized: **COG BM(s)** Vertical Datum: **NAVD 88**

Indicate elevation datum used for the elevations in items a) through h) below. NGVD 1929 NAVD 1988 Other/Source: _____

Datum used for building elevations must be the same as that used for the BFE.

a) Top of bottom floor (including basement, crawlspace, or enclosure floor)	6.0 feet
b) Top of the next higher floor	N/A feet
c) Bottom of the lowest horizontal structural member (V Zones only)	N/A feet
d) Attached garage (top of slab)	N/A feet
e) Lowest elevation of machinery or equipment servicing the building (Describe type of equipment and location in Comments)	6.0 feet
f) Lowest adjacent (finished) grade next to building (LAG)	3.9 feet
g) Highest adjacent (finished) grade next to building (HAG)	4.1 feet
h) Lowest adjacent grade at lowest elevation of deck or stairs, including structural support	3.9 feet

SECTION D - SURVEYOR, ENGINEER, OR ARCHITECT CERTIFICATION

This certification is to be signed and sealed by a land surveyor, engineer, or architect authorized by law to certify elevation information. I certify that the information on this Certificate represents my best efforts to interpret the data available. I understand that any false statement may be punishable by fine or imprisonment under 18 U.S. Code, Section 1001.

Check here if comments are provided on back of form.
 Check here if attachments: pictures

Were latitude and longitude in Section A provided by a licensed land surveyor? Yes No

Certifier's Name **Laurence C. Wall** License Number **4814**

Title **RPLS** Company Name **TLTS, Inc.**

Address **1801 Moody Avenue** City **Galveston** State **TX** ZIP Code **77550-8015**

Signature *[Signature]* Date **1/28/15** Telephone **(409)765-8883**

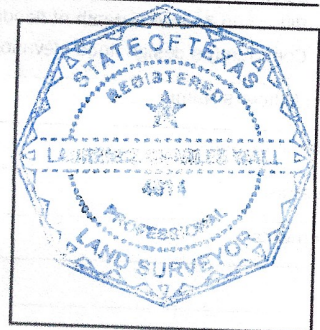

ELEVATION CERTIFICATE, page 2

IMPORTANT: In these spaces, copy the corresponding information from Section A.	FOR INSURANCE COMPANY USE
Building Street Address (including Apt., Unit, Suite, and/or Bldg. No.) or P.O. Route and Box No.	Policy Number:
City State ZIP Code	Company NAIC Number:

SECTION D - SURVEYOR, ENGINEER, OR ARCHITECT CERTIFICATION (CONTINUED)

Copy both sides of this Elevation Certificate for (1) community official, (2) insurance agent/company, and (3) building owner.

Comments *Comments box erroneously checked*

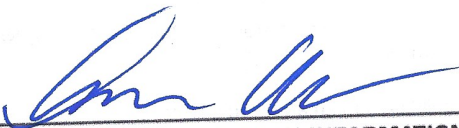
Signature  Date *1/29/30*

SECTION E - BUILDING ELEVATION INFORMATION (SURVEY NOT REQUIRED) FOR ZONE AO AND ZONE A (WITHOUT BFE)

For Zones AO and A (without BFE), complete Items E1-E5. If the Certificate is intended to support a LOMA or LOMR-F request, complete Sections A, B, and C. For Items E1-E4, use natural grade, if available. Check the measurement used. In Puerto Rico only, enter meters.

- E1. Provide elevation information for the following and check the appropriate boxes to show whether the elevation is above or below the highest adjacent grade (HAG) and the lowest adjacent grade (LAG).
 - a) Top of bottom floor (including basement, crawlspace, or enclosure) is _____ feet above or below the HAG.
 - b) Top of bottom floor (including basement, crawlspace, or enclosure) is _____ feet above or below the LAG.
- E2. For Building Diagrams 6-9 with permanent flood openings provided in Section A Items 8 and/or 9 (see pages 8-9 of Instructions), the next higher floor (elevation C2.b in the diagrams) of the building is _____ feet above or below the HAG.
- E3. Attached garage (top of slab) is _____ feet above or below the HAG.
- E4. Top of platform of machinery and/or equipment servicing the building is _____ feet above or below the HAG.
- E5. Zone AO only: If no flood depth number is available, is the top of the bottom floor elevated in accordance with the community's floodplain management ordinance? Yes No Unknown. The local official must certify this information in Section G.

SECTION F - PROPERTY OWNER (OR OWNER'S REPRESENTATIVE) CERTIFICATION

The property owner or owner's authorized representative who completes Sections A, B, and E for Zone A (without a FEMA-issued or community-issued BFE) or Zone AO must sign here. The statements in Sections A, B, and E are correct to the best of my knowledge.

Property Owner or Owner's Authorized Representative's Name _____

Address _____ City _____ State _____ ZIP Code _____

Signature _____ Date _____ Telephone _____

Comments _____ Check here if attachments.

SECTION G - COMMUNITY INFORMATION (OPTIONAL)

The local official who is authorized by law or ordinance to administer the community's floodplain management ordinance can complete Sections A, B, C (or E), and G of this Elevation Certificate. Complete the applicable item(s) and sign below. Check the measurement used in Items G8-G10. In Puerto Rico only, enter meters.

- G1. The information in Section C was taken from other documentation that has been signed and sealed by a licensed surveyor, engineer, or architect who is authorized by law to certify elevation information. (Indicate the source and date of the elevation data in the Comments area below.)
- G2. A community official completed Section E for a building located in Zone A (without a FEMA-issued or community-issued BFE) or Zone AO.
- G3. The following information (Items G4-G9) is provided for community floodplain management purposes.

G4. Permit Number	G5. Date Permit Issued	G6. Date Certificate Of Compliance/Occupancy Issued
G7. This permit has been issued for: <input type="checkbox"/> New Construction <input type="checkbox"/> Substantial Improvement		
G8. Elevation of as-built lowest floor (including basement) of the building:	_____ feet <input type="checkbox"/> meters	Datum _____
G9. BFE or (in Zone AO) depth of flooding at the building site:	_____ feet <input type="checkbox"/> meters	Datum _____
G10. Community's design flood elevation:	_____ feet <input type="checkbox"/> meters	Datum _____
Local Official's Name	Title	
Community Name	Telephone	
Signature	Date	
Comments	_____ <input type="checkbox"/> Check here if attachments.	

BUILDING PHOTOGRAPHS

See Instructions for Item A6.

IMPORTANT: In these spaces, copy the corresponding information from Section A.		FOR INSURANCE COMPANY USE	
Building Street Address (including Apt., Unit, Suite, and/or Bldg. No.) or P.O. Route and Box No. 2112 Victory Avenue		Policy Number:	
City Galveston	State TX	ZIP Code 77551	Company NAIC Number:

If using the Elevation Certificate to obtain NFIP flood insurance, affix at least 2 building photographs below according to the instructions for Item A6. Identify all photographs with date taken; "Front View" and "Rear View"; and, if required, "Right Side View" and "Left Side View." When applicable, photographs must show the foundation with representative examples of the flood openings or vents, as indicated in Section A8. If submitting more photographs than will fit on this page, use the Continuation Page.

January 28, 2015

front



rear



ELEVATION CERTIFICATE

IMPORTANT: Follow the instructions on pages 1-9.

OMB No. 1660-0008
 Expiration Date: July 31, 2015

SECTION A - PROPERTY INFORMATION

FOR INSURANCE COMPANY USE

A1. Building Owner's Name **James Yarbrough, Jr.**

A2. Building Street Address **2112 Victory Avenue - Rear**
 City **Galveston** State **TX**
 ZIP Code **77551**

A3. Property Description (Lot and Block Numbers, Tax Parcel Number, Legal Description, etc.)
Lot 3 Block 18 Hollywood Heights

A4. Building Use (e.g., Residential, Non-Residential, Addition, Accessory, etc.) **Residential**

A5. Latitude/Longitude: Lat. **29° 16' 35.30" N** Long. **94° 50' 06.86" W** Horizontal Datum: NAD 1927 NAD 1983

A6. Attach at least 2 photographs of the building if the Certificate is being used to obtain flood insurance.

A7. Building Diagram Number **1A**

A8. For a building with a crawlspace or enclosure(s):
 a) Square footage of crawlspace or enclosure(s) **N/A** sq ft
 b) No. of permanent flood openings in the crawlspace or enclosure(s) within 1.0 foot above adjacent grade **N/A**
 c) Total net area of flood openings in A8.b **N/A** sq in
 d) Engineered flood openings? Yes No

A9. For a building with an attached garage:
 a) Square footage of attached garage **N/A** sq ft
 b) Number of permanent flood openings in the attached garage within 1.0 foot above adjacent grade **N/A**
 c) Total net area of flood openings in A9.b **N/A** sq in
 d) Engineered flood openings? Yes No

SECTION B - FLOOD INSURANCE RATE MAP (FIRM) INFORMATION

B1. NFIP Community Name **City of Galveston 485469** B2. County Name **Galveston** B3. State **TX**

B4. Map/Panel Number **485469 0024** B5. Suffix **E** B6. FIRM Index Date **12/6/02** B7. FIRM Panel Effective/Revised Date **12/6/02** B8. Flood Zone(s) **AE** B9. Base Flood Elevation(s) (Zone AO, use base flood depth) **11**

B10. Indicate the source of the Base Flood Elevation (BFE) data or base flood depth entered in Item B9:
 FIS Profile FIRM Community Determined Other/Source: _____

B11. Indicate elevation datum used for BFE in Item B9: NGVD 1929 NAVD 1988 Other/Source: _____

B12. Is the building located in a Coastal Barrier Resources System (CBRS) area or Otherwise Protected Area (OPA)? Yes No
 Designation Date: _____ / _____ / _____ CBRS OPA

SECTION C - BUILDING ELEVATION INFORMATION (SURVEY REQUIRED)

C1. Building elevations are based on: Construction Drawings* Building Under Construction* Finished Construction
 *A new Elevation Certificate will be required when construction of the building is complete.

C2. Elevations - Zones A1-A30, AE, AH, A (with BFE), VE, V1-V30, V (with BFE), AR, AR/A, AR/AE, AR/A1-A30, AR/AH, AR/AO. Complete Items C2.a-h below according to the building diagram specified in Item A7. In Puerto Rico only, enter meters.
 Benchmark Utilized: **COG BM(s)** Vertical Datum: **NAVD 88**

Indicate elevation datum used for the elevations in items a) through h) below. NGVD 1929 NAVD 1988 Other/Source: _____
 Datum used for building elevations must be the same as that used for the BFE.

a) Top of bottom floor (including basement, crawlspace, or enclosure floor) **4.1** feet
 b) Top of the next higher floor **12.2** feet
 c) Bottom of the lowest horizontal structural member (V Zones only) **N/A** feet
 d) Attached garage (top of slab) **N/A** feet
 e) Lowest elevation of machinery or equipment servicing the building (Describe type of equipment and location in Comments) **4.1** feet
 f) Lowest adjacent (finished) grade next to building (LAG) **3.9** feet
 g) Highest adjacent (finished) grade next to building (HAG) **4.1** feet
 h) Lowest adjacent grade at lowest elevation of deck or stairs, including structural support **3.9** feet

SECTION D - SURVEYOR, ENGINEER, OR ARCHITECT CERTIFICATION

This certification is to be signed and sealed by a land surveyor, engineer, or architect authorized by law to certify elevation information. I certify that the information on this Certificate represents my best efforts to interpret the data available. I understand that any false statement may be punishable by fine or imprisonment under 18 U.S. Code, Section 1001.

Check here if comments are provided on back of form. Were latitude and longitude in Section A provided by a licensed land surveyor? Yes No

Check here if attachments: pictures

Certifier's Name **Laurence C. Wall** License Number **4814**

Title **RPLS** Company Name **TLTS, Inc.**

Address **1801 Moody Avenue** City **Galveston** State **TX** ZIP Code **77550-8015**

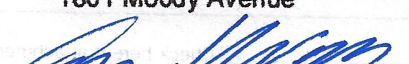
Signature  Date **1/28/15** Telephone **(409)765-8883**

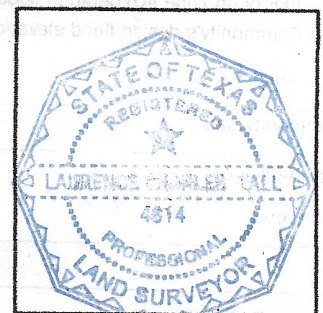

ELEVATION CERTIFICATE, page 2

IMPORTANT: In these spaces, copy the corresponding information from Section A.	FOR INSURANCE COMPANY USE
Building Street Address (including Apt., Unit, Suite, and/or Bldg. No.) or P.O. Route and Box No. 2112 Victory Lane	Policy Number:
City Galveston State TX ZIP Code 77551	Company NAIC Number:

SECTION D – SURVEYOR, ENGINEER, OR ARCHITECT CERTIFICATION (CONTINUED)

Copy both sides of this Elevation Certificate for (1) community official, (2) insurance agent/company, and (3) building owner.

Comments
No access to interior. C2. e) = a)

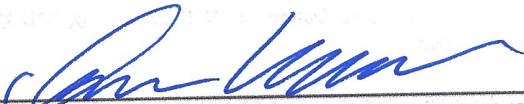
Signature  Date 1/29/15

SECTION E – BUILDING ELEVATION INFORMATION (SURVEY NOT REQUIRED) FOR ZONE AO AND ZONE A (WITHOUT BFE)

For Zones AO and A (without BFE), complete Items E1–E5. If the Certificate is intended to support a LOMA or LOMR-F request, complete Sections A, B, and C. For Items E1–E4, use natural grade, if available. Check the measurement used. In Puerto Rico only, enter meters.

- E1. Provide elevation information for the following and check the appropriate boxes to show whether the elevation is above or below the highest adjacent grade (HAG) and the lowest adjacent grade (LAG).
 - a) Top of bottom floor (including basement, crawlspace, or enclosure) is _____ feet above or below the HAG.
 - b) Top of bottom floor (including basement, crawlspace, or enclosure) is _____ feet above or below the LAG.
- E2. For Building Diagrams 6–9 with permanent flood openings provided in Section A Items 8 and/or 9 (see pages 8–9 of Instructions), the next higher floor (elevation C2.b in the diagrams) of the building is _____ feet above or below the HAG.
- E3. Attached garage (top of slab) is _____ feet above or below the HAG.
- E4. Top of platform of machinery and/or equipment servicing the building is _____ feet above or below the HAG.
- E5. Zone AO only: If no flood depth number is available, is the top of the bottom floor elevated in accordance with the community's floodplain management ordinance? Yes No Unknown. The local official must certify this information in Section G.

SECTION F – PROPERTY OWNER (OR OWNER'S REPRESENTATIVE) CERTIFICATION

The property owner or owner's authorized representative who completes Sections A, B, and E for Zone A (without a FEMA-issued or community-issued BFE) or Zone AO must sign here. The statements in Sections A, B, and E are correct to the best of my knowledge.

Property Owner or Owner's Authorized Representative's Name _____

Address _____	City _____	State _____	ZIP Code _____
Signature _____	Date _____	Telephone _____	

Comments _____

Check here if attachments.

SECTION G – COMMUNITY INFORMATION (OPTIONAL)

The local official who is authorized by law or ordinance to administer the community's floodplain management ordinance can complete Sections A, B, C (or E), and G of this Elevation Certificate. Complete the applicable item(s) and sign below. Check the measurement used in Items G8–G10. In Puerto Rico only, enter meters.

- G1. The information in Section C was taken from other documentation that has been signed and sealed by a licensed surveyor, engineer, or architect who is authorized by law to certify elevation information. (Indicate the source and date of the elevation data in the Comments area below.)
- G2. A community official completed Section E for a building located in Zone A (without a FEMA-issued or community-issued BFE) or Zone AO.
- G3. The following information (Items G4–G9) is provided for community floodplain management purposes.

G4. Permit Number _____	G5. Date Permit Issued _____	G6. Date Certificate Of Compliance/Occupancy Issued _____
-------------------------	------------------------------	---

G7. This permit has been issued for: New Construction Substantial Improvement

G8. Elevation of as-built lowest floor (including basement) of the building: _____ feet meters Datum _____

G9. BFE or (in Zone AO) depth of flooding at the building site: _____ feet meters Datum _____

G10. Community's design flood elevation: _____ feet meters Datum _____

Local Official's Name _____	Title _____
Community Name _____	Telephone _____
Signature _____	Date _____

Comments _____

Check here if attachments.

BUILDING PHOTOGRAPHS

See Instructions for Item A6.

IMPORTANT: In these spaces, copy the corresponding information from Section A.			FOR INSURANCE COMPANY USE
Building Street Address (including Apt., Unit, Suite, and/or Bldg. No.) or P.O. Route and Box No. 2112 Victory Avenue - Rear			Policy Number:
City Galveston	State TX	ZIP Code 77551	Company NAIC Number:

If using the Elevation Certificate to obtain NFIP flood insurance, affix at least 2 building photographs below according to the instructions for Item A6. Identify all photographs with date taken; "Front View" and "Rear View"; and, if required, "Right Side View" and "Left Side View." When applicable, photographs must show the foundation with representative examples of the flood openings or vents, as indicated in Section A8. If submitting more photographs than will fit on this page, use the Continuation Page.

January 28, 2015

front



rear

