

G.L. No. 03203123 - Buyer: GAYLE YARBROUGH

Lot Thirty (30), of Louis Hi-Byo Campsites, Second Addition, a subdivision in Galveston County, Texas, according to the map or plat thereof recorded in Volume 254-A, Page 88, in the Office of the County Clerk of Galveston County, Texas.

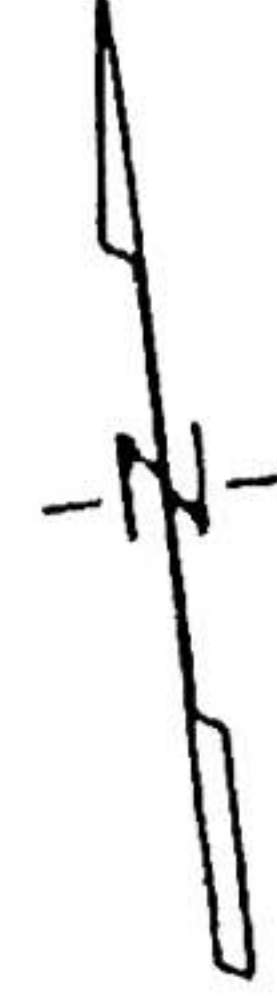

SCALE 1" = 20'

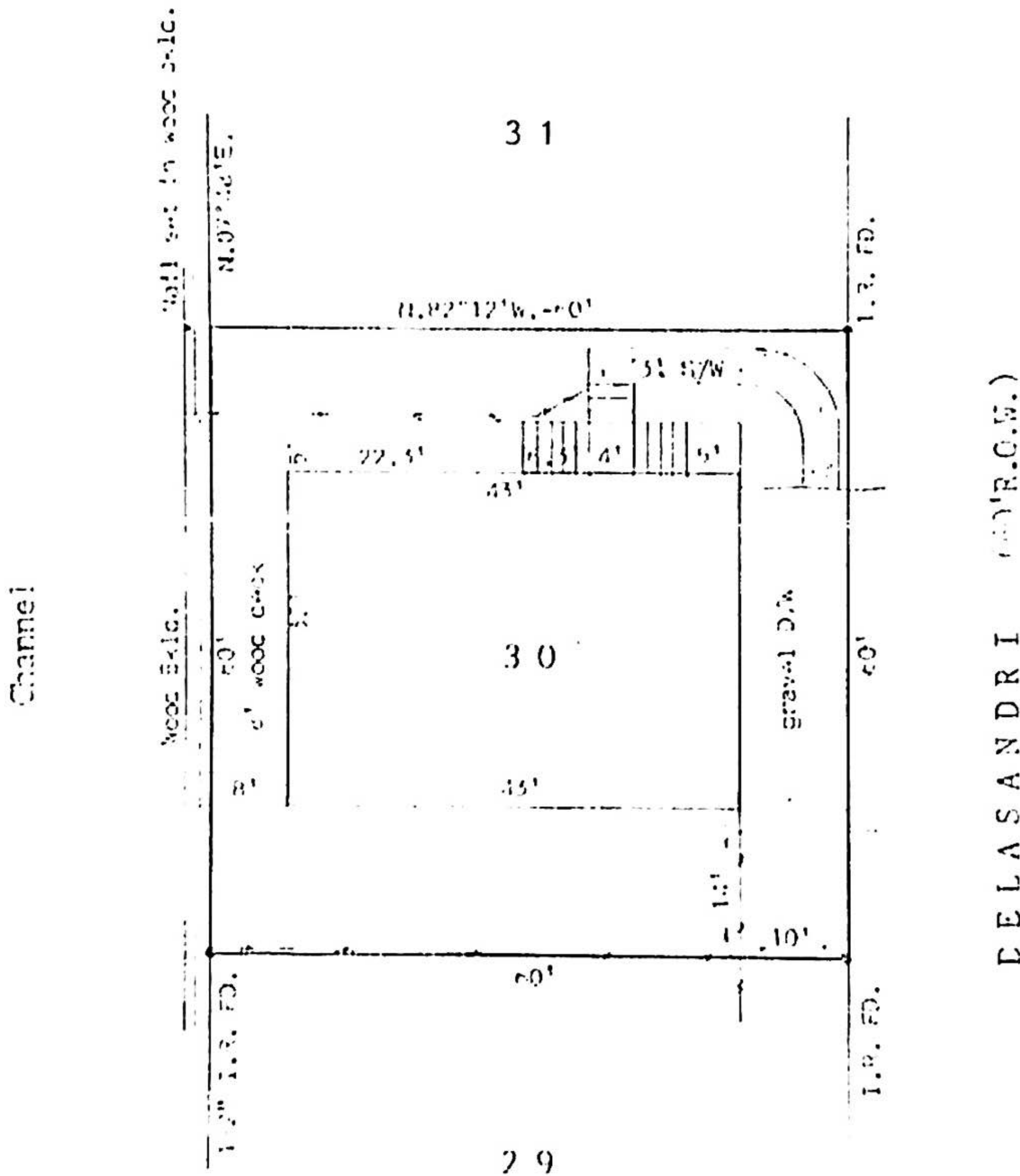

DELA SANDRI (C.O.R.C.M.)

I hereby certify that this is an accurate plat on the above property indicating all improvements thereon which was prepared under my supervision from an actual survey made on the ground on April 28, 2003.

Subject property DOES lie within the 100 year flood plain; Property lies in Zone A-14, elevation 12' according to Map No. 485470 0205 C.



  
 Robert L. Derrick