

NOTE:
THIS SURVEY IS BASED ON A TITLE COMMITMENT REPORT ISSUED BY FIDELITY NATIONAL TITLE INSURANCE COMPANY, GF NO. FAH15006243A, ISSUED ON 06/21/2016.

FLOOD INFORMATION
FIRM: 48201C PANEL: 0670 M
REV. DATE: 06/09/2014
ZONE: "X"

FLOOD INFORMATION PROVIDED HEREON IS BASED ON SCALING THE LOCATION OF THE SUBJECT TRACT ON THE FLOOD INSURANCE RATE MAPS, THE INFORMATION SHOULD BE USED TO DETERMINE FLOOD INSURANCE RATES ONLY AND IS NOT INTENDED TO IDENTIFY SPECIFIC FLOODING CONDITIONS. WE ARE NOT RESPONSIBLE FOR THE F.I.R.M.'S ACCURACY.

I, S. E. LUSCOMBE, a Registered Professional Land Surveyor in the State of Texas, do hereby certify to FIDELITY NATIONAL TITLE INSURANCE COMPANY and that the above map is true and correct according to an actual field survey, made by me or under my supervision, of the property shown hereon or described by field notes accompanying this drawing. I further certify that all easements and rights-of-way of which I have been advised are shown hereon and that, except as shown, there are no apparent visible encroachments, no apparent visible overlapping of improvements and no apparent discrepancies or conflicts in the boundary lines, as of the date of the field survey.

Lot(s) 1, Block 1, WOODCREST SQUARE recorded in Film Code No. 573281, of the Map/Deed and Plat Records of HARRIS County, Texas, located in the JOHN REINERMAN SURVEY, A-642
Borrower: JOHN MONTGOMERY II
Address: 1406 MALONE ST., HOUSTON, TX 77007 GF No. FAH15006243A

SUBJECT TO RESTRICTIVE COVENANTS AND/OR EASEMENTS RECORDED IN: FILM CODE NO. 573281, MAP RECORDS, HARRIS COUNTY, TEXAS

PROPERTY PHOTOGRAPH:



LAND TITLE SURVEY

JOB NO.:	1606005859	NO.	REVISION	DATE
DATE:	06/24/16			
DRAWN BY:	TD			
APPROVED BY:	SEL			

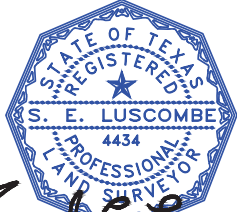

Samuel E. Luscombe

FIRM REGISTRATION NO. 10190700
S. E. LUSCOMBE, R.P.L.S.
Registered Professional Land Surveyor
Registration No. 4434
COPYRIGHT ALL RIGHT RESERVED TO OVERLAND CONSORTIUM INC.

Overland Consortium Inc.
Surveyors 131 McKinney Street, Suite 203, Farmersville, TX 75442
Tel: 281-940-8869 Fax: 281-207-6476