

THIS PROPERTY DOES NOT LIE WITHIN THE 100 YEAR FLOOD PLAIN AS PER FIRM PANEL NO. 48339C 0510 F MAP REVISION: 12/19/1996 ZONE X BASED ONLY ON VISUAL EXAMINATION OF MAPS. INACCURACIES OF FEMA MAPS PREVENT EXACT DETERMINATION WITHOUT DETAILED FIELD STUDY

A SUBSURFACE INVESTIGATION WAS BEYOND THE SCOPE OF THIS SURVEY

U.T.S. = UNABLE TO SET
D.C.L. = DIRECTIONAL CONTROL LINE
RECORD BEARING: CABINET G, SHEET 113B, M.C.M.R.

DRAWN BY: LH

I HEREBY CERTIFY THAT THIS SURVEY WAS MADE ON THE GROUND, THAT THIS PLAT CORRECTLY REPRESENTS THE FACTS FOUND AT THE TIME OF SURVEY AND THAT THERE ARE NO ENCROACHMENTS APPARENT ON THE GROUND, EXCEPT AS SHOWN HEREON. THIS SURVEY IS CERTIFIED FOR THIS TRANSACTION ONLY AND ABSTRACTING PROVIDED IN THE ABOVE REFERENCED TITLE COMMITMENT WAS RELIED UPON IN PREPARATION OF THIS SURVEY.

JAMES P. WALKOVIAK
PROFESSIONAL LAND SURVEYOR
NO. 5971
JOB NO. 13-03829
APRIL 15, 2013

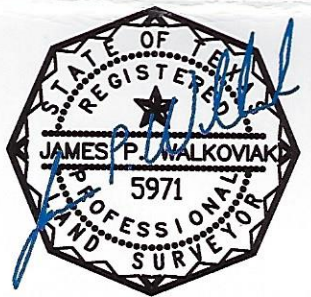

stewart
title

ERIEN ALEXANDER
281-367-5454



PRECISION
surveyors

1-800-LANDSURVEY
www.precisionsurveyors.com

281-496-1586 FAX 281-496-1867 210-829-4944 FAX 210-829-1555
950 THREADNEEDLE STREET SUITE 150 HOUSTON, TEXAS 77079 1777 NE LOOP 410 SUITE 600 SAN ANTONIO, TEXAS 78217