

GF NO. 10001574 OLD REPUBLIC TITLE
 ADDRESS: 4826 SUNSHINE DRIVE
 SUGAR LAND, TEXAS 77479
 BORROWER: JOHN ANDREW PALMER AND
 SHIH-FEN JEN

LOT 15, BLOCK 15 LAKEFIELD, SECTION ONE

ACCORDING TO THE MAP OR PLAT THEREOF RECORDED
 IN VOLUME 34, PAGE 9 OF THE PLAT RECORDS
 OF FORT BEND COUNTY, TEXAS

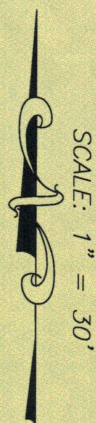

NOTE: CONSENT TO ENCROACHMENT AS PER VOL. 1970, PG. 1163 & VOL. 2019, PG. 18 FBCOR.

NOTE: EASEMENT FOR SOUNDWALL GRANTED TO THE CITY OF SUGAR LAND AS PER FBCCF NO. 2000009266.

NOTE: AN AGREEMENT FOR CABLE TELEVISION SERVICES AND INSTALLATION AS PER VOL. 1107, PG. 869 AND VOL. 1903, PG. 1722 O.R.F.B.C.T.

NOTE: AGREEMENT BY AND BETWEEN DEVELOPER AND H. L. & P. FOR INSTALLATION OF OVERHEAD/UNDERGROUND ELECTRICAL DISTRIBUTION SYSTEM AS PER VOL. 1297, PG. 729 D.R.F.B.C.T.

THIS PROPERTY DOES NOT LIE WITHIN THE 100 YEAR FLOOD PLAIN AS PER FIRM PANEL NO. 48157C 0255 J MAP REVISION: 1/3/97 ZONE X(SHADED) BASED ONLY ON VISUAL EXAMINATION OF MAPS. INACCURACIES OF FEMA MAPS PREVENT EXACT DETERMINATION WITHOUT DETAILED FIELD STUDY

A SUBSURFACE INVESTIGATION WAS BEYOND THE SCOPE OF THIS SURVEY

RECORD BEARING: VOL. 34, PG. 9 P.R.F.B.C.T.

DRAWN BY: MV

I HEREBY CERTIFY THAT THIS SURVEY WAS MADE ON THE GROUND, THAT THIS PLAT CORRECTLY REPRESENTS THE FACTS FOUND AT THE TIME OF SURVEY AND THAT THERE ARE NO ENCROACHMENTS APPARENT ON THE GROUND, EXCEPT AS SHOWN HEREON. THIS SURVEY IS CERTIFIED FOR THIS TRANSACTION ONLY AND ABSTRACTING PROVIDED IN THE ABOVE REFERENCED TITLE COMMITMENT WAS RELIED UPON IN PREPARATION OF THIS SURVEY.

PIOTR A. DEBSKI
 PROFESSIONAL LAND SURVEYOR
 NO. 5902
 JOB NO. 10-03980
 APRIL 28, 2010

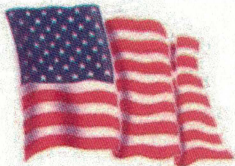
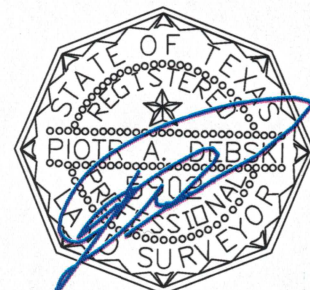

281-265-9500



PRECISION
 surveyors

1-800-LANDSURVEY
 www.precisionurveyors.com

281-496-1586 FAX 281-496-1867
 14925 MEMORIAL DRIVE SUITE B100 HOUSTON, TEXAS 77079

210-829-4941 FAX 210-829-1555
 1777 NE LOOP 410 SUITE 800 SAN ANTONIO, TEXAS 78217