

NOTES:  
 NO RECORDS SEARCH CONTRACTED.  
 SURVEY PREPARED FROM TITLE  
 COMPANY SPECIFICATIONS. CLIENT  
 RELIES SOLELY ON TITLE COMPANY  
 SPECIFICATIONS AS TO RECORD EASEMENTS,  
 RESTRICTIONS, ROADWAYS, RIGHTS-OF-WAY,  
 BUILDING LINES, ENCUMBRANCES, ETC.;  
 CLIENT AND TITLE COMPANY HOLD  
 TLTS, INC. HARMLESS FROM RESPONSIBILITY  
 FOR SAME

- Restrictions as per recorded plat unless otherwise noted
- True ground distances shown
- Bearings assumed as platted
- Vol 1382, Pg 452, OCCGC  
 :10' UE along front  
 :5' x 20' AE along UE  
 :25' front building line  
 :10' side building lines
- Vol 1393, Pg 335, OCCGC  
 :HL&P esmts across roads
- Survey monuments reconciled w/numerous previous surveys

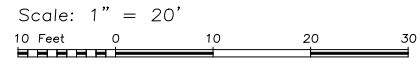

LAND TITLE SURVEY OF A TRACT OF LAND being Lot 30, in Block "K", of JAMAICA BEACH, SECTION 4, a subdivision in Galveston County, Texas, according to the map or plat thereof recorded in Volume 254-A, Page 85 and transferred to Plat Record 4, Map No. 68, both in the Map Records in the Office of the County Clerk of Galveston County, Texas.

Subject property: 16611 Nassau Way  
 Galveston County, Texas  
 To Angela Falkenhagen, Lee Falkenhagen and South-Land Title Co., GF #WE1645484;  
 I hereby certify that this survey was made on the ground under my direct supervision and that this plat correctly represents the facts found at the time of the survey.

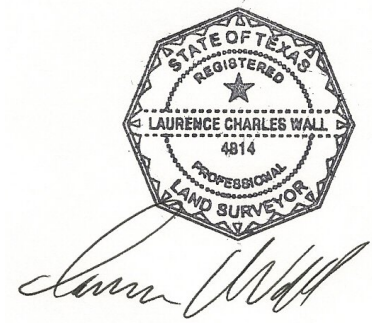

Laurence C. Wall  
 RPLS #4814  
 June 6, 2016