

NATIONAL FLOOD INSURANCE PROGRAM

U.M.D. NO. 5001-V011
Expires December 31, 2004

06-03-067

ELEVATION CERTIFICATE

Important: Read the instructions on pages 1-7.

SECTION A - PROPERTY OWNER INFORMATION

BUILDING OWNER'S NAME: Dennis Welch

BUILDING STREET ADDRESS (including Apt. Unit, Suite, and/or Bldg. No.) OR P.O. ROUTE AND BOX NO.: 150 Deblain

CITY: Freeport STATE: Texas ZIP CODE: 77541

PROPERTY DESCRIPTION (Lot and Block Numbers, Tax Parcel Number, Legal Description, etc.): Lot 13 Block 6 Treasure Island Section 2

BUILDING USE (e.g., Residential, Non-residential, Addition, Accessory, etc. Use a Comments area, if necessary.): residential

LATITUDE/LONGITUDE (OPTIONAL) (##-##-##.## or ##.####): NA HORIZONTAL DATUM: NAD 1927 NAD 1983 SOURCE: GPS (Type): USGS Quad Map Other

SECTION B - FLOOD INSURANCE RATE MAP (FIRM) INFORMATION

B1. NEIP COMMUNITY NAME & COMMUNITY NUMBER <u>Freeport 485450</u>		B2. COUNTY NAME <u>Brazoria</u>		B3. STATE <u>Texas</u>	
B4. MAP AND PANEL NUMBER <u>48039C 0075</u>	B5. SUFFIX <u>I</u>	B6. FIRM INDEX DATE <u>5-4-92</u>	B7. FIRM PANEL EFFECTIVE/REVISED DATE <u>5-4-92</u>	B8. FLOOD ZONE(S) <u>VE</u>	B9. BASE FLOOD ELEVATION (Zone AO, use depth of flooding) <u>16</u>

B10. Indicate the source of the Base Flood Elevation (BFE) data or base flood depth entered in B9.
 FIS Profile FIRM Community Determined Other (Describe):

B11. Indicate the elevation datum used for the BFE in B9: NGVD 1929 NAVD 1988 Other (Describe):

B12. Is the building located in a Coastal Barrier Resources System (CBRS) area or Otherwise Protected Area (OPA)? Yes No
Designation Date:

SECTION C - BUILDING ELEVATION INFORMATION (SURVEY REQUIRED)

C1. Building elevations are based on: Construction Drawings* Building Under Construction* Finished Construction
*A new Elevation Certificate will be required when construction of the building is complete.

C2. Building Diagram Number 5 (Select the building diagram most similar to the building for which this certificate is being completed - see pages 6 and 7. If no diagram accurately represents the building, provide a sketch or photograph.)

C3. Elevations - Zones A1-A30, AE, AH, A (with BFE), VE, V1-V30, V (with BFE), AR, AR/A, AR/AE, AR/A1-A30, AR/AH, AR/AO
Complete items C3.a-f below according to the building diagram specified in item C2. State the datum used. If the datum is different from the datum used for the BFE in Section B, convert the datum to that used for the BFE. Show field measurements and datum conversion calculation. Use the space provided or the Comments area of Section D or Section G, as appropriate, to document the datum conversion.
Datum: NAD 29 Conversion/Comments: NAD 88 adj

Elevation reference mark used AW 0119 Does the elevation reference mark used appear on the FIRM? Yes No

<input type="checkbox"/> a) Top of bottom floor (including basement or enclosure)	<u>5.1</u> ft (m)
<input type="checkbox"/> b) Top of next higher floor	<u>16.2</u> ft (m)
<input type="checkbox"/> c) Bottom of lowest horizontal structural member (V zones only)	<u>14.5</u> ft (m)
<input type="checkbox"/> d) Attached garage (top of slab)	<u>NA</u> ft (m)
<input type="checkbox"/> e) Lowest elevation of machinery and/or equipment servicing the building (Describe in a Comments area.)	<u>NA</u> ft (m)
<input type="checkbox"/> f) Lowest adjacent (finished) grade (LAG)	<u>5.0</u> ft (m)
<input type="checkbox"/> g) Highest adjacent (finished) grade (HAG)	<u>5.1</u> ft (m)
<input type="checkbox"/> h) No. of permanent openings (flood vents) within 1 ft. above adjacent grade	<u>NA</u>
<input type="checkbox"/> i) Total area of all permanent openings (flood vents) in C3.h	<u>NA</u> sq. in. (sq. cm)

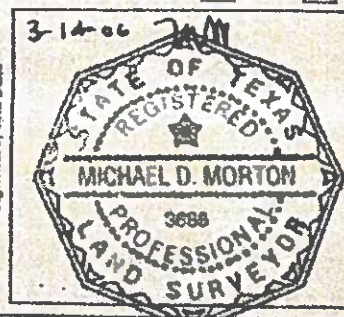

SECTION D - SURVEYOR, ENGINEER, OR ARCHITECT CERTIFICATION

This certification is to be signed and sealed by a land surveyor, engineer, or architect authorized by law to certify elevation information.
I certify that the information in Sections A, B, and C on this certificate represents my best efforts to interpret the data available.
I understand that any false statement may be punishable by fine or imprisonment under 18 U.S. Code, Section 1001.

CERTIFIER'S NAME: Mike Morton LICENSE NUMBER: 3686

TITLE: RIS COMPANY NAME: Survey It

ADDRESS: PO Box 410 CITY: Deblain STATE: Texas ZIP CODE: 77508

SIGNATURE: [Signature] DATE: 3-14-06 TELEPHONE: 281-412-2294