

Building Sketch

Borrower			
Property Address 711 Diamond Leaf Ln			
City Houston	County	State TX	Zip Code 77079-3702
Lender/Cient My Castle Realty			

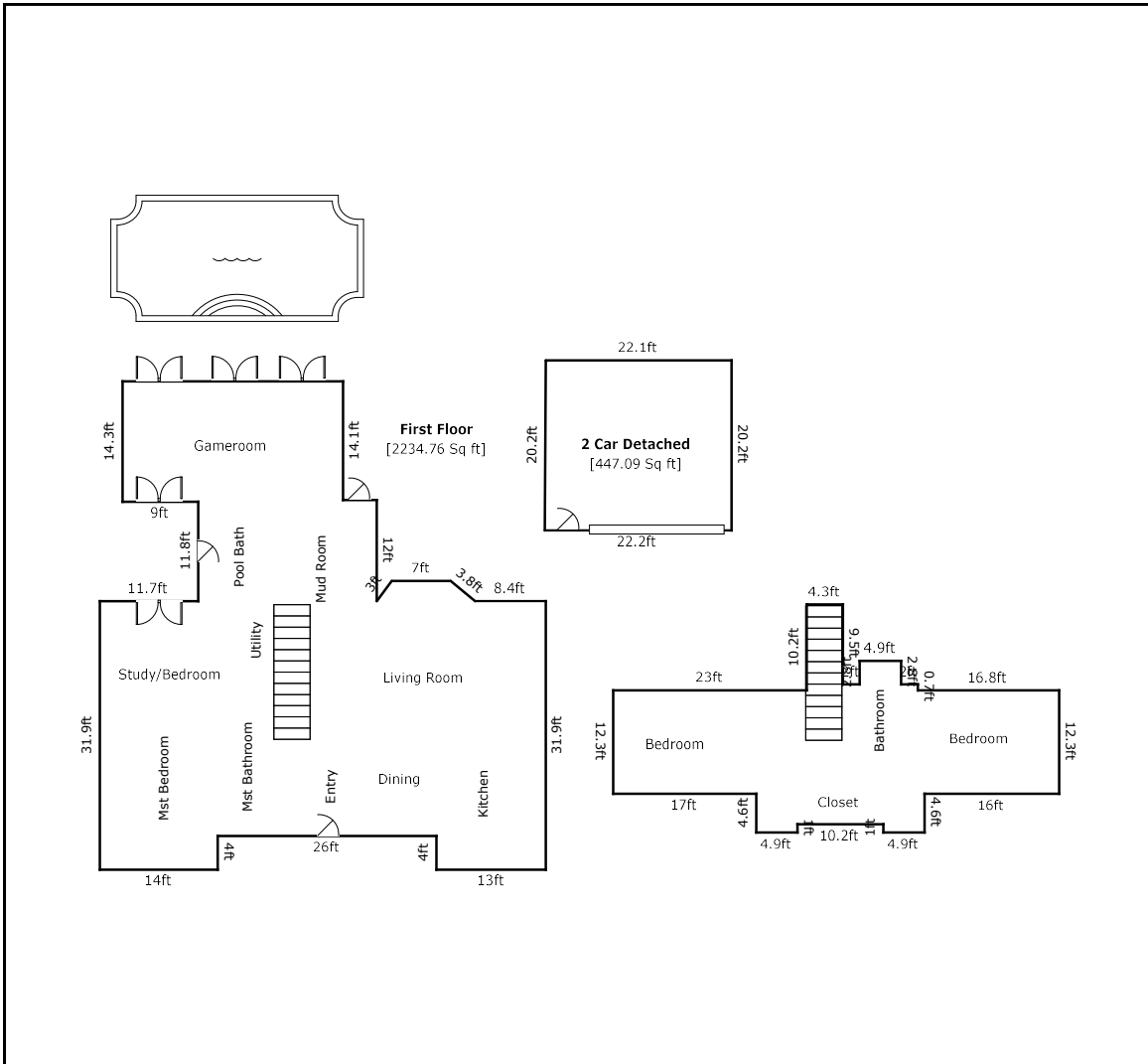

TOTAL Sketch by a la mode, inc.

Area Calculations Summary

Living Area		Calculation Details
First Floor	2234.8 Sq ft	$14.1 \times 26.2 = 369.4$ $30.2 \times 0.2 = 6$ $21.2 \times 11.8 = 250.2$ $0.5 \times 2.9 \times 2.4 = 3.5$ $0.5 \times 2.4 \times 1.8 = 2.2$ $7 \times 2.4 = 16.8$ $27.9 \times 53 = 1478.7$ $4 \times 13 = 52$ $14 \times 4 = 56$
Second Floor	797.5 Sq ft	$4.9 \times 2.8 = 13.7$ $12.3 \times 16 = 196.8$ $4.3 \times 9.5 = 40.8$ $4.9 \times 1 = 4.9$ $13.2 \times 0.7 = 9.2$ $15.9 \times 14 = 222.6$ $15.9 \times 1.1 = 17.5$ $16.9 \times 4.9 = 82.8$ $12.3 \times 17 = 209.1$
Total Living Area (Rounded):	3032 Sq ft	
Non-living Area		
2 Car Detached	447.1 Sq ft	$20.2 \times 22.1 = 447.09$ $0.5 \times 20.2 \times 0.1 = 1.01$