

[Handwritten Signature]

126
TROPHY CANYON DRIVE
 (50' R.O.W.)

[Handwritten Signature]

NOTES:

1. ALL BEARINGS SHOWN HEREON ARE BASED ON THE RECORDED PLAT.
2. SUBJECT TO APPLICABLE RESTRICTIVE COVENANTS LISTED IN ITEM No. 1, SCHEDULE "B" OF TITLE COMMITMENT ISSUED BY NORTH AMERICAN TITLE INSURANCE Co. UNDER G.F. No. 14628-15-04506.

FLOOD MAP:

THIS PROPERTY LIES IN ZONE "X" AS DEPICTED ON COMMUNITY PANEL No. 48339 C 0370 G, DATED: 08-18-14
 THIS INFORMATION IS BASED ON GRAPHIC PLOTTING. WE DO NOT ASSUME RESPONSIBILITY FOR EXACT DETERMINATION

PLAT OF SURVEY
 SCALE: 1" = 20'

© 2016, ALLPOINTS SERVICES, CORP., All Rights Reserved. This original work is protected under copyrights laws, Title 17 U.S. Code Sections 101 & 102. All violators will be prosecuted to the extent of the law. This survey is being provided solely for the use of the recipients and no license has been created, express or implied, to copy the survey except as is necessary in conjunction with the original transaction, which shall take place within ninety (90) days from the date adjacent to the signature line herein.

FOR: RYAN GRAHAM
 JESSICA GRAHAM
 ADDRESS: 126 TROPHY
 CANYON DRIVE
 ALLPOINTS JOB #: LH101672 CM
 G.F.: 14628-15-04506



ALLPOINTS SERVICES CORP
 PHONE: 713-468-7707
 T.B.P.L.S. FIRM No. 10122600

**LOT 29, BLOCK 1,
 WOODFOREST, SECTION 49,
 CAB. "Z", SHTS. 3099-3102, MAP RECORDS,
 MONTGOMERY COUNTY, TEXAS**

I HEREBY CERTIFY THAT THIS PLAT REPRESENTS THE RESULTS OF A SURVEY MADE ON THE GROUND, ON THE 11TH DAY OF JANUARY, 2016.

[Handwritten Signature]

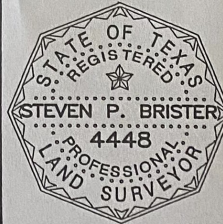

ALLPOINTS SERVICES CORP. COMMERCIAL/BUILDER DIVISION 1515 WITTE ROAD HOUSTON, TEXAS 77080