

BEARINGS ARE BASED AS SHOWN HEREON.  
 CM DENOTES CONTROLLING MONUMENT.

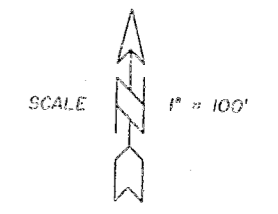

BUYER:  
 NEIL LEE COLQUITT

° SURVEY PLAT SHOWING °

1.933 ACRES OF LAND AS SITUATED IN THE S. C. HIROMS SURVEY, A-37, POLK COUNTY, TEXAS, AND BEING THE SAME AS THAT CERTAIN CALLED 1.927 ACRE TRACT CONVEYED TO JOSEPH CORMIER AND WIFE, THELMA CORMIER, BY DEED RECORDED IN VOLUME 773, PAGE 634 OF THE OFFICIAL RECORDS OF SAID COUNTY AND ALSO BEING THAT CERTAIN TRACT CONVEYED TO ANNA ELLEN SMITH BY SHERIFF'S DEED RECORDED IN VOLUME 1678, PAGE 480 OF THE OFFICIAL RECORDS OF SAID POLK COUNTY, TEXAS.

TO THE LIEN HOLDER AND/OR THE OWNER OF THE PREMISES SHOWN, AND TO ANY TITLE GUARANTY COMPANY:

I, JAMES K. JOHNSON, REGISTERED PROFESSIONAL LAND SURVEYOR No. 1962, DO HEREBY CERTIFY THAT THIS SURVEY WAS MADE ON THE GROUND OF THE PROPERTY LEGALLY SHOWN HEREON, IS CORRECT AND THAT THERE ARE NO APPARENT DISCREPANCIES, CONFLICTS, SHORTAGES IN AREA, BOUNDARY LINE CONFLICTS, ENCROACHMENTS, OVERLAPPING OF IMPROVEMENTS, EASEMENTS, OR RIGHT OF WAYS, EXCEPT AS SHOWN HEREON, AND THAT SAID PROPERTY HAS ACCESS TO AND FROM A DEDICATED ROADWAY.

SURVEYED: JULY 2, 2012

BY: *James K. Johnson*  
 JAMES K. JOHNSON, R.P.L.S. No. 1962, TEXAS

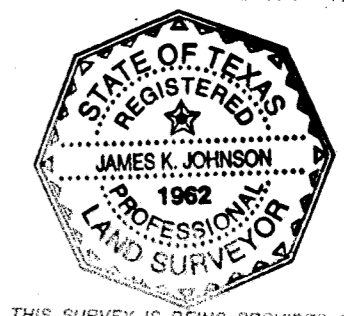

COPYRIGHT 2012 LIVINGSTON SURVEYING & MAPPING CORPORATION. THIS SURVEY IS BEING PROVIDED SOLELY FOR THE USE OF THE CURRENT PARTIES AND IT IS NOT TO BE REPRODUCED, ALTERED OR REUSED FOR ANY SUBSEQUENT TRANSACTION.