

- NOTES:
- # DENOTES WOOD FENCE.
 - SUBJECT TO RESTRICTIONS PER H.C.C.F. NOS. G131238, G181206, G302041, L810578, M620502, & N171260.
 - ESMT. RIGHTS RESERVED BY H.C.C.F. NOS. G131238, G181206, & L810278.
 - BLDG. LINE RESTRICTIONS BY H.C.C.F. NO. G131238.
 - 3' D.E. BY H.C.C.F. NO. G131238.
 - 2' CABLE T.V. SERVICE ESMT. BY H.C.C.F. NO. G131238.

ALL BEARINGS BASED ON RECORDED PLAT.
 FLOOD ZONE DETERMINED BY GRAPHIC PLOTTING ONLY. WE DO NOT ASSUME RESPONSIBILITY FOR EXACT DETERMINATION.
 THIS SURVEY HAS BEEN COMPILED IN ACCORDANCE WITH INFORMATION CONTAINED IN THE TITLE COMMITMENT REFERENCED IN GF NO. 208536

LOT	6	BLOCK	3	SECTION	6	SUBDIVISION	COPPERFIELD SOUTHDOWN VILLAGE	
RECORDATION	VOL. 341, PG. 59, H.C.M.R.		COUNTY	HARRIS	STATE	TEXAS	SURVEY	
LENDER	TRINITY MORTGAGE		TITLE CO.	CHICAGO TITLE CO.		GF NO.	208536	
PURCHASER	LEONARD T. FOJT AND CHERYL A. FOJT				JOB NO.	20367K		
ADDRESS	15922 ECHO LODGE DRIVE, HOUSTON, TEXAS						dated	11-6-96

This lot DOES NOT lie in the 100 year flood plan and is in ZONE "X" as located by the Federal Insurance Administration designated Flood Hazard Area by Community Panel No. 480287 0420J

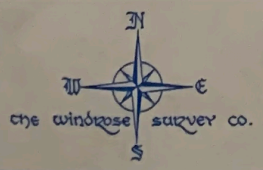

I do hereby certify that this survey was this day made on the ground and that this plat correctly represents the property legally described hereon (or on attached sheet). That the facts found at the time of this survey show the improvements and that there are no encroachments apparent on the ground, except as shown.

[Signature]

FIELD WORK	03-04-97	RW
DRAFTED BY	03-04-97	J.Y.
CHECKED BY	03-04-97	WP
KEY MAP NO.	40BJ	

THE WINDROSE SURVEY COMPANY
 11301 Richmond, Suite K105
 Houston, Texas 77082
 (281) 558-8006