

Building Sketch

Borrower	Cullen Christopher Greer & Colleen Harris Greer			
Property Address	18319 Edenberry Dr			
City	Cypress	County	Harris	State TX Zip Code 77433
Lender/Client	Certainty Home Loans, LLC			

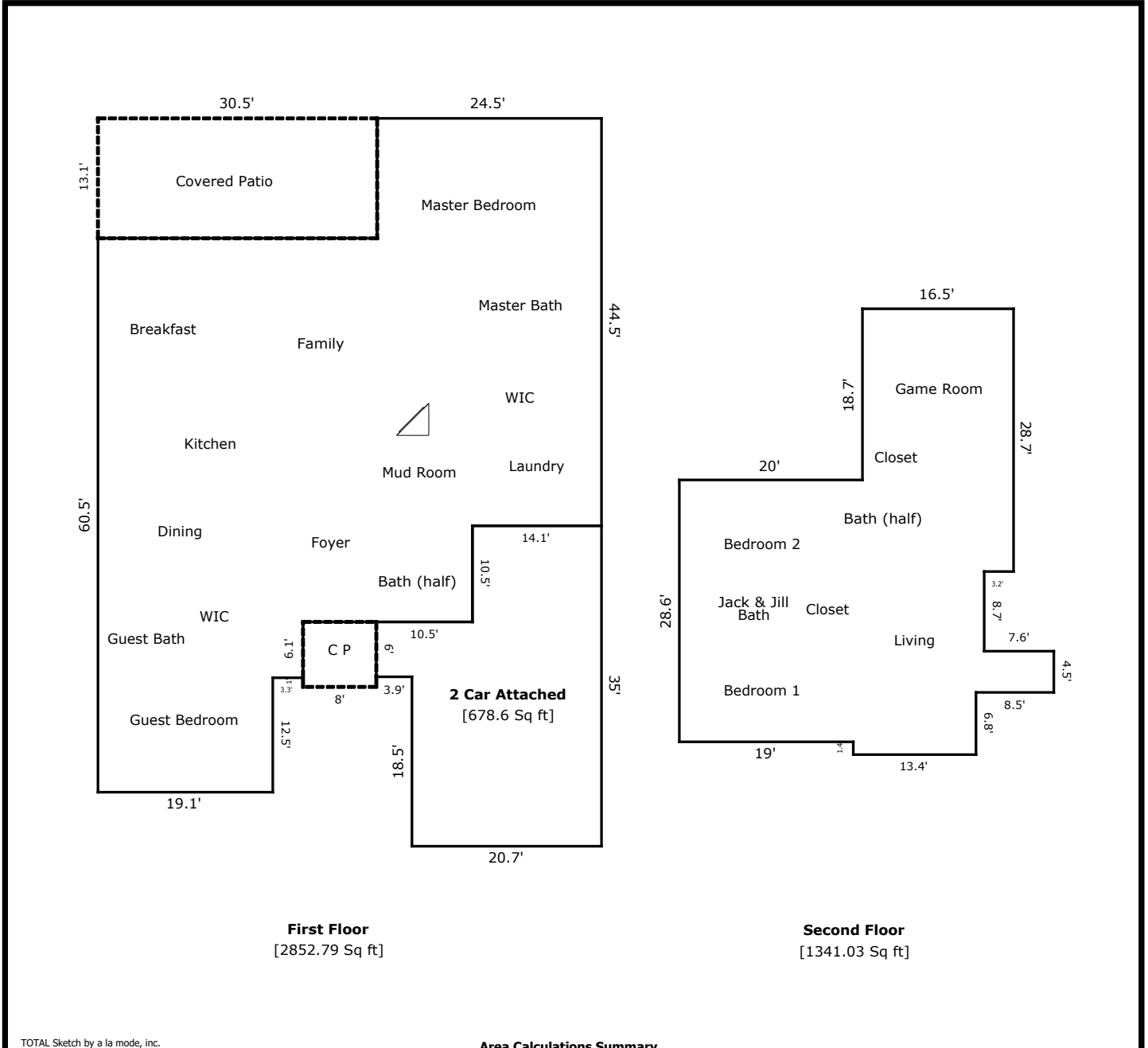

First Floor
[2852.79 Sq ft]

Second Floor
[1341.03 Sq ft]

TOTAL Sketch by a la mode, inc.

Area Calculations Summary

Living Area		Calculation Details
First Floor	2852.79 Sq ft	$19.1 \times 12.5 = 238.75$ $24.5 \times 13.1 = 320.95$ $55 \times 31.4 = 1727$ $16.6 \times 22.4 = 371.84$ $10.5 \times 18.5 = 194.25$
Second Floor	1341.03 Sq ft	$16.5 \times 18.7 = 308.55$ $28.6 \times 19 = 543.4$ $4.5 \times 7.6 = 34.2$ $17.5 \times 10 = 175$ $14.3 \times 13.2 = 188.76$ $13.4 \times 6.8 = 91.12$
Total Living Area (Rounded):	4194 Sq ft	
Non-living Area		
Concrete Patio	56.8 Sq ft	$7.1 \times 8 = 56.8$
Concrete Patio	399.55 Sq ft	$13.1 \times 30.5 = 399.55$
2 Car Attached	678.6 Sq ft	$20.7 \times 18.5 = 382.95$ $16.5 \times 14.1 = 232.65$ $6 \times 10.5 = 63$