

ADDRESS: 11306 CYPRESS CREEK LAKES DRIVE
 LOT: 11 BLOCK: 2 OF: CYPRESS CREEK LAKES SEC. 2
 RECORDED IN FILM CODE NO.: 552010
 MAP RECORDS, HARRIS COUNTY, TX
 BORROWER: TIMOTHY W. HUDSON AND LINDA K. HUDSON
 TITLE COMPANY CHICAGO TITLE/EXECUTIVE TITLE CO., LTD.
 SURVEYED FOR: PERRY HOMES, L.P.
 F.I.R.M. MAP NO. 48201C PANEL # 0405J ZONE "X" X" (REVISED 11-6-96)
 DATE: 5-3-06 SCALE: 1" = 30'
 JOB NO. Y10924-06
 SURVEYOR REGISTRATION

BOUNDARY SURVEY OF
 I, the undersigned registered professional land surveyor, do hereby state that the plat shown hereon represents a boundary survey made on the ground under my direction and supervision on the tract or parcel of land, according to the map or plat thereof, indicated below.
 drawn by: J CHAVEZ
 05.17.06

LEGEND

- ASPHALT
- COVERED
- CONCRETE
- CALL
- IRON FENCE
- WOOD FENCE
- CHAIN LINK FENCE
- CONTROLLING MONUMENT
- REVISION

ABSTRACT INFORMATION PROVIDED HEREON IS BELIEVED TO BE SUFFICIENT MAP OR PLAT AND TITLE INFORMATION PROVIDED BY CHICAGO TITLE CO./EXECUTIVE TITLE CO., LTD., G.F. NO. 002680136, DATED 03-01-06.

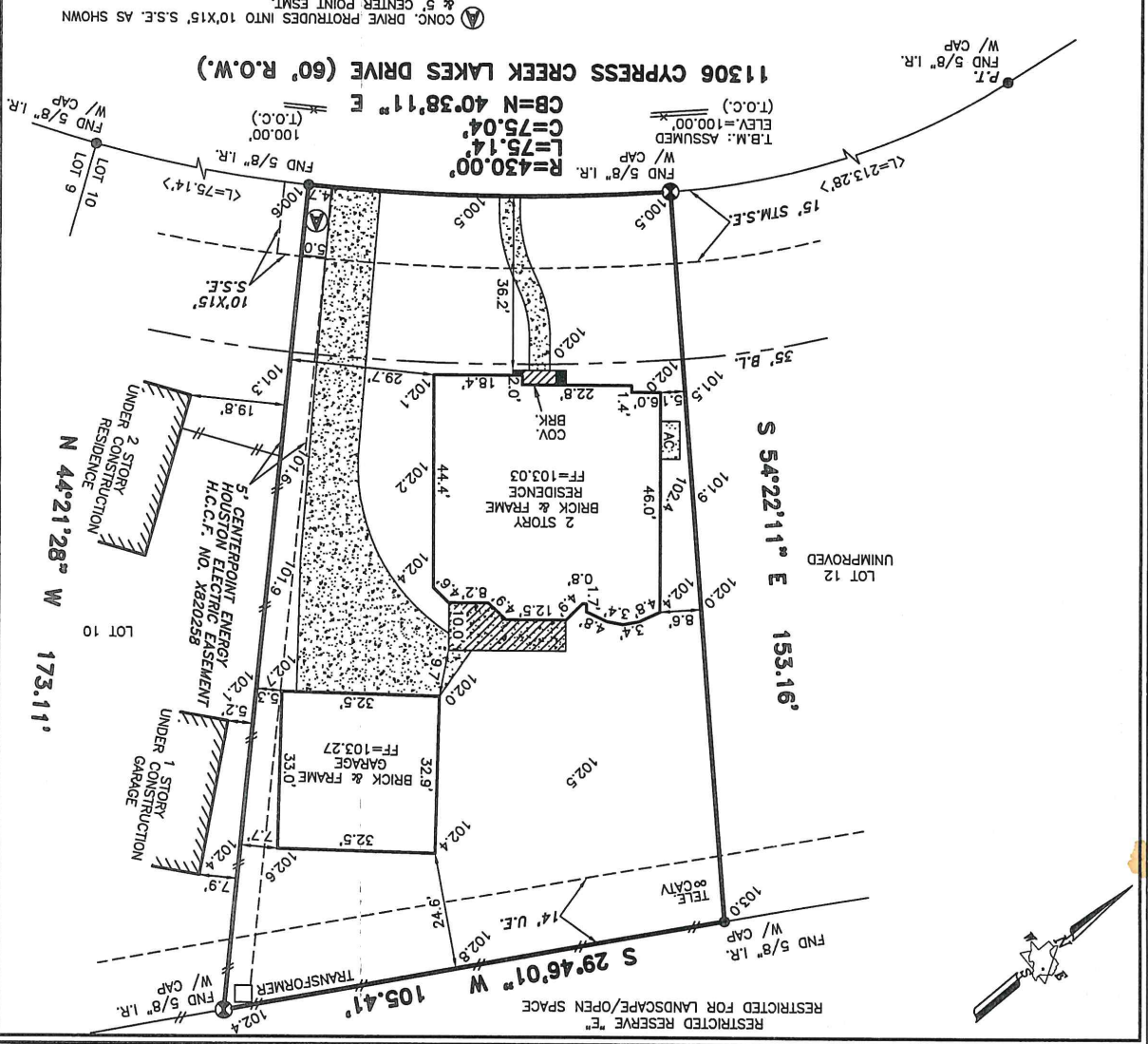

RESTRICTED RESERVE "E"
 RESTRICTED FOR LANDSCAPE/OPEN SPACE
 TRANSFORMER W/CAP
 14' U.E.
 TELE CO CATV
 103.0
 FND 5/8" I.R. W/CAP
 S 29°46'01" W 105.41'
 102.4
 102.5
 102.0
 102.1
 102.2
 102.3
 102.4
 102.5
 102.6
 102.7
 102.8
 102.9
 103.0
 103.1
 103.2
 103.3
 103.4
 103.5
 103.6
 103.7
 103.8
 103.9
 104.0
 104.1
 104.2
 104.3
 104.4
 104.5
 104.6
 104.7
 104.8
 104.9
 105.0
 105.1
 105.2
 105.3
 105.4
 105.5
 105.6
 105.7
 105.8
 105.9
 106.0
 106.1
 106.2
 106.3
 106.4
 106.5
 106.6
 106.7
 106.8
 106.9
 107.0
 107.1
 107.2
 107.3
 107.4
 107.5
 107.6
 107.7
 107.8
 107.9
 108.0
 108.1
 108.2
 108.3
 108.4
 108.5
 108.6
 108.7
 108.8
 108.9
 109.0
 109.1
 109.2
 109.3
 109.4
 109.5
 109.6
 109.7
 109.8
 109.9
 110.0
 110.1
 110.2
 110.3
 110.4
 110.5
 110.6
 110.7
 110.8
 110.9
 111.0
 111.1
 111.2
 111.3
 111.4
 111.5
 111.6
 111.7
 111.8
 111.9
 112.0
 112.1
 112.2
 112.3
 112.4
 112.5
 112.6
 112.7
 112.8
 112.9
 113.0
 113.1
 113.2
 113.3
 113.4
 113.5
 113.6
 113.7
 113.8
 113.9
 114.0
 114.1
 114.2
 114.3
 114.4
 114.5
 114.6
 114.7
 114.8
 114.9
 115.0
 115.1
 115.2
 115.3
 115.4
 115.5
 115.6
 115.7
 115.8
 115.9
 116.0
 116.1
 116.2
 116.3
 116.4
 116.5
 116.6
 116.7
 116.8
 116.9
 117.0
 117.1
 117.2
 117.3
 117.4
 117.5
 117.6
 117.7
 117.8
 117.9
 118.0
 118.1
 118.2
 118.3
 118.4
 118.5
 118.6
 118.7
 118.8
 118.9
 119.0
 119.1
 119.2
 119.3
 119.4
 119.5
 119.6
 119.7
 119.8
 119.9
 120.0
 120.1
 120.2
 120.3
 120.4
 120.5
 120.6
 120.7
 120.8
 120.9
 121.0
 121.1
 121.2
 121.3
 121.4
 121.5
 121.6
 121.7
 121.8
 121.9
 122.0
 122.1
 122.2
 122.3
 122.4
 122.5
 122.6
 122.7
 122.8
 122.9
 123.0
 123.1
 123.2
 123.3
 123.4
 123.5
 123.6
 123.7
 123.8
 123.9
 124.0
 124.1
 124.2
 124.3
 124.4
 124.5
 124.6
 124.7
 124.8
 124.9
 125.0
 125.1
 125.2
 125.3
 125.4
 125.5
 125.6
 125.7
 125.8
 125.9
 126.0
 126.1
 126.2
 126.3
 126.4
 126.5
 126.6
 126.7
 126.8
 126.9
 127.0
 127.1
 127.2
 127.3
 127.4
 127.5
 127.6
 127.7
 127.8
 127.9
 128.0
 128.1
 128.2
 128.3
 128.4
 128.5
 128.6
 128.7
 128.8
 128.9
 129.0
 129.1
 129.2
 129.3
 129.4
 129.5
 129.6
 129.7
 129.8
 129.9
 130.0
 130.1
 130.2
 130.3
 130.4
 130.5
 130.6
 130.7
 130.8
 130.9
 131.0
 131.1
 131.2
 131.3
 131.4
 131.5
 131.6
 131.7
 131.8
 131.9
 132.0
 132.1
 132.2
 132.3
 132.4
 132.5
 132.6
 132.7
 132.8
 132.9
 133.0
 133.1
 133.2
 133.3
 133.4
 133.5
 133.6
 133.7
 133.8
 133.9
 134.0
 134.1
 134.2
 134.3
 134.4
 134.5
 134.6
 134.7
 134.8
 134.9
 135.0
 135.1
 135.2
 135.3
 135.4
 135.5
 135.6
 135.7
 135.8
 135.9
 136.0
 136.1
 136.2
 136.3
 136.4
 136.5
 136.6
 136.7
 136.8
 136.9
 137.0
 137.1
 137.2
 137.3
 137.4
 137.5
 137.6
 137.7
 137.8
 137.9
 138.0
 138.1
 138.2
 138.3
 138.4
 138.5
 138.6
 138.7
 138.8
 138.9
 139.0
 139.1
 139.2
 139.3
 139.4
 139.5
 139.6
 139.7
 139.8
 139.9
 140.0
 140.1
 140.2
 140.3
 140.4
 140.5
 140.6
 140.7
 140.8
 140.9
 141.0
 141.1
 141.2
 141.3
 141.4
 141.5
 141.6
 141.7
 141.8
 141.9
 142.0
 142.1
 142.2
 142.3
 142.4
 142.5
 142.6
 142.7
 142.8
 142.9
 143.0
 143.1
 143.2
 143.3
 143.4
 143.5
 143.6
 143.7
 143.8
 143.9
 144.0
 144.1
 144.2
 144.3
 144.4
 144.5
 144.6
 144.7
 144.8
 144.9
 145.0
 145.1
 145.2
 145.3
 145.4
 145.5
 145.6
 145.7
 145.8
 145.9
 146.0
 146.1
 146.2
 146.3
 146.4
 146.5
 146.6
 146.7
 146.8
 146.9
 147.0
 147.1
 147.2
 147.3
 147.4
 147.5
 147.6
 147.7
 147.8
 147.9
 148.0
 148.1
 148.2
 148.3
 148.4
 148.5
 148.6
 148.7
 148.8
 148.9
 149.0
 149.1
 149.2
 149.3
 149.4
 149.5
 149.6
 149.7
 149.8
 149.9
 150.0
 150.1
 150.2
 150.3
 150.4
 150.5
 150.6
 150.7
 150.8
 150.9
 151.0
 151.1
 151.2
 151.3
 151.4
 151.5
 151.6
 151.7
 151.8
 151.9
 152.0
 152.1
 152.2
 152.3
 152.4
 152.5
 152.6
 152.7
 152.8
 152.9
 153.0
 153.1
 153.2
 153.3
 153.4
 153.5
 153.6
 153.7
 153.8
 153.9
 154.0
 154.1
 154.2
 154.3
 154.4
 154.5
 154.6
 154.7
 154.8
 154.9
 155.0
 155.1
 155.2
 155.3
 155.4
 155.5
 155.6
 155.7
 155.8
 155.9
 156.0
 156.1
 156.2
 156.3
 156.4
 156.5
 156.6
 156.7
 156.8
 156.9
 157.0
 157.1
 157.2
 157.3
 157.4
 157.5
 157.6
 157.7
 157.8
 157.9
 158.0
 158.1
 158.2
 158.3
 158.4
 158.5
 158.6
 158.7
 158.8
 158.9
 159.0
 159.1
 159.2
 159.3
 159.4
 159.5
 159.6
 159.7
 159.8
 159.9
 160.0
 160.1
 160.2
 160.3
 160.4
 160.5
 160.6
 160.7
 160.8
 160.9
 161.0
 161.1
 161.2
 161.3
 161.4
 161.5
 161.6
 161.7
 161.8
 161.9
 162.0
 162.1
 162.2
 162.3
 162.4
 162.5
 162.6
 162.7
 162.8
 162.9
 163.0
 163.1
 163.2
 163.3
 163.4
 163.5
 163.6
 163.7
 163.8
 163.9
 164.0
 164.1
 164.2
 164.3
 164.4
 164.5
 164.6
 164.7
 164.8
 164.9
 165.0
 165.1
 165.2
 165.3
 165.4
 165.5
 165.6
 165.7
 165.8
 165.9
 166.0
 166.1
 166.2
 166.3
 166.4
 166.5
 166.6
 166.7
 166.8
 166.9
 167.0
 167.1
 167.2
 167.3
 167.4
 167.5
 167.6
 167.7
 167.8
 167.9
 168.0
 168.1
 168.2
 168.3
 168.4
 168.5
 168.6
 168.7
 168.8
 168.9
 169.0
 169.1
 169.2
 169.3
 169.4
 169.5
 169.6
 169.7
 169.8
 169.9
 170.0
 170.1
 170.2
 170.3
 170.4
 170.5
 170.6
 170.7
 170.8
 170.9
 171.0
 171.1
 171.2
 171.3
 171.4
 171.5
 171.6
 171.7
 171.8
 171.9
 172.0
 172.1
 172.2
 172.3
 172.4
 172.5
 172.6
 172.7
 172.8
 172.9
 173.0
 173.1
 173.2
 173.3
 173.4
 173.5
 173.6
 173.7
 173.8
 173.9
 174.0
 174.1
 174.2
 174.3
 174.4
 174.5
 174.6
 174.7
 174.8
 174.9
 175.0
 175.1
 175.2
 175.3
 175.4
 175.5
 175.6
 175.7
 175.8
 175.9
 176.0
 176.1
 176.2
 176.3
 176.4
 176.5
 176.6
 176.7
 176.8
 176.9
 177.0
 177.1
 177.2
 177.3
 177.4
 177.5
 177.6
 177.7
 177.8
 177.9
 178.0
 178.1
 178.2
 178.3
 178.4
 178.5
 178.6
 178.7
 178.8
 178.9
 179.0
 179.1
 179.2
 179.3
 179.4
 179.5
 179.6
 179.7
 179.8
 179.9
 180.0
 180.1
 180.2
 180.3
 180.4
 180.5
 180.6
 180.7
 180.8
 180.9
 181.0
 181.1
 181.2
 181.3
 181.4
 181.5
 181.6
 181.7
 181.8
 181.9
 182.0
 182.1
 182.2
 182.3
 182.4
 182.5
 182.6
 182.7
 182.8
 182.9
 183.0
 183.1
 183.2
 183.3
 183.4
 183.5
 183.6
 183.7
 183.8
 183.9
 184.0
 184.1
 184.2
 184.3
 184.4
 184.5
 184.6
 184.7
 184.8
 184.9
 185.0
 185.1
 185.2
 185.3
 185.4
 185.5
 185.6
 185.7
 185.8
 185.9
 186.0
 186.1
 186.2
 186.3
 186.4
 186.5
 186.6
 186.7
 186.8
 186.9
 187.0
 187.1
 187.2
 187.3
 187.4
 187.5
 187.6
 187.7
 187.8
 187.9
 188.0
 188.1
 188.2
 188.3
 188.4
 188.5
 188.6
 188.7
 188.8
 188.9
 189.0
 189.1
 189.2
 189.3
 189.4
 189.5
 189.6
 189.7
 189.8
 189.9
 190.0
 190.1
 190.2
 190.3
 190.4
 190.5
 190.6
 190.7
 190.8
 190.9
 191.0
 191.1
 191.2
 191.3
 191.4
 191.5
 191.6
 191.7
 191.8
 191.9
 192.0
 192.1
 192.2
 192.3
 192.4
 192.5
 192.6
 192.7
 192.8
 192.9
 193.0
 193.1
 193.2
 193.3
 193.4
 193.5
 193.6
 193.7
 193.8
 193.9
 194.0
 194.1
 194.2
 194.3
 194.4
 194.5
 194.6
 194.7
 194.8
 194.9
 195.0
 195.1
 195.2
 195.3
 195.4
 195.5
 195.6
 195.7
 195.8
 195.9
 196.0
 196.1
 196.2
 196.3
 196.4
 196.5
 196.6
 196.7
 196.8
 196.9
 197.0
 197.1
 197.2
 197.3
 197.4
 197.5
 197.6
 197.7
 197.8
 197.9
 198.0
 198.1
 198.2
 198.3
 198.4
 198.5
 198.6
 198.7
 198.8
 198.9
 199.0
 199.1
 199.2
 199.3
 199.4
 199.5
 199.6
 199.7
 199.8
 199.9
 200.0

ALL ROD CAPS ARE "SURCON, INC.", UNLESS OTHERWISE NOTED.
 CITY OF HOUSTON CHAPTER 42 CODE OF ORDINANCES **NEEDED RESTRICTIONS PER H.C.C. FILE NO. X095655
 A DRAINAGE EASEMENT IS ON EACH SIDE OF THE CENTERLINE OF ALL NATURAL DRAINAGE COURSES IN THE ADDITION AS SHOWN ON RECORDED PLAT OF SAID ADDITION.
 PROPERTY SUBJECT TO RESTRICTIVE COVENANTS AND EASEMENTS AS DEFINED PER FILM CODE NO. 552010, M.R.H.C.T.X., H.C.C. FILE NOS. X095655, X298132, X820259, X884918, X975152, Y319528 AND CITY OF HOUSTON ORDINANCE 89-1878 PER H.C.C.F. #M-337573 AND AMENDED BY CITY OF HOUSTON ORDINANCE 1999-262.
 BEARINGS REFERENCED TO: PLAT NORTH.
 THIS SURVEY IS VALID WITH ORIGINAL SIGNATURE AND EMBOSSED SEAL. THIS SURVEY IS VALID FOR THIS TRANSACTION ONLY. © 2006, TRI-TECH SURVEYING CO., L.P.
 ABSTRACT INFORMATION PROVIDED HEREON IS BELIEVED TO BE SUFFICIENT MAP OR PLAT AND TITLE INFORMATION PROVIDED BY CHICAGO TITLE CO./EXECUTIVE TITLE CO., LTD., G.F. NO. 002680136, DATED 03-01-06.