

## Building Sketch

Borrower/Client			
Property Address 14019 Ashland Landing Dr			
City	County	State	Zip Code
Lender			

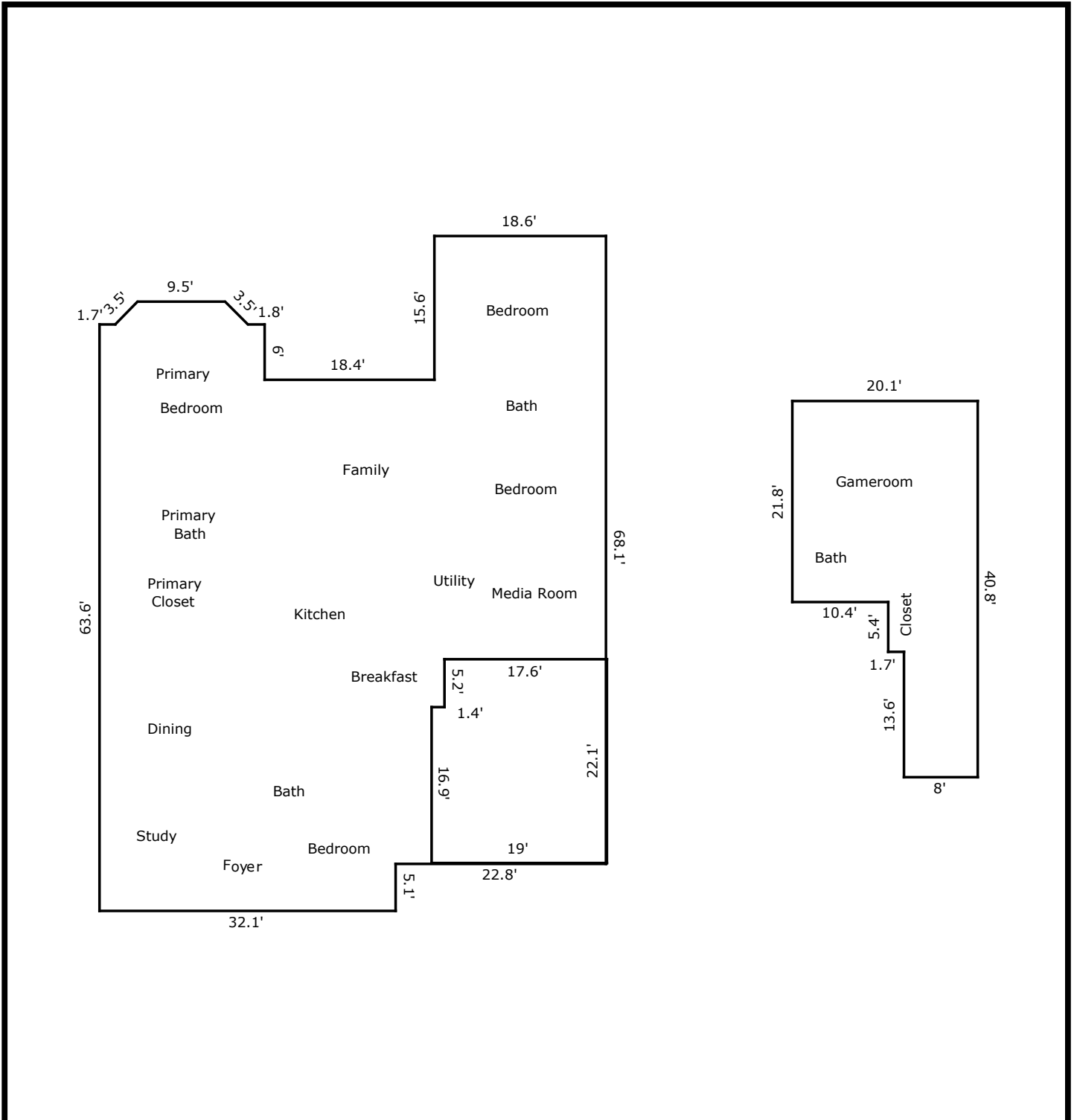

TOTAL Sketch by a la mode, inc.

### Area Calculations Summary

Living Area	Area	Calculation Details
First Floor	3473.1 Sq ft	$0.5 \times 2.4 \times 2.5 = 3$ $0.5 \times 2.5 \times 2.5 = 3.1$ $9.5 \times 2.5 = 23.5$ $18.6 \times 15.6 = 290.2$ $52.5 \times 22.8 = 1197$ $32.1 \times 57.6 = 1849$ $6 \times 17.9 = 107.4$
Second Floor	599.4 Sq ft	$20.1 \times 21.8 = 438.2$ $8 \times 13.6 = 108.8$ $5.4 \times 9.7 = 52.4$
2 Car Built-in	-412.6 Sq ft	$16.9 \times 1.4 = 23.7$ $22.1 \times 17.6 = 389$
<b>Total Living Area (Rounded):</b>	<b>3660 Sq ft</b>	