

You may wish to laminate the pocket identification card to preserve it.

EVANS TRAMMELL
11008 FRANCOISE BLVD
HOUSTON, TX 77042

The person named on the reverse is licensed by the Texas Appraiser Licensing and Certification Board.

Inquiry as to the status of this license may be made to:

Texas Appraiser Licensing and Certification Board
P.O. Box 12188
Austin, Tx 78711-2188
www.talcb.texas.gov
(512) 936-3001
Fax: (512) 936-3899

Texas Appraiser Licensing and Certification Board
P.O. Box 12188 Austin, Texas 78711-2188

Certified Residential Real Estate Appraiser

Number#: **TX 1360743 R**

Issued: **08/16/2018**

Expires: **08/31/2020**

Appraiser: **EVANS TRAMMELL**

Having provided satisfactory evidence of the qualifications required by the Texas Appraiser Licensing and Certification Act, Texas Occupations Code, Chapter 1103, is authorized to use this title, Certified Residential Real Estate Appraiser.

Douglas E. Oldmixon
Commissioner

Texas Appraiser Licensing and Certification Board

P.O. Box 12188 Austin, Texas 78711-2188

Certified Residential Real Estate Appraiser

Number: **TX 1360743 R**

Issued: **08/16/2018**

Expires: **08/31/2020**

Appraiser: **EVANS TRAMMELL**

Having provided satisfactory evidence of the qualifications required by the Texas Appraiser Licensing and Certification Act, Texas Occupations Code, Chapter 1103, is authorized to use this title, Certified Residential Real Estate Appraiser.

Douglas E. Oldmixon
Commissioner

Building Sketch (Page - 1)

Borrower/Client	C K Semlani				
Property Address	1918 Mystic Arbor Ln				
City	Houston	County	Harris	State	TX
				Zip Code	77077
Lender					

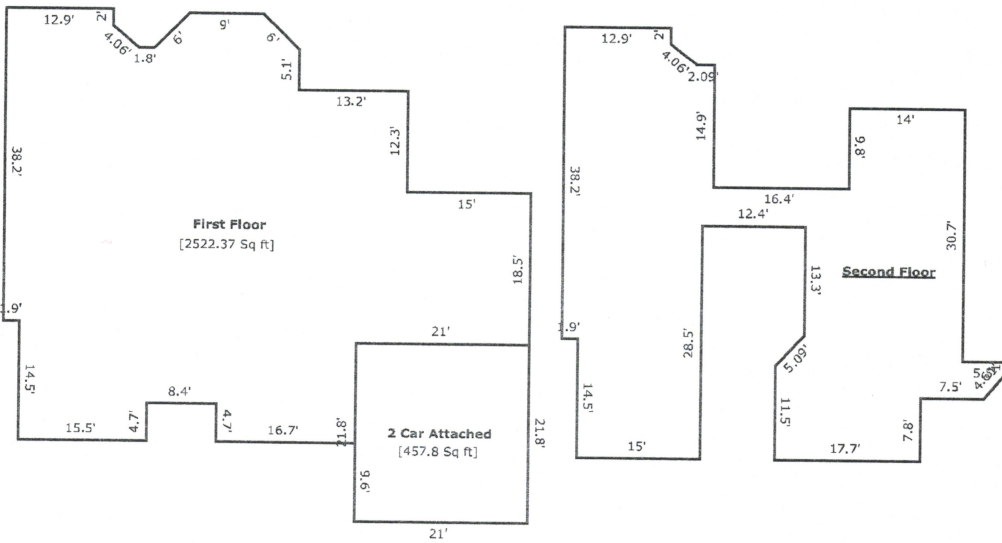

Building Sketch (Page - 2)

Borrower/Client	C K Semlani				
Property Address	1918 Mystic Arbor Ln				
City	Houston	County	Harris	State	TX
Lender				Zip Code	77077

TOTAL Sketch by a la mode, inc.

Area Calculations Summary

Living Area		Calculation Details
First Floor	2522.37 Sq ft	
		0.5 × 4.24 × 4.24 = 9
		0.5 × 4.24 × 4.24 = 9
		9 × 4.24 = 38.18
		18.5 × 15 = 277.5
		16.7 × 4.7 = 78.49
		15.5 × 4.7 = 72.85
		30.8 × 6 = 184.8
		40.6 × 9.8 = 397.88
		42.5 × 28.5 = 1211.25
		9.7 × 12.9 = 125.13
		5.1 × 19.29 = 98.36
		3.11 × 5.1 = 15.88
		0.5 × 3.11 × 2.6 = 4.05
Second Floor	1726.75 Sq ft	
		17.7 × 7.8 = 138.06
		15 × 14.5 = 217.5
		38.2 × 12.9 = 492.78
		1 × 3 = 3
		0.5 × 3.5 × 3 = 5.25
		4.5 × 2.5 = 11.25
		35.2 × 14 = 492.8
		8.7 × 3.7 = 32.19
		21.7 × 5.2 = 112.84
		0.5 × 3.7 × 3.5 = 6.48
		4.7 × 11.2 = 52.64
		4 × 14 = 56
		5.2 × 19.6 = 101.92
		0.5 × 3.11 × 2.6 = 4.05
Total Living Area (Rounded):		4249 Sq ft
Non-living Area		
2 Car Attached	457.8 Sq ft	21 × 21.8 = 457.8