

SANDER ESTATES  
 VOL. 1, PG. 35 P.R.A.C.T.  
 JOHN NICHOLS LEAGUE  
 A-73  
 AUSTIN COUNTY, TEXAS

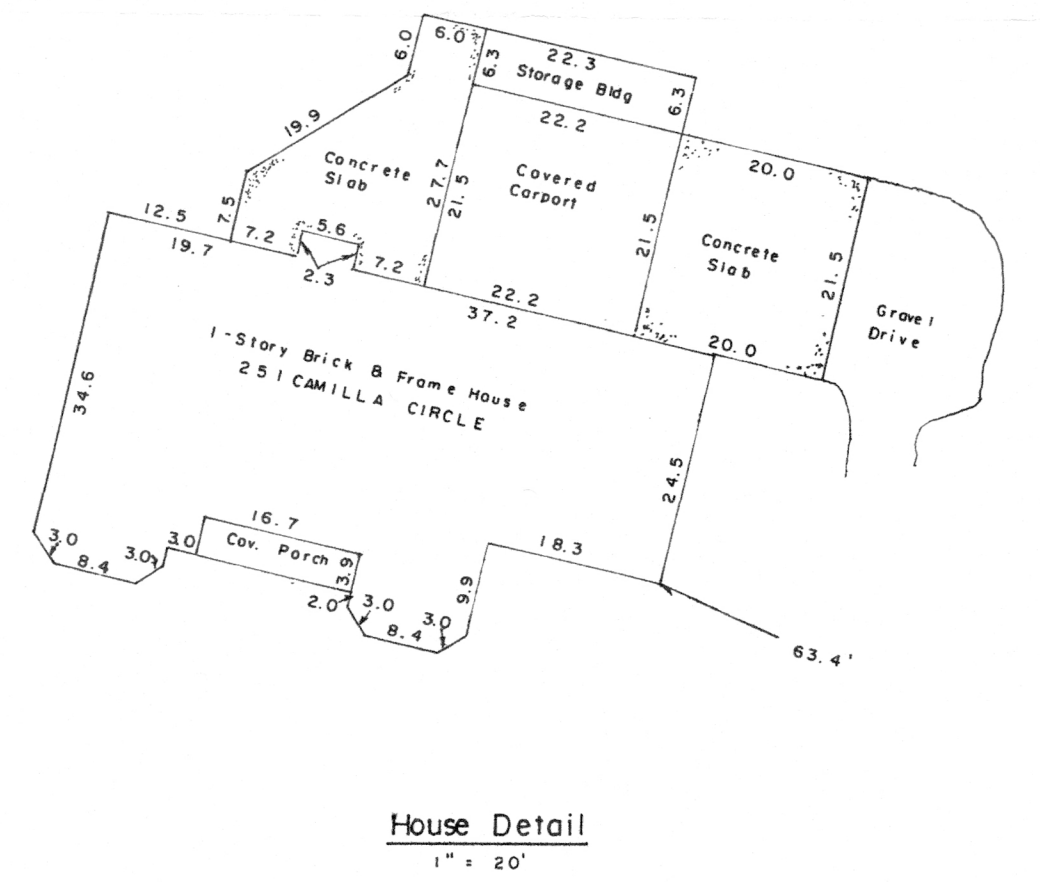

I, Glen S. Alexander, Registered Professional Land Surveyor, do hereby certify that the plat and/or the description shown hereon accurately represents the results of an on the ground survey made under my direction and supervision on August 16, 1994, and all corners are shown hereon. There are no encroachments, conflicts, protrusions, easements and/or right of ways apparent on the ground and/or of record, based upon this on the ground survey and title information abstracted and furnished by Austin County Title & Abstract Company, except as shown and/or noted hereon.

This survey was performed in connection with the transaction described in G. F. No. B940718 of Austin County Title & Abstract Company.

USE OF THIS SURVEY FOR ANY OTHER PURPOSE OR BY OTHER PARTIES SHALL BE AT THEIR OWN RISK AND THE UNDERSIGNED SURVEYOR IS NOT RESPONSIBLE FOR ANY LOSS RESULTING THEREFROM.

Glen S. Alexander  
 Glen S. Alexander - Registered Professional Land Surveyor, #4194

NOTES: The tract of land shown hereon does not lie within the Flood Hazard Zone according to the F.I.R.M., Flood Insurance Rate Map# 48015C 0150 C, effective date January 17, 1990.

	<b>JERRY L. &amp; KAREN P. WALTERS</b>	
	<b>ALEXANDER SURVEYING</b> 36 S. Front Street • P.O. Box 386 Bellville, Texas 77418 409/865-9145	
	Glen S. Alexander R.P.S. No. 4194 Date April 11, 1994 Update Aug. 16, 1994	County AUSTIN Survey JOHN NICHOLS, A-73 City Addition SANDER ESTATES