

TEXAS OFFICIAL WOOD DESTROYING INSECT REPORT

72 Palos Verde
Inspected Address

Conroe
City

77304
Zip Code

SCOPE OF INSPECTION

- A. This inspection covers only the multi-family structure, primary dwelling or place of business. Sheds, detached garages, lean-tos, fences, guest houses or any other structure will not be included in this inspection report unless specifically noted in Section 5 of this report.
B. This inspection is limited to those parts of the structure(s) that are visible and accessible at the time of the inspection.
C. Due to the characteristics and behavior of various wood destroying insects, it may not always be possible to determine the presence of infestation without defacing or removing parts of the structure being inspected.
D. If visible evidence of active or previous infestation of listed wood destroying insects is reported, it should be assumed that some degree of damage is present.
E. If visible evidence is reported, it does not imply that damage should be repaired or replaced.
F. THIS IS NOT A STRUCTURAL DAMAGE REPORT OR A WARRANTY AS TO THE ABSENCE OF WOOD DESTROYING INSECTS.
G. If termite treatment (including pesticides, baits or other methods) has been recommended, the treating company must provide a diagram of the structure(s) inspected and proposed for treatment, label of pesticides to be used and complete details of warranty (if any).
H. There are a variety of termite control options offered by pest control companies.
I. There are some specific guidelines as to when it is appropriate for corrective treatment to be recommended.
J. If treatment is recommended based solely on the presence of conducive conditions, a preventive treatment or correction of conducive conditions may be recommended.

1A. AGUILAR TERMITE AND PEST Name of Inspection Company
1B. 13284 / TDA 0566143 SPCS Business License Number

1C. 218 PLAZA VERDE DR. #N 100 Address of Inspection Company
Houston City TX State 77038 Zip (713) 653-4987 Telephone No.

1D. Name of Inspector (Please Print)
1E. [X] Certified Applicator (check one)
[ ] Technician

2. Case Number (VA/FHA/Other)
3. 2/22/2018 Inspection Date

4A. Otto & Lauren Celis Name of Person Purchasing Inspection
[ ] Agent [X] Buyer [ ] Management Co. [ ] Oth

4B. Owner/Seller

4C. REPORT FORWARDED TO: [ ] Title Company or Mortgagee [ ] Purchaser of Service [ ] Seller [ ] Agent [ ] Buyer
(Under the Structural Pest Control regulations only the purchaser of the service is required to receive a copy)

The structure(s) listed below were inspected in accordance with the official inspection procedures adopted by the Texas Structural Pest Control Service of the Texas Department of Agriculture. This report is made subject to the conditions listed under the Scope of Inspection. A diagram must be attached including all structures inspected.

5. House with attached garage
List structure(s) inspected that may include residence, detached garages and other structures on the property. (Refer to Part A, Scope of Inspection)

6A. Were any areas of the property obstructed or inaccessible? [X] Yes [ ] No
(Refer to Part B & C, Scope of Inspection) If "Yes" specify in 6B.

- 6B. The obstructed or inaccessible areas include but are not limited to the following:
[ ] Attic [X] Insulated area of attic [X] Plumbing Areas [ ] Planter box abutting structure
[ ] Deck [ ] Sub Floors [X] Slab Joints [ ] Craw Space
[ ] Soil Grade Too High [ ] Heavy Foliage [X] Eaves [ ] Weepholes

[X] Other Specify: Indoor plumbing inaccessible by design

7A. Conditions conducive to wood destroying insect infestation: [ ] Yes [X] No
(Refer to Part J, Scope of Inspection) If "Yes" specify in 7B.

- 7B. Conducive Conditions include but are not limited to:
[ ] Debris under or around structure (K) [ ] Footing too low or soil line too high (L) [ ] Wooden Fence in Contact with the Structure (R)
[ ] Planter box abutting structure (O) [ ] Wood Pile in Contact with Structure (Q) [ ] Excessive Moisture (J)
[ ] Insufficient ventilation (T) [ ] Formboards left in place (I) [ ] Heavy Foliage (N)
[ ] Wood to Ground Contact (G) [ ] Wood Rot (M)
[ ] Other

Table with 4 columns: Inspection Reveals Visible Evidence in or on the structure, Active Infestation, Previous Infestation, Previous Treatment. Rows include Subterranean Termites, Drywood Termites, Formosan Termites, Carpenter Ants, Other Wood Destroying Insects.

8F. Explanation of signs of previous treatment (including pesticides, baits, existing treatment stickers or other methods) identified: none visible

8G. Visible evidence of: non-active has been observed in the following areas: N/A

If there is visible evidence of active or previous infestation, it must be noted. The type of insect(s) must be listed in the first blank and all identified infested areas of the property inspected must be noted in the second blank. (Refer to Part D, E & F, Scope of Inspection)

Licensed and Regulated by the Texas Department of Agriculture, Structural Pest Control Service,
PO Box 1927 Austin, Texas 78767-1927
512-305-8250

# Texas Official Wood Destroying Insect Report

The conditions conducive to insect infestation reported in 7A & 7B:

9. Will be or has been mechanically corrected by the inspecting company:  Yes  No

If "Yes" specify corrections: \_\_\_\_\_

9A. Corrective treatment recommended for active infestation or evidence of previous infestation with no prior treatment as identified in Section 8. (Refer to Part G, H, and I. Scope of Inspection)  Yes  No

9B. A preventative treatment and/or correction of conducive conditions as identified in 7A & 7B is recommended as follows:  Yes  No

Specify reason: \_\_\_\_\_  
Refer to Scope of Inspection Part J

10A. This company has treated or is treating the structure for the following wood destroying insects: \_\_\_\_\_ **N/A**

If treating for subterranean termites, the treatment was:  Partial  Spot  Bait  Other  
If treating for drywood termites or related insects, the treatment was:  Full  Limited

10B. Date: \_\_\_\_\_ **N/A**  
Date of Treatment by Inspecting Company Common Name of Insect Name of Pesticide, Bait or Other Method

This company has a contract or warranty in effect for control of the following wood destroying insects: \_\_\_\_\_  
 Yes  No List insects: \_\_\_\_\_

**If "Yes", copy(ies) of warranty and treatment diagram must be attached.**

### Diagram of Structure(s) Inspected

The inspector must draw a diagram including approximate perimeter measurements and indicate active or previous infestation and type of insect by using the following codes:

E-Evidence of Infestation, A-Active; P-Previous; D-Drywood Termites; S-Subterranean Termites; F-Formosan Termites; C-Conducive Conditions; B-Wood Boring Beetles  
H-Carpenter Ants' Other(s) - Specify \_\_\_\_\_

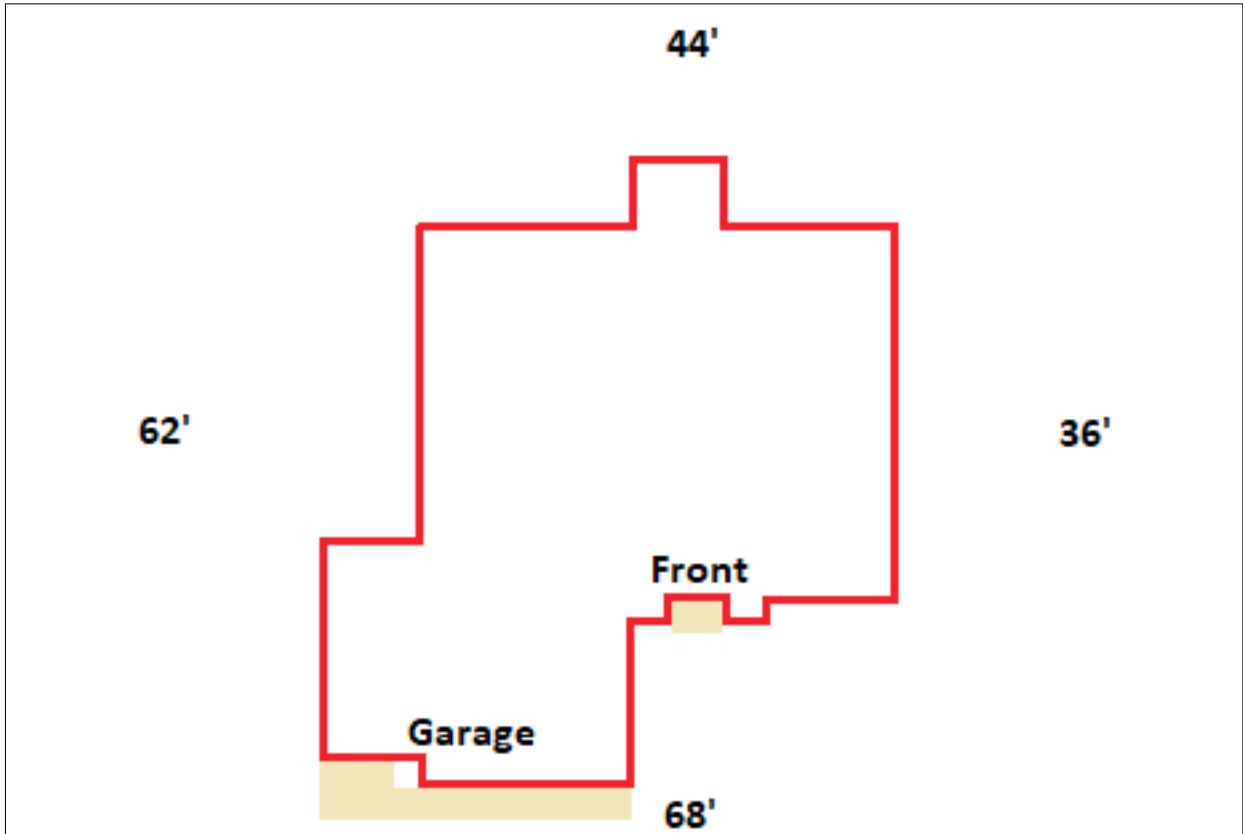

Additional Comments NO VISIBLE EVIDENCE OF ANY WOOD DESTROYING ORGANISMS AT THIS TIME.

Neither I nor the company for which I am acting have had, presently have, or contemplate having any interest in the property. I do further state that neither I nor the company for which I am acting is associated in any way with any party to this transaction.

Signatures:  
11A. Rubon Quila ca 0557502  
Inspector

Notice of Inspection Was Posted At or Near: under kitchen sink  
Date Posted: 2/22/2018

Approved:  
11B. Rubon Quila ca 0557502  
Certified Applicator and Certified Applicator License Number

#### Statement of Purchaser

I have received the original or a legible copy of this form. I have read and understand any recommendations made. I have also read and understand the "Scope of Inspection." I understand that my inspector may provide additional information as an addendum to this report. If additional information is attached, list number of pages: \_\_\_\_\_

Signature of Purchaser of Property or their Designee \_\_\_\_\_

Date \_\_\_\_\_



Front view

# 1



Attic view

# 2



Inspection sticker

# 3