

Bearings based on Monumentation of North R.O.W. line of Deaf Smith Drive

June 9, 2003

SCALE: 1" = 20'

Survey of Lot 1717 of **TWELFTH EXTENSION TO SEA ISLE**, a subdivision in Galveston County, Texas, according to the map or plat thereof recorded in Volume 8, Page 79, of the Map Records in the Office of the County Clerk of Galveston County, Texas.

I hereby certify that on the above date, the herein described property, together with improvements located thereon, was surveyed on the ground and under my direction, and that this map, together with dimensions as shown hereon, accurately represents the facts as found on the ground this date.

1/2" = 20'

June 9, 2003

SCALE: 1" = 20'

Survey of Lot 1717 of **TWELFTH EXTENSION TO SEA ISLE**, a subdivision in Galveston County, Texas, according to the map or plat thereof recorded in Volume 8, Page 79, of the Map Records in the Office of the County Clerk of Galveston County, Texas.

I hereby certify that on the above date, the herein described property, together with improvements located thereon, was surveyed on the ground and under my direction, and that this map, together with dimensions as shown hereon, accurately represents the facts as found on the ground this date.

COASTAL SURVEYING OF TEXAS

Sidney Bouse
Registered Professional
Land Surveyor 5287

Borrower: Paul Badovinac
and Darlene Badovinac
South-Land Title GF# 98109-D

This property does lie within the
100 Year Flood Plain as
established by the U.S. Department
of Housing and Urban
Development.

03-0621



"SERVING GALVESTON COUNTY OVER 50 YEARS"

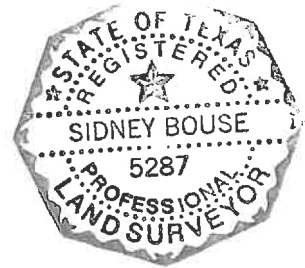

This property is subject to Zoning
Ordinances by the City of
Galveston and to any restrictions
of record.