



PROJECT: Seven Coves Section 4 Block 12 Lot 15

SQUARE FOOTAGE CALCULATION:
 TOTAL AREA: 440 SF
 GARAGE: 35 SF
 FRONT PORCH: 192 SF
 TERRACE: 192 SF
 TOTAL CONSTRUCTION: 2,288 SF

LOCATION: Seven Coves Section 4 Block 12 Lot 15

OWNER:
 MARCO RAMS | 407.483.9891
 MARCO@RAMS.YANHO.COM

WOOD & SMART DESIGN, LLC
 814 HONEA EGYPT RD. 101
 WASHINGTON, VA 22192
 www.woodandsmart.com
 832.764.6121
 info@woodandsmart.com



WOOD & SMART DESIGN, LLC
 814 HONEA EGYPT RD 101
 WASHINGTON, VA 22192
 www.woodandsmart.com
 832.764.6121

The Registered Professional Building Designer (PBD) "Irene" and Registered Professional Engineer "The" represent the above project. It is the responsibility of the building owner to ensure that the building design meets all applicable codes and regulations. The building owner is responsible for obtaining all necessary permits and approvals from the local authorities. The building owner is also responsible for ensuring that the building is constructed in accordance with the approved plans and specifications. The building owner is also responsible for ensuring that the building is maintained in accordance with the approved plans and specifications.

FIRST FLOOR PLAN

A2.0

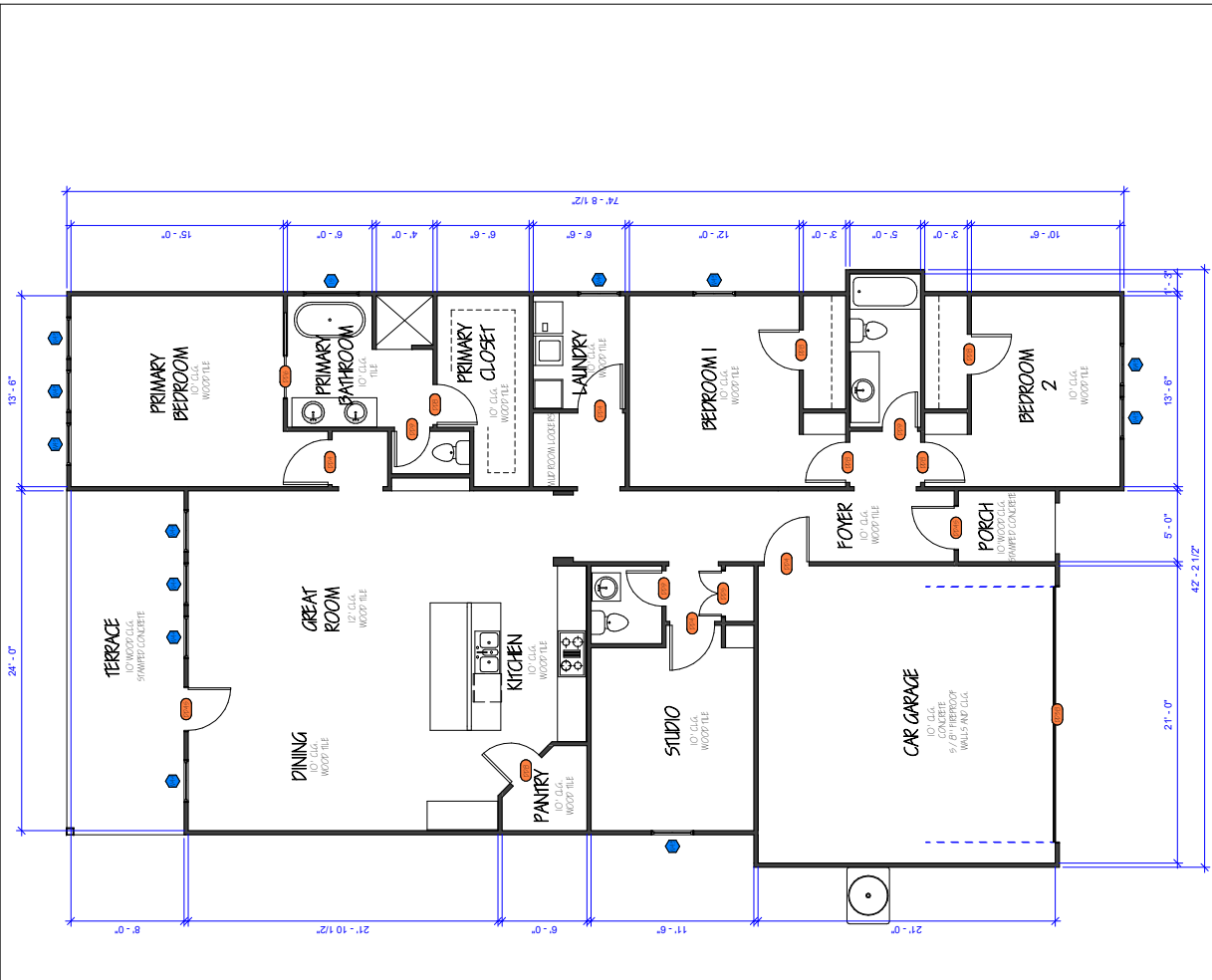

FIRST FLOOR PLAN

- GENERAL NOTES:**
- ALL DIMENSIONS ARE TO WOOD FRAME
 - TODAS LAS DIMENSIONES ESTAN AL MARCO DE MADERA
 - AS FLOOR & BALCONY FRAMING) SHALL BE PRESSURE TREATED
 - TODAS LAS PARTES DE MADERA EN CONTACTO CON CONCRETO O EXPUESTA AL CLIMA O HUMEDAD (COMO TERRAZAS Y BALCONES)
 - FRAMING LUMBER SHALL BE AS FOLLOWS UNLESS OTHERWISE NOTED:
 - EL MARCO DE MADERA DEBE SER COMO SIGUE AL MENOS QUE TENGA UNA NOTA DE OTRA MANERA:
 - CEILING JOISTS: 2x10 @ 16" O.C.
 - RAFTERS: Vigas del techo 2x8 @ 16" O.C.
 - FLOORING: 3/4" OSB
 - WALLS: Paredes 2x12 OSB
 - ROOF: Techo 7/16" OSB
 - ROOF TECH SHEILD RADIANT BARRIER
 - ROOF INSULATION: 6" POLYISO
 - ATTIC: 3/4" OSB ADVANTAGE FLOORING
 5. THE NUMBER AND SIZE OF NAILS CONNECTING WOOD MEMBERS SHALL BE IN ACCORDANCE WITH LOCAL CODES
 6. PROVIDE 5/8" THICK SHEETROCK TYPE "X" ON WALLS AND CEILING GARAGE.
 - OTHER WALLS AND CEILING SHALL BE 1/2" THICK SHEETROCK
 - PROVIDE WOOD BLOCKING AT ALL BEDROOMS AND LIVING ROOM FOR FUTURE CEILING FAN
 - PROVEA BLOQUEO DE MADERA EN TODOS LOS CUARTOS Y SALA PARA FUTURAS INSTALACIONES DE VENTILADORES DE TECTO.

Type Mark	Family and Type	Level	Height	Width
DD4	Single-Flush: 36" X 36" (Opening 36")	FIRST FLOOR PLAN	8' - 0"	3' - 2"
DD4.4	Single-Flush: 36" X 36" (Opening 36")	FIRST FLOOR PLAN	8' - 0"	3' - 2"
DD5	Door-Inner: Single-Flush: 36" X 36" (Opening 36")	FIRST FLOOR PLAN	8' - 0"	3' - 0"
DD5.1	Door-Inner: Single-Flush: 36" X 36" (Opening 36")	FIRST FLOOR PLAN	8' - 0"	3' - 0"
DD6	Door-Inner: Single-Flush: 36" X 36" (Opening 36")	FIRST FLOOR PLAN	8' - 0"	3' - 0"
DD6.1	Door-Inner: Single-Flush: 36" X 36" (Opening 36")	FIRST FLOOR PLAN	8' - 0"	3' - 0"
DD8	Single-Flush: 32" X 36" (Opening 34")	FIRST FLOOR PLAN	8' - 0"	12' - 10"
DD8.6	Single-Flush: 32" X 36" (Opening 34")	FIRST FLOOR PLAN	8' - 0"	12' - 10"
DD9	Single-Flush: 28" X 36" (Opening 30")	FIRST FLOOR PLAN	8' - 0"	12' - 6"
DD9.3	Single-Flush: 28" X 36" (Opening 30")	FIRST FLOOR PLAN	8' - 0"	12' - 6"
DD38	Door-Garage-Flush: Panel: 216" X 96" (Opening 18' 2")	FIRST FLOOR PLAN	8' - 0"	18' - 0"
DD38.1	Door-Garage-Flush: Panel: 216" X 96" (Opening 18' 2")	FIRST FLOOR PLAN	8' - 0"	18' - 0"
DD45	Door-Flush: Single-Flush: Half Flat: Glass-Wood: 36" X 66"	FIRST FLOOR PLAN	8' - 0"	3' - 0"
DD45.2	Door-Flush: Single-Flush: Half Flat: Glass-Wood: 36" X 66"	FIRST FLOOR PLAN	8' - 0"	3' - 0"

Type Mark	Family and Type	Level	Height	Width	Sill Height	Comments
15	Window: 4 x 5	FIRST FLOOR PLAN	5' - 0"	4' - 0"	4' - 0"	
W43	Window: 24 x 36 with Trim: 3 x 6 (Open Window)	FIRST FLOOR PLAN	6' - 0"	3' - 0"	2' - 6"	
W43.7	Window: 24 x 36 with Trim: 3 x 6 (Open Window)	FIRST FLOOR PLAN	6' - 0"	3' - 0"	2' - 6"	
W44	Window: 24 x 36 with Trim: 3 x 6 (Closed Window)	FIRST FLOOR PLAN	6' - 0"	3' - 0"	2' - 6"	
W44.5	Window: 24 x 36 with Trim: 3 x 6 (Closed Window)	FIRST FLOOR PLAN	6' - 0"	3' - 0"	2' - 6"	