

SER. T. CO.

GF#

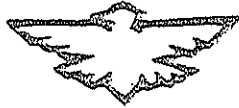

The hereby certify this to be a true and correct copy of the original instrument.

STATE HIGHWAY NO. 124

STATE HIGHWAY NO. 124

N.W. CORNER  
ALLEN R. LEGER  
10.041 AC. TR.  
VOL 2075, PG. 35 D.R.

10.041 AC. TR.

S. 89° 54' 46" W. 120' 00"

W. LINE

S. 00° 29' W. 125' 00"

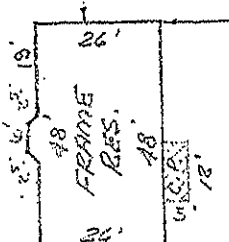

SHELL DRIVE

125' 00"

N. 00° 29' E. 700' 25"

60' PRIVATE ROAD  
(0.982 AC.)

724' 00"

S.W. CORNER  
10.041 AC. TR.

151' 00"

N. 89° 54' 46" E. 120' 00"

S. 89° 54' 46" W.  
60' 00"

NORTH  
1' 40"

(CENSUS TRACT 113  
FLOOD ZONE C-  
THIS LOT DOES NOT  
LIE WITHIN THE  
100 YEAR FLOOD ZONE  
SEE COMMUNITY NO. 980235  
PAGE NO. 0360  
SUFFIX B  
JUNE 1, 1983

SURVEYORS CERTIFICATE:

I, GUY A. STONECIPHER, JR., DO HEREBY CERTIFY THAT THIS IS AN ACCURATE PLAT OF A 0.344 ACRES TRACT OF LAND KNOWN AS HOUSE NUMBER P.O. BOX 422, HWY. 124 - HAMSHIRE, TEXAS 77022, AS SURVEYED BY ME ON THE GROUND SHOWING ALL IMPROVEMENTS AND BEING PART OF ALLEN R. LEGER 10.041 AC. TR. LOVAN HAMSHIRE SURVEY, R. 662, JEFFERSON COUNTY AS RECORDED IN VOLUME 2075 PAGE 35 OF THE DEED RECORDS OF JEFFERSON COUNTY, TEXAS.

THERE WERE NO VISIBLE ENCROACHMENTS ON THE PROPERTY AT THE TIME OF THE SURVEY AS INDICATED IN THE FOREGOING PLAT.

RONNEY C. COLEMAN  
PROPERTY OWNERS

GUY A. STONECIPHER, JR.  
REGISTERED PUBLIC SURVEYOR NO. 1770

SUBSCRIBED AND SWORN TO, BEFORE ME, A NOTARY PUBLIC, IN AND FOR JEFFERSON COUNTY, TEXAS, THIS THE 20 DAY OF NOV., 1982.

Dorothy Crocker  
NOTARY PUBLIC IN AND FOR JEFFERSON COUNTY, TEXAS.



247-32  
JOB NUMBER