

ADDRESS: 20915
LONELY STAR LANE
 (50' R.O.W.)

LEGEND

EE	= ELECTRICAL EASEMENT
UE	= UTILITY EASEMENT
AE	= AERIAL EASEMENT
DE	= DRAINAGE EASEMENT
BL	= BUILDING LINE
STM.S.E.	= STORM SEWER EASEMENT
S.S.E.	= SANITARY SEWER EASEMENT
W.L.E.	= WATER LINE EASEMENT
S.L.E.	= STREET LIGHT EASEMENT
IR	= IRON ROD
IP	= IRON PIPE
FND	= FOUND
-/-	= WOOD FENCE
-/-/-	= IRON FENCE

- NOTES:**
- 1.) SUBJECT TO RESTRICTIVE COVENANTS BY PLAT NO. 20040050 F.B.C.P.R. AND UNDER F.B.C.C.F. NO. 2004075152.
 - 2.) SUBJECT TO SCENIC EASEMENT BY F.B.C.C.F. NO. 9163398.
 - 3.) SUBJECT TO 5' CENTERPOINT ENERGY EASEMENT BY F.B.C.C.F. NO. 2004055458.
 - 4.) SUBJECT TO DRILL SITE AGREEMENT BY F.B.C.C.F. NO. 2002106799.
 - 5.) SUBJECT TO CENTERPOINT ENERGY AGREEMENT BY F.B.C.C.F. NO. 2004071670.
 - 6.) ALL BEARINGS SHOWN ARE REFERENCED PER THE RECORDED PLAT.

LOT	BLOCK	SUBDIVISION		SECTION
4	3	LONG MEADOW FARMS		2
COUNTY	STATE	RECORDATION	SURVEY	SCALE: 1"=20'
FORT BEND	TEXAS	PLAT NO. 20040050 F.B.C.P.R.	ADDRESS	
PURCHASER	DENISE HOSSLER		20915 LONELY STAR LANE, RICHMOND, TEXAS 77469	

BUILDER MUST VERIFY ALL BUILDING LINES, EASEMENTS, BUILDING LINE RESTRICTIONS (DEED RESTRICTIONS, ETC.) AND ZONING ORDINANCES, IF ANY, THAT MAY AFFECT SUBJECT PROPERTY, BEFORE STARTING CONSTRUCTION.

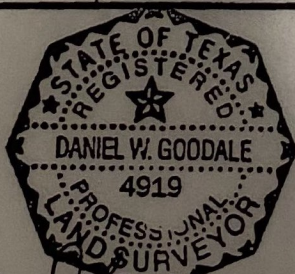

-SURVEYOR HAS NOT ABSTRACTED SUBJECT PROPERTY.
 -SURVEY IS BASED ON TITLE COMMITMENT LISTED BELOW.
 -ALL BUILDING LINES AND EASEMENTS ARE PER RECORDED PLAT UNLESS OTHERWISE SHOWN.
 -THIS SURVEY IS CERTIFIED FOR THIS TRANSACTION ONLY. IT IS NOT TRANSFERABLE TO ADDITIONAL INSTITUTIONS OR SUBSEQUENT OWNERS.

Accurate Surveys of Texas Inc.
 5151 MITCHELL DALE SUITE A-6
 HOUSTON, TEXAS 77092
 TEL: (713)-869-6966
 FAX: (713)-864-4266

Daniel W. Goodale 12-23-05
 DANIEL W. GOODALE R.P.L.S. No. 4919

I HEREBY CERTIFY THAT THIS SURVEY WAS MADE ON THE GROUND UNDER MY SUPERVISION AND THAT IT CORRECTLY REPRESENTS THE FACTS FOUND AT THE TIME OF THE SURVEY. THERE WERE NO ENCROACHMENTS APPARENT ON THE GROUND EXCEPT AS SHOWN HEREON.

REVISION #	REVISION DESCRIPTION
1	-
2	12-23-05/AR- BUYER ADDED
MORTGAGE	-
TITLE	MILLENNIUM TITLE
GF#	04301976
CLIENT#	HW
FIELD	11
DRAFTING	1
KEY MAP	52
ASOT JOB #	41