



FAIRCREST DRIVE
(50' R.O.W.)

(CALLED S 47°12'13" E 50.00')

S 47°15'44" E 50.07'

CONCRETE WALK

P.U.E. 20'

LOT 5
BLOCK 4

(CALLED N 42°47'47" E 120.00')
N 42°46'17" E 120.01'

TWO STORY WOOD FRAME HOUSE

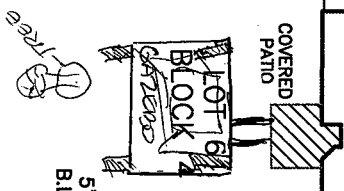

LOT 7
BLOCK 4

(CALLED S 42°47'47" W 120.00')
S 42°43'51" W 120.13'

LOT 8
BLOCK 4

(CALLED N 47°12'13" W 50.00')
N 47°07'31" W 50.15'

FUTURE DEVELOPMENT
MEADOWCREEK SUBDIVISION
REMAINDER OF 74.742 AC
6500/287

10' Utility Easement Recorded in:
Volume 7321, Page 193,
is a blanket easement.
File name: BLOCK4-LOT6--06459-FINAL.DWG
Plot date: 02/21/07 at 11:44
Updated: 04/05/2007 (fence added)

RESTRICTIONS RECORDED IN:
VOL. 7138, PG. 121
VOL. 7321, PG. 193

EASEMENTS RECORDED IN:
VOL. 303, PG. 279
VOL. 303, PG. 267
VOL. 874, PG. 585
VOL. 874, PG. 621
VOL. 2779, PG. 202
DO NOT APPLY

- S/E
 - E/E
 - CHA
 - W/O
 - BAR
 - D/R
 - E/E
 - R/G
 - U/T
 - ORL
 - PLA
 - RES
- 5/8" IRON ROD

Survey Notes:

- 1). The bearing bearing for Volume 7138, Page
- 2). Drawing Scale 1
- 3). Technician: CH
- 4). Sold lot is not Federal Emergency 4804100200 C. Do

I, Dante Carlomagno do hereby certify that this representation of the land is a true and correct representation of the land as supervised and the otherwise shown.

[Signature]
Dante Carlomagno
Registered Professional
Land Surveyor

PLA

LOT No.: SIX (6)
BLOCK No.: FOUR
SUBDIVISION: MEADOWCREEK
STREET ADDRESS:
CITY: COLLEGE
SURVEYED FOR: J
TITLE CO.: UNIVER
Carlomagno
2714 F
PHONE: (97



FAIRCREST DRIVE
(50' R.O.W.)

(CALLED S 47°12'13" E 50.00')

S 47°15'44" E 50.07'

CONCRETE WALK

20' P.U.F.

CONCRETE DRIVE

5' B.L.

5' B.L.

20' B.L.

5' B.L.

(CALLED N 42°47'47" E 120.00')
N 42°46'17" E 120.01'
TWO STORY WOOD FRAME HOUSE
COVERED PORCH
COVERED PATIO
(CALLED S 42°47'47" W 120.00')
S 42°43'51" W 120.13'

LOT 5
BLOCK 4

LOT 6
BLOCK 4

LOT 7
BLOCK 4

LOT 8
BLOCK 4

(CALLED N 47°12'13" W 50.00')

N 47°07'31" W 50.15'

0.46'

10' Utility Easement Recorded In:
Volume 7321, Page 193,
is a blanket easement.

File name: BLOCK4-LOT06-06459-FINAL.DWG
Plot date: 02/21/07 at 11:44
Updated: 04/05/2007 (fence added)

RESTRICTIONS RECORDED IN:
VOL. 7138, Pg. 121
VOL. 7321, Pg. 193

FUTURE DEVELOPMENT
MEADOWCREEK SUBDIVISION
REMAINDER OF 74.742 AC
6500/287

EASEMENTS RECORDED IN:
VOL. 303, PG. 279
VOL. 303, PG. 267
VOL. 874, PG. 585
VOL. 874, PG. 621
VOL. 2779, PG. 202
DO NOT APPLY

---	P
---	S&L
---	ELE
---	CH
---	WOL
---	B&A
---	DR
---	ELE
---	RIG
---	UTL
---	ORL
---	PLA
---	RES
⊗	5/8" IRON ROD

Survey Notes:

1) The bearing bearing
Volume 7138, Page

2) Drawing Scale

3) Technician: C.H

4) Said lot is not
Federal Emergency
48041C0200 C. D.

I, Dante Carlomagno
do hereby certify the
representation of a
superintendent and the
otherwise shown.

Dante Carlomagno
Registered Professional
Land Surveyor

PIA

LOT No.: SIX (6)

BLOCK No.: FOUR

SUBDIVISION: MEA

STREET ADDRESS:

CITY: COLLEGE

SURVEYED FOR: JA

TITLE CO.: UNIVER

Carlomagno

2714 F
PHONE: (97
WV