

1149 ARLINGTON ST.
Inspected Address

HOUSTON
City

77009
Zip Code

SCOPE OF INSPECTION

- A. This inspection covers only the multi-family structure, primary dwelling or place of business. Sheds, detached garages, lean-tos, fences, guest houses or any other structure will not be included in this inspection report unless specifically noted in Section 5 of this report.
B. This inspection is limited to those parts of the structure(s) that are visible and accessible at the time of the inspection. Examples of inaccessible areas include but are not limited to (1) areas concealed by wall coverings, furniture, equipment and stored articles and (2) any portion of the structure in which inspection would necessitate removing or defacing any part of the structure(s) (including the surface appearance of the structure). Inspection does not cover any condition or damage which was not visible in or on the structure(s) at time of inspection but which may be revealed in the course of repair or replacement work.
C. Due to the characteristics and behavior of various wood destroying insects, it may not always be possible to determine the presence of infestation without defacing or removing parts of the structure being inspected. Previous damage to trim, wall surface, etc., is frequently repaired prior to the inspection with putty, spackling, tape or other decorative devices. Damage that has been concealed or repaired may not be visible except by defacing the surface appearance. The WDI inspecting company cannot guarantee or determine that work performed by a previous pest control company, as indicated by visual evidence of previous treatment; has rendered the pest(s) inactive.
D. If visible evidence of active or previous infestation of listed wood destroying insects is reported, it should be assumed that some degree of damage is present.
E. If visible evidence is reported, it does not imply that damage should be repaired or replaced. Inspectors of the inspection company usually are not engineers or builders qualified to give an opinion regarding the degree of structural damage. Evaluation of damage and any corrective action should be performed by a qualified expert.
F. THIS IS NOT A STRUCTURAL DAMAGE REPORT OR A WARRANTY AS TO THE ABSENCE OF WOOD DESTROYING INSECTS.
G. If termite treatment (including pesticides, baits or other methods) has been recommended, the treating company must provide a diagram of the structure(s) inspected and proposed for treatment, label of pesticides to be used and complete details of warranty (if any). At a minimum, the warranty must specify which areas of the structure(s) are covered by warranty, renewal options and approval by a certified applicator in the termite category. Information regarding treatment and any warranties should be provided by the party contracting for such services to any prospective buyers of the property. The inspecting company has no duty to provide such information to any person other than the contracting party.
H. There are a variety of termite control options offered by pest control companies. These options will vary in cost, efficacy, areas treated, warranties, treatment techniques and renewal options.
I. There are some specific guidelines as to when it is appropriate for corrective treatment to be recommended. Corrective treatment may only be recommended if (1) there is visible evidence of an active infestation in or on the structure, (2) there is visible evidence of a previous infestation with no evidence of a prior treatment.
J. If treatment is recommended based solely on the presence of conducive conditions, a preventive treatment or correction of conducive conditions may be recommended. The buyer and seller should be aware that there may be a variety of different strategies to correct the conducive condition(s). These corrective measures can vary greatly in cost and effectiveness and may or may not require the services of a licensed pest control operator. There may be instances where the inspector will recommend correction of the conducive conditions by either mechanical alteration or cultural changes. Mechanical alteration may be in some instances the most economical method to correct conducive conditions. If this inspection report recommends any type of treatment and you have any questions about this, you may contact the inspector involved, another licensed pest control operator for a second opinion, and/or the Structural Pest Control Service of the Texas Department of Agriculture.

1A. ONE WAY - THE RIGHT WAY Name of Inspection Company 1B. 0569459 SPCS Business License Number
1C. 919 Address of Inspection Company HOUSTON TX 77008 832.729.7126 City State Zip Telephone No.
1D. MIKE MORRISON Name of Inspector (Please Print) 1E. Certified Applicator [] (check one) Technician []

2. NA Case Number (VA/FHA/Other) 3. 1-9-2020 Inspection Date
4A. RYAN TAYLOR Name of Person Purchasing Inspection Seller [] Agent [] Buyer [x] Management Co. [] Other []
4B. DE RECORD Owner/Seller
4C. REPORT FORWARDED TO: Title Company or Mortgagee [] Purchaser of Service [] Seller [] Agent [] Buyer [x] (Under the Structural Pest Control regulations only the purchaser of the service is required to receive a copy)

The structure(s) listed below were inspected in accordance with the official inspection procedures adopted by the Texas Department of Agriculture Structural Pest Control Service. This report is made subject to the conditions listed under the Scope of Inspection. A diagram must be attached including all structures inspected.
5. HOUSE + GARAGE /APT
List structure(s) inspected that may include residence, detached garages and other structures on the property. (Refer to Part A, Scope of Inspection)

6A. Were any areas of the property obstructed or inaccessible? Yes [x] No []
(Refer to Part B & C, Scope of Inspection) If "Yes" specify in 6B.
6B. The obstructed or inaccessible areas include but are not limited to the following:
Attic [] Insulated area of attic [] Plumbing Areas [] Planter box abutting structure []
Deck [] Sub Floors [] Slab Joints [] Craw Space []
Soil Grade Too High [] Heavy Foliage [] Eaves [] Weepholes []
Other [] Specify: THIS IS A VISUAL INSPECTION ONLY. GOOD OF THE DAY OF THE INSPECTION ONLY.
VOIDS AVE TO: WALLS, CEILING, FLOORS & ROOF COMPONENTS. (SEE GRAPH PAGE)

7A. Conditions conducive to wood destroying insect infestation: Yes [x] No []
(Refer to Part J, Scope of Inspection) If "Yes" specify in 7B.
7B. Conducive Conditions include but are not limited to:
Debris under or around structure (K) [] Wood to Ground Contact (G) [] Formboards left in place (I) [] Excessive Moisture (J) []
Planter box abutting structure (O) [] Footing too low or soil line too high (L) [] Wood Rot (M) [] Heavy Foliage (N) []
Insufficient ventilation (T) [] Wood Pile in Contact with Structure (Q) [] Wooden Fence in Contact with the Structure (R) []
Other (C) [] Specify: (SEE GRAPH PAGE)

8. Inspection Reveals Visible Evidence in or on the structure:
8A. Subterranean Termites Active Infestation Yes [x] No [] Previous Infestation Yes [x] No [] Previous Treatment Yes [x] No []
8B. Drywood Termites Active Infestation Yes [x] No [] Previous Infestation Yes [x] No [] Previous Treatment Yes [x] No []
8C. Formosan Termites Active Infestation Yes [x] No [] Previous Infestation Yes [x] No [] Previous Treatment Yes [x] No []
8D. Carpenter Ants Active Infestation Yes [x] No [] Previous Infestation Yes [x] No [] Previous Treatment Yes [x] No []
8E. Other Wood Destroying Insects Active Infestation Yes [x] No [] Previous Infestation Yes [x] No [] Previous Treatment Yes [x] No []
Specify: DALL HOLES

8F. Explanation of signs of previous treatment (including pesticides, baits, existing treatment stickers or other methods) identified:
8G. Visible evidence of: TERMITES has been observed in the following areas: SEE GRAPH PAGE - AS - PREVIOUS SUB-TERRA TERMITES
AO - ACTIVE DRYWOOD TERMITES -
If there is visible evidence of active or previous infestation, it must be noted. The type of insect(s) must be listed in the first blank and all identified infested areas of the property inspected must be noted in the second blank. (Refer to Part D, E & F, Scope of Inspection)

TEXAS OFFICIAL WOOD DESTROYING INSECT REPORT

The conditions conducive to insect infestation reported in 7A & 7B:
 9. Will be or has been mechanically corrected by inspecting company:
 If "Yes," specify corrections:

Yes No

9A. Corrective treatment recommended for active infestation or evidence of previous infestation with no prior treatment as identified in Section 8. (Refer to Part G, H, and I, Scope of Inspection):
 9B. A preventive treatment and/or correction of conducive conditions as identified in 7A & 7B is recommended as follows:

Yes No
 Yes No

Specify reason: WOOD ROT
 Refer to Scope of Inspection Part J

10A. This company has treated or is treating the structure for the following wood destroying insects: NO
 If treating for subterranean termites, the treatment was: Partial Spot Bait Other
 If treating for drywood termites or related insects, the treatment was: Full Limited

10B. NA NA NA
 Date of Treatment by Inspecting Company Common Name of Insect Name of Pesticide, Bait or Other Method

This company has a contract or warranty in effect for control of the following wood destroying insects:
 Yes No List Insects:
 If "Yes", copy(ies) of warranty and treatment diagram must be attached.

Diagram of Structure(s) Inspected

The inspector must draw a diagram including approximate perimeter measurements and indicate active or previous infestation and type of insect by using the following codes:
 E-Evidence of Infestation, A-Active; P-Previous; D-Drywood Termites; S-Subterranean Termites; F-Formosan Termites; C-Conducive Conditions; B-Wood Boring Beetles;
 H-Carpenter Ants; Other(s) - Specify 1148 ARLINGTON ST. 32'

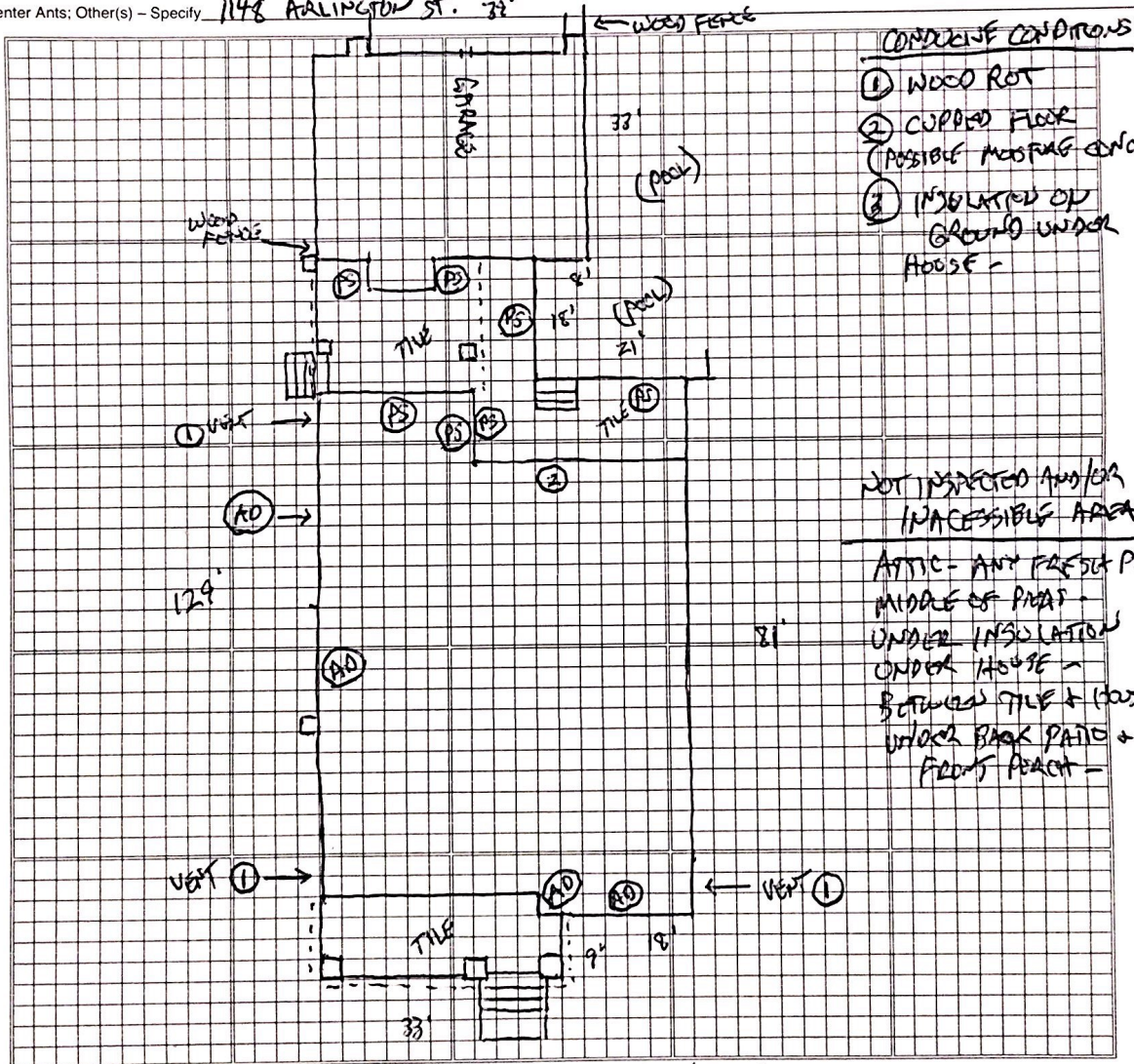

- CONDUCIVE CONDITIONS**
- ① WOOD ROT
 - ② CUPPED FLOOR (POSSIBLE MISSING CONCERN)
 - ③ INSULATED ON GROUND UNDER HOUSE -
- NOT INSPECTED AND/OR INACCESSIBLE AREAS**
- ATTIC - ANY FRESH PAINT
 - MIDDLE OF FRONT
 - UNDER INSULATION UNDER HOUSE -
 - BETWEEN TILE & HOUSE
 - UNDER BACK PATIO & FRONT PORCH -

Additional Comments IF NOT UNDER A CURRENT SUB-TERRA TERMITE CONTRACT -
I WOULD RECOMMEND A TREATMENT -
I WOULD RECOMMEND FUMIGATION AS TREATMENT FOR DRYWOOD TERMITES -

Neither I nor the company for which I am acting have had, presently have, or contemplate having any interest in the property. I do further state that neither I nor the company for which I am acting is associated in any way with any party to this transaction.

Signatures
 11A. [Signature]
 Inspector
 Approved: [Signature] 0561147
 11B. Certified Applicator and Certified Applicator License Number

12A. Notice of Inspection Was Posted At or Near:
 Electric Breaker Box
 Water Heater Closet
 Bath Trap Access
 Beneath the Kitchen Sink
 12B. Date Posted 1-9-2026
 Date

Statement of Purchaser
 I have received the original or a legible copy of this form. I have read and understand any recommendations made. I have also read and understand the "Scope of Inspection."
 I understand that my inspector may provide additional information as an addendum to this report.
 If additional information is attached, list number of pages: _____
 Signature of Purchaser of Property or their Designee: _____ Date: _____



TERMITE & PEST CONTROL SERVICE

One Way - The Right Way
919 Tulane St.
Houston, Texas 77008
832.729.7126

Invoice
Date: 01/09/2020

8:30am

mikemorrison59@gmail.com

VENMO: @onewaytherightway

BILL TO:
Ryan Taylor
1148 Arlington St.
Houston, TX. 77009

SERVICE TO:
Same as BILL TO:

Ph: 281.808.8622 c

Wood Destroying Insect Report (WDIR) \$250.00

If you have any question's, please contact me.

Sub-Total \$250.00
(8.25%) Tax \$ 20.63
Total \$270.63

Sqft: 4866	Foundation: P&B	Siding: Brick/Wood	Roof: Comp
Insp: NA	Built: 2006	Story: 2	Occupied:
Agt:			

Licensed and regulated under the Texas Department of Agriculture
P.O.Box 12847, Austin, TX. 78711-2847
Phone: 886-918-4481 Fax: 888-232-2567

Thank You for allowing us to take care of your termite & pest control needs...

Lic# 0561147 TPCL #0569459

Consumer Information Sheet available at the Texas Dept. of Agr. Website

ONE WAY - The Right Way designs & installs MOSQUITO MISTING SYSTEMS

Pest Control Service Bid: $\$75 + TAX$
Sub-Terr Termite Contract Bid: ---
Sub-Terr Termite Treatment Bid Range: $\$2000 - \$2500 + TAX$