

GF NO. 150004844 TEXAS HOMELAND TITLE
 ADDRESS: 25 INDIAN WELLS LANE
 CONROE, TEXAS 77304
 BORROWER: CRAIG BLACK AND
 ASHTON BLACK

LOT 25 HIWON, SECTION 2, PANORAMA SUBDIVISION

ACCORDING TO THE MAP OR PLAT THEREOF RECORDED
 IN VOLUME 8, PAGE 31 OF THE MAP RECORDS
 OF MONTGOMERY COUNTY, TEXAS



THIS PROPERTY DOES NOT LIE WITHIN THE
 100 YEAR FLOOD PLAIN AS PER FIRM
 PANEL NO. 48339C 0240 G
 MAP REVISION: 08-18-2014
 ZONE X
 BASED ONLY ON VISUAL EXAMINATION OF MAPS.
 INACCURACIES OF FEMA MAPS PREVENT EXACT
 DETERMINATION WITHOUT DETAILED FIELD STUDY

A SUBSURFACE INVESTIGATION
 WAS BEYOND THE SCOPE OF THIS SURVEY

D.C.L. = DIRECTIONAL CONTROL LINE
 RECORD BEARING: VOL. 8, PG. 31, M.C.M.T.

I HEREBY CERTIFY THAT THIS SURVEY WAS MADE
 ON THE GROUND, THAT THIS PLAT CORRECTLY
 REPRESENTS THE FACTS FOUND AT THE
 TIME OF SURVEY AND THAT THERE ARE NO
 ENCROACHMENTS APPARENT ON THE GROUND,
 EXCEPT AS SHOWN HEREON. THIS SURVEY IS
 CERTIFIED FOR THIS TRANSACTION ONLY AND
 ABSTRACTING PROVIDED IN THE ABOVE
 REFERENCED TITLE COMMITMENT WAS RELIED
 UPON IN PREPARATION OF THIS SURVEY.

GEORGE GALE
 PROFESSIONAL LAND SURVEYOR
 NO. 4678
 JOB NO. 15-05738
 JUNE 19, 2015

DRAWN BY: VT

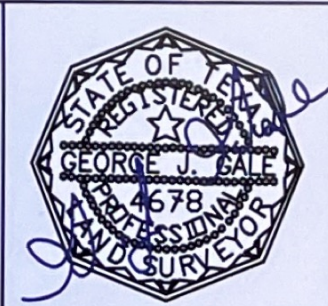

**RICHARDS AND
 ASSOCIATES
 REAL ESTATE GROUP**
 CODY RICHARDS
 936-537-3138

