

THE FOLLOWING IS A SUMMARY OF THE INFORMATION CONTAINED IN THIS SURVEY REPORT. THIS SUMMARY IS NOT A SUBSTITUTE FOR THE FULL REPORT AND SHOULD NOT BE USED TO DETERMINE THE ACCURACY OF THE SURVEY. THE FULL REPORT SHOULD BE REFERRED TO FOR A COMPLETE AND DETAILED ACCOUNT OF THE SURVEY. THE SURVEY WAS CONDUCTED ON 12/28/2008 BY CHAMPIONS SURVEYING INC. THE SURVEY WAS PERFORMED IN ACCORDANCE WITH THE STANDARDS AND PRACTICES OF THE SURVEYING PROFESSION. THE SURVEY WAS PERFORMED IN ACCORDANCE WITH THE STANDARDS AND PRACTICES OF THE SURVEYING PROFESSION. THE SURVEY WAS PERFORMED IN ACCORDANCE WITH THE STANDARDS AND PRACTICES OF THE SURVEYING PROFESSION.

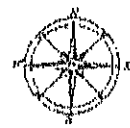

CHAMPIONS SURVEYING INC.
 1000 POWLER AND SHERIDAN PORTS
 1000 POWLER AND SHERIDAN PORTS



Surveyor's Name			
TODD POWLER AND SHERIDAN PORTS			
DATE	SCALE	PROJECT	NO.
12/28/2008	AS SHOWN	USA PROP	9368949842

THIS SURVEY REPORT IS THE PROPERTY OF CHAMPIONS SURVEYING INC. AND IS NOT TO BE REPRODUCED OR TRANSMITTED IN ANY FORM OR BY ANY MEANS, ELECTRONIC OR MECHANICAL, INCLUDING PHOTOCOPYING, RECORDING, OR BY ANY INFORMATION STORAGE AND RETRIEVAL SYSTEM, WITHOUT THE WRITTEN PERMISSION OF CHAMPIONS SURVEYING INC.

Champions Surveying, Inc.
33122 S.H. 249
Pinehurst, Texas 77362
(281) 259-5453
Fax (281) 259-9346

A tract of land containing 50.036 acres out of the Jno. B. Tong Survey, Abstract Number 466 of Grimes County, Texas, and being the same called 50 acre tract of land described in deed to Eunice Lawrence Barns as recorded under Volume 514, Page 625 of the Real Property Records of Grimes County (R.P.R.G.C.) and being more particularly described by metes and bounds as follows:

COMMENCING at a concrete monument (found) for the northwest corner of the herein described tract and for a called 50 acre tract called 50 acre tracts as described in deed to Richard B. Lawrence as recorded under Volume 377, Page 965 of the Real Property Records of Grimes County (R.P.R.G.C.) and the north line of the Jno. B. Tong Survey and the south line of the C.C. Meachum Survey, Abstract Number 513 and being the northeast corner of a called Tract 21 being a called 953.44 acre tract as described in deed to Pinecone Resources, L.L.C. as recorded under Volume 1066, Page 560 R.P.R.G.C. and the south line of a called 29.68 acre tract as described in deed to Thomas J. Floyd as recorded under Volume 315, Page 299 of the Deed Records of Grimes County;

THENCE N 88 deg 37 min 12 sec E, along the common survey lines and the common lines of said 50 acre tract and said 29.68 acre tract a distance of 2182.70 feet to a concrete monument (found) for the northeast corner of the herein described tract and the northwest corner of a called 284.841 acre tract as described in deed to Hlland E. Womack as recorded under Volume 1088, Page 254 R.P.R.G.C.;

THENCE S 00 deg 23 min 00 sec W, along the east line of the herein described and the west line of said 284.841 acre tract a distance of 707.81 feet to the Point of Beginning;

THENCE S 00 deg 23 min 00 sec W, continuing along the east line of the herein described and the west line of said 284.841 acre tract a distance of 861.14 feet to a concrete monument (found) for the eastern most southeast corner of the herein described tract and an interior corner of said 284.841 acre tract;

THENCE N 89 deg 34 min 40 sec W, along the easterly south line of said Eunice Lawrence Barns tract a distance of 1090.80 feet to concrete monument (found) for an interior corner of the herein described tract;

L:\word\C050240-TRCT2.doc

THENCE S 00 deg 25 min 28 sec W, along the southerly east line of the herein described tract and the west line of said 284.841 acre tract a distance of 1005.33 feet to a concrete monument (found for the southerly southeast corner of the herein described tract and the southwest corner of said 284.841 acre tract;

THENCE N 89 deg 48 min 48 sec W, along the south line of the herein described tract and the north line of a portion of said Tract 21 a distance of 664.03 feet to a point for the southwest corner of the herein described tract and the southeast corner of said Lawrence tract;

THENCE N 00 deg 23 min 00 sec E, along the west line of the herein described tract and the east line of said Lawrence tract a distance of 1868.02 feet to a point for corner interior corner;

THENCE S 89 deg 37 min 00 sec E, along the north line of the herein described tract and the south line of a called Lawrence tract a distance of 1755.56 feet to the Point of Beginning and containing 50.036 acres of land.

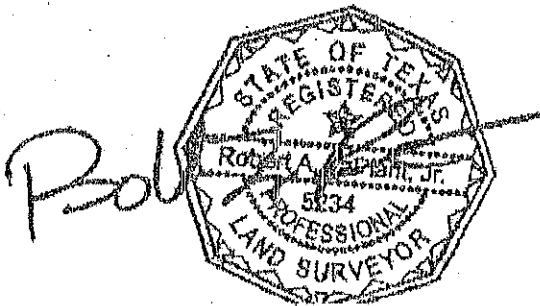

A separate plat map has been prepared in conjunction with these metes and bounds.

EXHIBIT A

GUARANTY TITLE COMPANY
OF GRIMES COUNTY
P.O. BOX 1540
211 E. WASHINGTON
NAVASOTA, TX 77868

05-415