

- NOTES:
- 1.) SURVEY DONE WITHOUT A CURRENT TITLE REPORT.
 - 2.) SURVEYOR HAS NOT COMPLETELY ABSTRACTED SUBJECT PROPERTY.
 - 3.) SUBJECT TO ANY EASEMENTS OR RESTRICTIONS OF RECORD.
 - 4.) ASPH. DRIVE AND CARPORT EXTEND ONTO LOT 20 AS SHOWN.
- ALL BEARINGS SHOWN ARE REFERENCED PER RECORDED PLAT OF SAID SUBDIVISION.

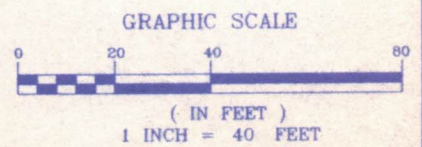

**STEVEN BRISTER
AND ASSOCIATES, INC.**

1300 S. FRAZIER, SUITE 105
CONROE, TEXAS 77301
PHONE: (936) 788-7705
FAX: (936) 441-7507

**LOTS 20, 21 AND 38 OF TRI LAKES,
SECTION TWO, AS RECORDED IN VOL. 7,
PG. 141 OF THE MAP RECORDS OF
MONTGOMERY COUNTY, TEXAS**

I HEREBY CERTIFY THAT THIS PLAT REPRESENTS THE RESULTS
OF A SURVEY MADE ON THE GROUND UNDER MY SUPERVISION.

Steven P. Brister

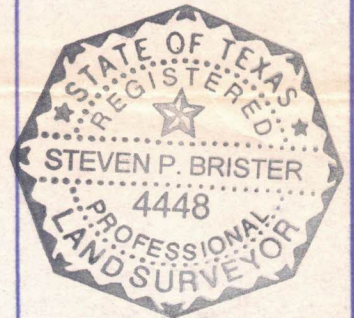

* SUBJECT PROPERTY IS NOT LOCATED IN A FEDERAL INSURANCE ADMINISTRATION DESIGNATED FLOOD HAZARD AREA & IS IN ZONE "X". COMMUNITY NO. 480483, PANEL 0330 F, DATED: 12-19-96. This information is based on graphic plotting only, we do not assume responsibility for exact determination.

PURCHASER: DAVID BORNE		JOB NO.: 0806-036	
ADDRESS: 23842 NORTH LAKE SHORE ROAD		KEY MAP: 152-E	
MORT. CO.: -	TITLE CO.: -	G.F. NO.: -	
FIELD WORK: 08-15-06 JB	DRAFTING: 08-17-06 CDF	FINAL CHECK: 08-17-06 SB	REVISED: -