

I hereby certify that this survey was made on the ground under my supervision and that this drawing correctly represents the facts found at the time of survey.

Date of Survey: 31 July 2003

Michael C. Warren
 Registered Professional Land Surveyor No. 4935

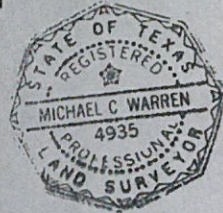

LAND TITLE SURVEY
 FOR: LYNDA N. ALLEN

20150 RED OAK DRIVE
 CLEVELAND, TEXAS 77327

BEING a 4.50 acre tract of land situated in the Edward Wrentmore Survey, Abstract No. 633, Montgomery County, Texas, a portion of Lot 17 of SECURITY SUBDIVISION, Section Three, according to the map or plat thereof recorded in Volume 1, Page 16 of the Map Records of Montgomery County, Texas, said 4.50 acre tract being more particularly described by attached metes and bounds.

SCALE: 1"=100'

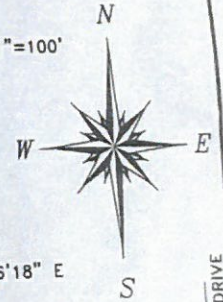

Record data as shown hereon was relied upon partly from a Commitment for Title Insurance issued by the following qualified provider:
 First American Title Company
 G.F. No. TX03-219013-H042
 Effective date: July 16, 2003

**SECURITY SUBDIVISION
 SECTION THREE
 VOLUME 1, PAGE 16 M.C.M.R.**

Revised 08/09/05 to divide out 0.488 acre tract from 4.988 acre tract as originally Surveyed 31 July 2003.

QUADRANT SOLUTIONS
 P.O. BOX 1343 WILLIS, TEXAS 77378
 (936) 856-8989
 PROJECT NO.: 04703

Allen Workman
 CF 8245098

Mary Lynch
 CF 9429125

30' Wide Road Esmt.
 Reserved under CF 9430012
 (See attached metes & bounds)

15' Road Esmt. 1/16 MCMR