

ENHANCEMENT CHANGE ORDER

ADDRESS: 651 ARROYO SIERRA
NEW BRAUNFELS, TX 78130
COMMUNITY: ARROYO VERDE 45' LOT
PURCHASER: Ryan Shane Bradley Voight
SALES PROFESSIONAL: Odom, Blake

C.O. NO: 8
DATE: 09/20/20
PROJECT #: 000676
JOB #: 676081
STAGE OF CONSTRUCTION: FRAME
LOT: 13
BLOCK: 4
PLAN: 1992W FA / 2
PHASE: 400

THE FOLLOWING UPGRADED SELECTIONS AND/OR NON-STANDARD MODIFICATIONS HAVE BEEN REQUESTED. ALL CHARGES SHOWN HERE ARE FOR THE CHANGE(S) SHOWN. ALL CONDITIONS OF THE EARNEST MONEY CONTRACT REMAIN IN EFFECT EXCEPT AS MODIFIED BELOW.

ITEM NO	OPTION CODE	DESCRIPTION	QTY	UNIT PRICE	EXT PRICE	CASH	ADDT'L EM
1	DSW03	GE DISHWASHER WITH HIDDEN CONTROLS - BLA CK SLATE	1	\$85.00	\$85.00	No	
2	DSW01	GE DISHWASHER WITH HIDDEN CONTROLS - STA INLESS STEEL	-1	\$0.00	\$0.00	No	
3	MCW03	GE OVER-THE-RANGE MICROWAVE OVEN BLACK S LATE	1	\$155.00	\$155.00	No	
4	MCW01	GE OVER-THE-RANGE MICROWAVE OVEN STAINLE SS STEEL	-1	\$0.00	\$0.00	No	
5	RNG05	GE SLIDE-IN GAS RANGE - BLACK SLATE	1	\$330.00	\$330.00	No	
6	RNG01	GE SLIDE-IN GAS RANGE - STAINLESS STEEL	-1	\$0.00	\$0.00	No	
7	VRJP	ALL VANITY CABINETS - PAINTED	-1	\$0.00	\$0.00	No	
8	VRJS	ALL VANITY CABINETS - STAINED	1	\$0.00	\$0.00	No	
9	42RPJ	42" KITCHEN CABINETS - PAINTED	-1	\$0.00	\$0.00	No	
10	42ROJ	42" KITCHEN CABINETS - STAINED	1	\$0.00	\$0.00	No	
11	CHD54	CHANDELIER: GANNET WEATHERED OAK FIVE BU LBS (QUANTITY= #FIXTURES) Morning Area	1	\$215.00	\$215.00	No	
12	CHD56	CHANDELIER: GANNET WEATHERED OAK FOUR BU LBS (QUANTITY= # FIXTURES) Entry	1	\$100.00	\$100.00	No	
13	CHL29	COACH LIGHT: ALBAN ANTIQUE BRONZE - LARG E (QUANTITY= # FIXTURES)	-2	\$140.00	(\$280.00)	No	
14	CHL41	COACH LIGHT: WARREN BLACK - SMALL (QUANT ITY= # FIXTURES)	2	\$195.00	\$390.00	No	
15	BRNZE	BRONZE CEILING MOUNTED LIGHTS, AND WALL SCONCES	1	\$0.00	\$0.00	No	
16	NICKL	NICKEL CEILING MOUNTED LIGHTS, AND WALL SCONCES	-1	\$0.00	\$0.00	No	
17	4SL01	4 BULB BATH STRIP LIGHT: ALEXANDRIA NICK EL (QUANTITY= # FIXTURES)	-3	\$0.00	\$0.00	No	
18	4SL02	4 BULB BATH STRIP LIGHT: PARKFIELD NICKEL (QUANTITY= # FIXTURES)	3	\$75.00	\$225.00	No	
19	SPL13	SINGLE PENDANT LIGHT: BELTON BRONZE - SM (QUANTITY= # FIXTURES)	2	\$90.00	\$180.00	No	
20	SPL60	SINGLE PENDANT LIGHT: URBAN RENEWAL ANTI QUE FORGED IRON (QUANTITY= # FIXTURES)	-2	\$95.00	(\$190.00)	No	
21	EO108	ADDITIONAL EXTERIOR ELECTRICAL OUTLET - NO SWITCH INCLUDED	1	\$90.00	\$90.00	No	

22	EW100	PREWIRE FOR CEILING LIGHT (DOES NOT INCLUDE SWITCH/FIXTURE UNDER 30 POUNDS)	1	\$70.00	\$70.00	No
23	PAD03	LEVEL 3 PAD IN PLACE OF STANDARD PAD	82	\$8.50	\$697.00	No
24	LVP01	BASE LEVEL LUXURY VINYL PLANK IN PLACE OF STD CARPET - 1ST FLOOR	-552	\$6.95	(\$3,836.40)	No
25	LVP03	BASE LEVEL LUXURY VINYL PLANK IN PLACE OF STD TILE - 1ST FLOOR	-369	\$1.05	(\$387.45)	No
26	TL200	BASE TILE IN PLACE OF CARPET - 1ST FLOOR	552	\$7.40	\$4,084.80	No
27	TLUPM	LEVEL 1 TILE FLOORING PATTERN - (PATTERN UPGRADE ONLY - ECO QUANTITY SHOULD EQUAL SF OF TILE)	921	\$0.97	\$893.37	No
28	IDHRZ	HORIZONTAL PANEL INTERIOR DOORS (5-PANEL W/ 6'8" DOORS, 6-PANEL W/ 8'0" DOORS)	1	\$0.00	\$0.00	No
29	IDSQR	SQUARE 2 - PANEL INTERIOR DOORS	-1	\$0.00	\$0.00	No
30	PS310	KOHLER K6489 WHITE UNDERMOUNT FARM SINK IN PLACE OF MIRADO 105D	1	\$2,850.00	\$2,850.00	No
31	MSF2	PRIMARY SHOWER FLOOR TILE - LEVEL 2 TILE - IN PLACE OF STANDARD TILE	-1	\$112.00	(\$112.00)	No

Total: \$5,559.32
Financed Options: \$5,559.32
Cash Options: \$0.00

Notes:

_____ for the above is required to be paid as Change Order Deposits.
 \$0.00 for the above is required to be paid in cash.
 _____ for the above will be added to the Purchase Price via a Contract Amendment, which will be prepared by the Seller Sales Professional \$5,559.32 and which Purchaser agrees to sign.

FOR G.O. USE ONLY
Amount Received:
Initial:

PAYMENT OF THE ABOVE CONSIDERATION SHALL BE MADE PRIOR TO THE SELECTION BEING ORDERED FOR INSTALLATION IN THE HOME.

AGREED TO AND ACCEPTED BY:

DocuSigned by:

 PURCHASER/ORIGINATOR
7228DA41767A19A...

 PURCHASER/ORIGINATOR SALES PROFESSIONAL

Seller

 SALES PROFESSIONAL
 Odom, Blake
 Guerra, Nikki

PERRY HOMES

PHASE I

***** SEE REVISIONS *****

CONTRACT DATE: August 28, 2020
ESTIMATED RELEASE: July 31, 2020
JOB NUMBER: 676081
REVISED BY: nikkig

REVISION #: 1 REVISE DATE: September 17, 2020
ADDRESS: 651 ARROYO SIERRA
PURCHASER: Voight, Ryan
COMMUNITY: ARROYO VERDE 45' PERRY HOMES REPRESENTATIVE: nikkig
PLAN # & ELEV: 1992W-E2 SALES PROFESSIONAL: Nutt, Shane & Odom, Blake

KITCHEN CABINETS

ECO STD Option Code
STD 42ROJ J KRAFT CABINETS
Style: BEECH SHAKER PANEL
Color: STAINED - SLATE GRAY
Island: STAINED - SLATE GRAY

APPLIANCES

NOTE: GAS LINE FOR COOKTOP / RANGE IS ADDITIONAL OR NOT AVAILABLE IN SOME COMMUNITIES.
ECO STD
ECO DSW03 **DISHWASHER :** GE DISHWASHER WITH HIDDEN CONTROLS - BLACK SLATE
ECO MCW03 **MICROWAVE :** GE OVER-THE-RANGE MICROWAVE OVEN BLACK SLATE
ECO RNG05 **RANGE :** GE SLIDE-IN GAS RANGE - BLACK SLATE

KITCHEN SINK & FAUCET

ECO STD Option Code
ECO PS310 **SINK :** KOHLER K6489 UNDERMOUNT - WHITE
of Holes: 1
STD CHROME **FAUCET :** STANDARD - COLLINS PULLDOWN CHROME FAUCET
Escutcheon: NO ESCUTCHEON

KITCHEN COUNTERTOPS, HIGHBAR, ISLAND AND BUTLER'S PANTRY

ECO STD Option Code
ECO **KITCHEN / BUTLER'S PANTRY - COUNTERTOP :** ENGINEERED STONE
Selection: 4CM MESSINA
STD **KITCHEN / BUTLER'S PANTRY - EDGE** SQUARE

BACKSPLASH AND BUTLER'S PANTRY BACKSPLASH

ECO STD Option Code
STD **KITCHEN BACKSPLASH AND BUTLER'S PANTRY B** STANDARD BACKSPLASH DETAIL - M

DS
X SV I HAVE REVIEWED THE ITEMS SELECTED ABOVE WITH MY PERRY HOMES REPRESENTATIVE. RESELECTIONS ARE SUBJECT TO A PROCESSING FEE.

INITIAL
X SV ALL UPGRADES MUST BE PAID FOR ON AN ENHANCEMENT CHANGE ORDER BY
Signed by: _____ DATE: 9/20/2020

X Shikinal Voight PURCHASER
PERRY HOMES SELLER

PERRY HOMES

PHASE I

*****SEE REVISIONS*****

CONTRACT DATE: August 28, 2020
ESTIMATED RELEASE: July 31, 2020
JOB NUMBER: 676081
REVISED BY: nikkig

REVISION #: 1 REVISION DATE: September 17, 2020

ADDRESS: 651 ARROYO SIERRA

PURCHASER: Voight, Ryan

COMMUNITY: ARROYO VERDE 45' PERRY HOMES REPRESENTATIVE: nikkig

PLAN # & ELEV: 1992W-E2 SALES PROFESSIONAL: Nutt, Shane & Odom, Blake

X _____
PURCHASER

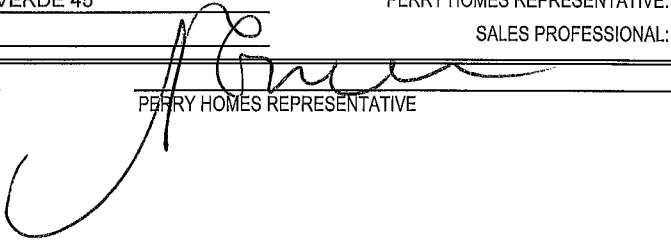
PERRY HOMES REPRESENTATIVE

DATE 9/17/20

PERRY HOMES

PHASE I

*****SEE REVISIONS*****CONTRACT DATE: August 28, 2020ESTIMATED RELEASE: July 31, 2020JOB NUMBER: 676081REVISED BY: nikkigREVISION #: 1 REVISE DATE: September 17, 2020ADDRESS: 651 ARROYO SIERRAPURCHASER: Voight, RyanCOMMUNITY: ARROYO VERDE 45'PERRY HOMES REPRESENTATIVE: nikkigPLAN # & ELEV: 1992W-E2SALES PROFESSIONAL: Nutt, Shane & Odom, Blake**BATH SHOWER SURROUND**ECO STD Option
Code

STD MASTER BATH : SATIN NICKEL

BATH MIRROR TRIMECO STD Option
Code
STANDARD

STD RD MASTER BATH : POLISHED MIRROR

STD RD SECONDARY BATHS : POLISHED MIRROR

BATH CABINETSECO STD Option
Code

STD VRJS MASTER BATH : J KRAFT BATH

Style : BEECH SHAKER PANEL

Color : STAINED - SLATE GRAY

STD VRJS SECONDARY BATHS : BEECH SHAKER PANEL

Color : STAINED - SLATE GRAY

MASTER BATH WINDOWECO STD Option
Code

GLASS OR GLASS BLOCK SELECTIO OBSCURE GLASS

BATHROOM PLUMBING FAUCETSECO STD Option
Code
STANDARD

STD CORE B MASTER BATH : STANDARD DELTA 4" CHROME CORE B

STD CORE B BATH #2 : STANDARD DELTA 4" CHROME CORE B

BATH HARDWAREECO STD Option
Code

STD TOWEL BAR #1 : STANDARD VENTURA POLISHED CHROME

Locations : ALL BATHS

BATH TILE SURROUND - MASTER BATH #1ECO STD Option
Code

STD SHOWER TILE : MASTER BATH

Shower Tile Detail : MASTER SHOWER - DETAIL E-BASE TILE

Tub Tile Detail : MASTER TUB - DETAIL E-BASE TILE

BATH TILE SURROUND - BATH #2ECO STD Option
Code

PERRY HOMES

PHASE I

SEE REVISIONS

CONTRACT DATE: August 28, 2020
 ESTIMATED RELEASE: July 31, 2020
 JOB NUMBER: 676081
 REVISED BY: nikkig

REVISION #: 1 REVERSE DATE: September 17, 2020
 ADDRESS: 651 ARROYO SIERRA
 PURCHASER: Voight, Ryan
 COMMUNITY: ARROYO VERDE 45' PERRY HOMES REPRESENTATIVE: nikkig
 PLAN # & ELEV: 1992W-E2 SALES PROFESSIONAL: Nutt, Shane & Odom, Blake

STD SHOWER TILE : HALL W/TUB
 Tub Tile Detail : HALL TUB - DETAIL E-BASE TILE

BATH VANITY COUNTERTOP - MASTER BATH

ECO	STD	Option Code
	STD	BATH VANITY : <u>MARLANA - BATH ONLY</u> Selection : <u>1.6CM ECHO</u>
	STD	SINK : <u>UNDERMOUNT SMALL RECTANGLE MIRADO</u> Color : <u>WHITE</u> Edge : <u>SQUARE</u>

BATH VANITY COUNTERTOP #2

ECO	STD	Option Code
	STD	BATH VANITY : <u>MARLANA - BATH ONLY</u> Selection : <u>1.6CM ECHO</u>
	STD	SINK : <u>UNDERMOUNT SMALL RECTANGLE MIRADO</u> Color : <u>WHITE</u> Edge : <u>SQUARE</u>

DS
 X SV I HAVE REVIEWED THE ITEMS SELECTED ABOVE WITH MY PERRY HOMES REPRESENTATIVE. RESELECTIONS ARE SUBJECT TO A PROCESSING FEE.
 INITIAL DS

X SV ALL UPGRADES MUST BE PAID FOR ON AN ENHANCEMENT CHANGE ORDER BY
 INITIAL DocuSigned by: 9/20/2020
 DATE

X Shikinali Voight PURCHASER
 PURCHASER

[Signature] PERRY HOMES SELLER
 PERRY HOMES REPRESENTATIVE

9/17/20 DATE

PERRY HOMES

PHASE I

***** SEE REVISIONS *****CONTRACT DATE: August 28, 2020ESTIMATED RELEASE: July 31, 2020JOB NUMBER: 676081REVISED BY: nikkigREVISION #: 1REVISE DATE: September 17, 2020ADDRESS: 651 ARROYO SIERRAPURCHASER: Voight, RyanCOMMUNITY: ARROYO VERDE 45'PERRY HOMES REPRESENTATIVE: nikkigPLAN # & ELEV: 1992W-E2SALES PROFESSIONAL: Nutt, Shane & Odom, Blake**STAIN COLOR**ECO STD Option
CodeSTD VELVET SMOKE (CUSTOM MIX)**GARAGE DOOR**ECO STD Option
CodeFLEUR **GARAGE DOOR STYLE :** FLEUR DE LIS STRAPS AND FLEUR DE LIS PULL HANDLESStyle: SONOMA**SHEETROCK**ECO STD Option
CodeSTD ROUND STANDARD - ROUND SHEETROCK CORNERS**DOOR HARDWARE**ECO STD Option
CodeSTD BRONZE VENETIAN BRONZE COVE KNOBSSTD BRONZE **FRONT DOOR HANDSET :** HAWTHORNE VENETIAN BRONZESTD BRONZE **KEYLESS ENTRY DEADBOLT :** 888 KEYLESS ENTRY DEADBOLT VENETIAN BRONZE**FRONT DOOR**ECO STD Option
CodeECO FDS01 LEVEL_1Glass Insert(s): CRAFTSMAN 6 LITE W/ NO SHELF - CLEARStain Color: VELVET SMOKEType: SINGLESize: 3068**LIGHT FIXTURE PACKAGE**ECO STD Option
CodeSTD 4SL02 **STRIP LIGHTS - MASTER BATH :** 4 BULB BATH STRIP LIGHT: PARKFIELD NICKELSTD 4SL02 **STRIP LIGHTS - BATH #2 :** 4 BULB BATH STRIP LIGHT: PARKFIELD NICKELSTD BRONZE/ **INTERIOR FAN - FAMILY ROOM :** INTERIOR 52" CEILING FAN: OLD JACKSONVILLE RUBBED BRONZE W/
ESPRESSO BLADES & 4 LIGHT W/ FROSTED GLASS**INTERIOR PAINT**ECO STD Option
CodeSTD PARTIAL INTERIOR LATEX WALLS (INCLUDING CEILING AREAS)Color: EXTRA WHITE - SW 7006Interior Enameled Wood: WORLDLY GRAY (SW 7043)

PERRY HOMES

PHASE I

DS
 SV I HAVE REVIEWED THE ITEMS SELECTED ABOVE WITH MY PERRY HOMES REPRESENTATIVE. RESELECTIONS ARE SUBJECT TO A PROCESSING FEE.

INITIAL DS
 SV ALL UPGRADES MUST BE PAID FOR ON AN ENHANCEMENT CHANGE ORDER BY

9/20/2020

DESIGNED BY: _____ DATE _____

Shikinala Voight
 PURCHASER

PERRY HOMES
 SELLER

[Handwritten Signature]

9/17/20
 DATE

 PURCHASER

 PERRY HOMES REPRESENTATIVE

PERRY HOMES

PHASE I

*****SEE REVISIONS*****CONTRACT DATE: August 28, 2020ESTIMATED RELEASE: July 31, 2020JOB NUMBER: 676081REVISED BY: nikkigREVISION #: 1 REVISE DATE: September 17, 2020ADDRESS: 651 ARROYO SIERRAPURCHASER: Voight, RyanCOMMUNITY: ARROYO VERDE 45' PERRY HOMES REPRESENTATIVE: nikkigPLAN # & ELEV: 1992W-E2 SALES PROFESSIONAL: Nutt, Shane & Odom, Blake**STAIN COLOR**ECO STD Option
CodeSTD VELVET SMOKE (CUSTOM MIX)**GARAGE DOOR**ECO STD Option
CodeFLEUR GARAGE DOOR STYLE : FLEUR DE LIS STRAPS AND FLEUR DE LIS PULL HANDLESStyle : SONOMA**SHEETROCK**ECO STD Option
CodeSTD ROUND STANDARD - ROUND SHEETROCK CORNERS**DOOR HARDWARE**ECO STD Option
CodeSTD BRONZE VENETIAN BRONZE COVE KNOBSSTD BRONZE FRONT DOOR HANDSET : HAWTHORNE VENETIAN BRONZESTD BRONZE KEYLESS ENTRY DEADBOLT : 888 KEYLESS ENTRY DEADBOLT VENETIAN BRONZE**FRONT DOOR**ECO STD Option
CodeECO FDS01 LEVEL_1Glass Insert(s) : CRAFTSMAN 6 LITE W/ NO SHELF - CLEARStain Color : VELVET SMOKEType : SINGLESize : 3068**LIGHT FIXTURE PACKAGE**ECO STD Option
CodeSTD 4SL02 STRIP LIGHTS - MASTER BATH : 4 BULB BATH STRIP LIGHT: PARKFIELD NICKELSTD 4SL02 STRIP LIGHTS - BATH #2 : 4 BULB BATH STRIP LIGHT: PARKFIELD NICKELSTD BRONZE/ INTERIOR FAN - FAMILY ROOM : INTERIOR 52" CEILING FAN: OLD JACKSONVILLE RUBBED BRONZE W/ ESPRESSO BLADES & 4 LIGHT W/ FROSTED GLASS**INTERIOR PAINT**ECO STD Option
CodeSTD PARTIAL INTERIOR LATEX WALLS (INCLUDING CEILING AREAS)Color : EXTRA WHITE - SW 7006Interior Enameled Wood : WORLDLY GRAY (SW 7043)

PERRY HOMES

PHASE I

DS

X SV I HAVE REVIEWED THE ITEMS SELECTED ABOVE WITH MY PERRY HOMES REPRESENTATIVE. RESELECTIONS ARE SUBJECT TO A PROCESSING FEE.

INITIAL

DS

X SV ALL UPGRADES MUST BE PAID FOR ON AN ENHANCEMENT CHANGE ORDER BY

9/20/2020

Signed by:

DATE

X Shikinah Voigt

PERRY HOMES
SELLER

PURCHASER

9/17/20
DATE

X _____
PURCHASER

[Signature]
PERRY HOMES REPRESENTATIVE

PERRY HOMES

PHASE I

*** SEE REVISIONS ***

CONTRACT DATE: August 28, 2020
 ESTIMATED RELEASE: July 31, 2020
 JOB NUMBER: 676081
 REVISED BY: nikkig

REVISION #: 1 REVERSE DATE: September 17, 2020
 ADDRESS: 651 ARROYO SIERRA
 PURCHASER: Voight, Ryan
 COMMUNITY: ARROYO VERDE 45' PERRY HOMES REPRESENTATIVE: nikkig
 PLAN # & ELEV: 1992W-E2 SALES PROFESSIONAL: Nutt, Shane & Odom, Blake

FLOORING

ECO	STD	Option Code
ECO		CERAMIC TILE : <u>MZ - MERCATO - BIANCO</u>
		DETAIL # : <u>M-5 MODULAR DETAIL</u> GROUT : <u>LATICRETE - STERLING SILVER #78</u> SIZE : <u>8X36</u>
		Room : <u>FAMILY ROOM</u>
		Room : <u>LIBRARY</u>
		Room : <u>UTILITY ROOM</u>
		Room : <u>KITCHEN</u>
		Room : <u>MORNING AREA</u>
		Room : <u>ENTRY</u>
		Room : <u>REAR ENTRY</u>
		Room : <u>EXT ENTRY</u>
		Room : <u>MASTER BATH & COMMODE</u>
		Room : <u>BATH #2</u>
		Room : <u>HALL #1</u>
	STD	CARPET STYLE : <u>MAINSTREAM - CAMEO</u> COLOR : _____
ECO	<u>LVL 3</u>	CARPET PAD : <u>1/2" 3M SCOTCHGARD</u>

^{DS} SV I HAVE REVIEWED THE ITEMS SELECTED ABOVE WITH MY PERRY HOMES REPRESENTATIVE. CERAMIC TILES WILL VARY IN TEXTURE, SHADE AND COLOR CREATING A NATURAL STONE LOOK. RESELECTIONS ARE SUBJECT TO A PROCESSING FEE.

^{DS} SV ALL UPGRADES MUST BE PAID FOR ON AN ENHANCEMENT CHANGE ORDER BY _____ DATE 9/20/2020

INITIAL
 DocuSigned by:
Shikinali Voight
 PURCHASER
 72804178749A...

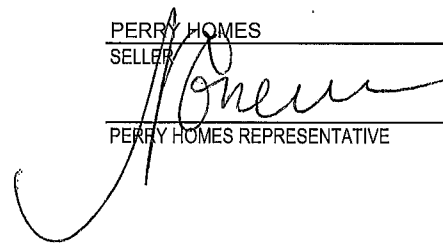
PERRY HOMES
 SELLER

 PERRY HOMES REPRESENTATIVE

DATE
9/17/20
 DATE

PERRY HOMES - UNDERMOUNT KITCHEN SINKS

LEGEND: F - FAUCET LH - LEVER HANDLE S - SPRAYER SD - SOAP DISPENSER AG - AIR GAP X - DO NOT DRILL C - CAPPED HOLE

NOTE: ALL FAUCET HOLES ARE DRILLED TO 4" CENTERS UNLESS OTHERWISE SPECIFIED.

MIRADO 310 UNDERMOUNT / (DOUBLE OFFSET)

STAINLESS STEEL

BLANCO SILGRANIT 511 (DOUBLE OFFSET)

BISCUIT METALLIC GRAY WHITE TRUFFLE
 CAFE BROWN ANTHRACITE CINDER CONCRETE GRAY

MIRADO 105D UNDERMOUNT / (DOUBLE OFFSET)

STAINLESS STEEL

BLANCO SILGRANIT 511 (SINGLE BOWL)

BISCUIT METALLIC GRAY WHITE TRUFFLE
 CAFE BROWN ANTHRACITE CINDER CONCRETE GRAY

MIRADO 209 UNDERMOUNT / (DOUBLE EQUAL)

STAINLESS STEEL

BLANCO SILGRANIT 511 (DOUBLE EQUAL)

BISCUIT METALLIC GRAY WHITE TRUFFLE
 CAFE BROWN ANTHRACITE CINDER CONCRETE GRAY

KOHLER 3943 UNDERMOUNT / (SINGLE BOWL)

STAINLESS STEEL

MIRADO HA100 (SINGLE BOWL)

ADDRESS: 651 ARROYO SIERRA

PLAN: 1992W

SIGNATURE: ARROYO VERDE 45

DATE: 9/20/2020

1-HOLE COLLINS *Shikinali Voight*
7228DA41787A49A...

BACKSPLASH DETAILS - STANDARD

BASE - LEVEL 1 MATERIAL

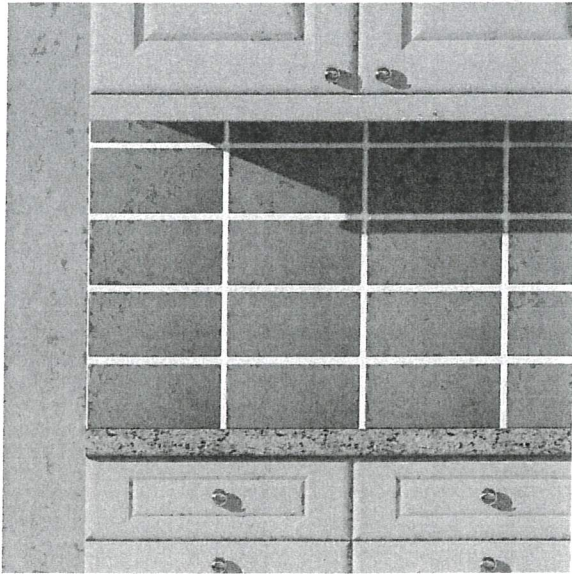

DETAIL J

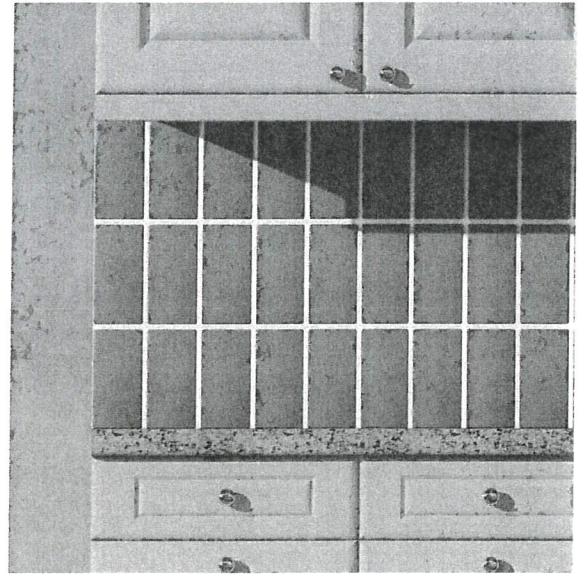

DETAIL K

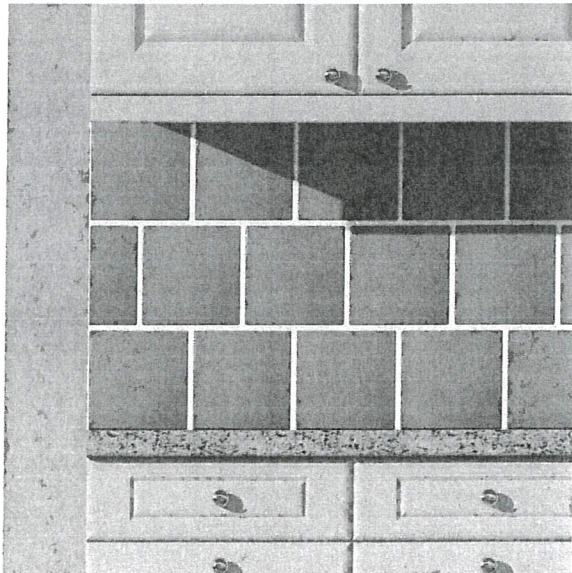

DETAIL L

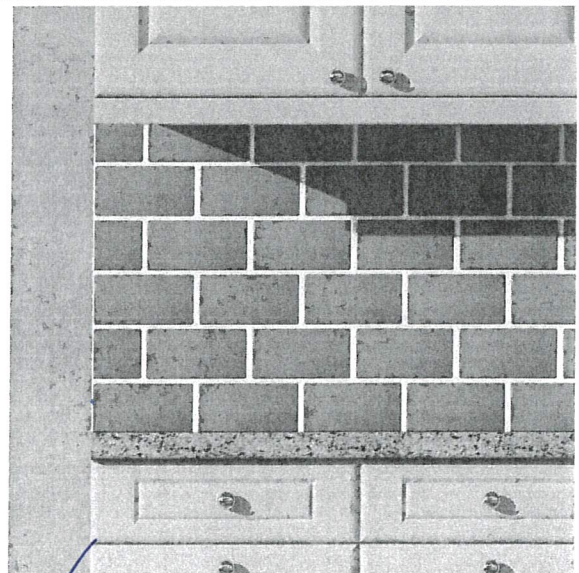

DETAIL M

Field tile: CT1 UP/DOWN *DOWN* 3x6

Grout: Lat #44 Bright White

Address: 651 Arroyo Sierra

Plan: 1992W

Signature: Shikina Voight

Date: 9/20/2020

WISENBAKER BATHROOM VANITY SINKS & EDGES

MIRADO UNDERMOUNT VANITY BOWL SINK #519

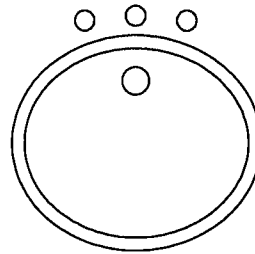
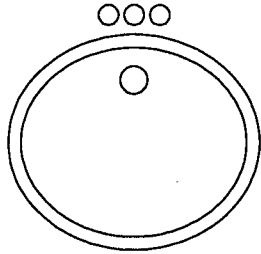

4" STRAIGHT SPREAD

8" CURVED SPREAD

BISCUIT

WHITE

MIRADO UNDERMOUNT VANITY RECTANGULAR SINK #2115 OR #A2113

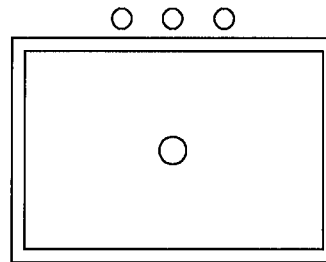
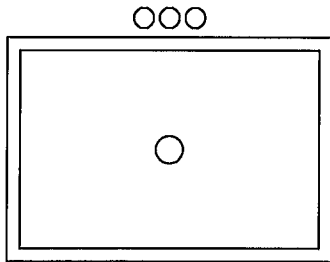

*#2113 SMALL BOWL
*#2115 LARGE BOWL

4" STRAIGHT SPREAD

8" STRAIGHT SPREAD

BISCUIT

WHITE

STANDARD COUNTERTOP EDGE

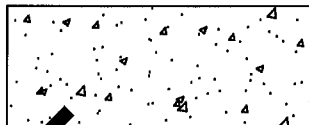

SQUARE

UPGRADED COUNTERTOP EDGES



SINGLE BEVEL



BULLNOSE

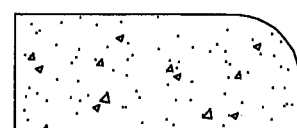

WATERFALL



CLASSIC



OGEE



TRIPLE PENCIL

AJ 03.18.16

ADDRESS: 651 ARROYO SIERRA

DocuSigned by:

PLAN: 1992W

SIGNATURE: ARROYO VERDE 45

Shikimahi Voight

DATE: 9/20/2020

STANDARD SHOWER DETAILS

<p><input type="checkbox"/> A</p> <p>AVAILABLE WITH 12x12, 13x13, 16x16, 18x18, 20x20</p> <p>12x12 SHOWN</p>	<p><input type="checkbox"/> B</p> <p>AVAILABLE WITH 10x20, 12x24, 16x24</p> <p>16x24 SHOWN</p>	<p><input type="checkbox"/> C</p> <p>AVAILABLE WITH 10x20, 12x24, 16x24</p> <p>16x24 SHOWN</p>
<p><input type="checkbox"/> D</p> <p>AVAILABLE WITH 12x12, 13x13, 16x16, 18x18, 20x20</p> <p>12x12 SHOWN 1/2 OFFSET</p> <p>NOTE: 20" AND LARGER TILES MUST BE INSTALLED WITH A 1/3 OFFSET.</p>	<p><input checked="" type="checkbox"/> E</p> <p>AVAILABLE WITH 10x20, 12x24, 16x24</p> <p>16x24 SHOWN 1/3 OFFSET</p> <p>NOTE: 20" AND LARGER TILES MUST BE INSTALLED WITH A 1/3 OFFSET.</p>	<p><input type="checkbox"/> F</p> <p>AVAILABLE WITH 10x20, 12x24, 16x24</p> <p>16x24 SHOWN 1/3 OFFSET</p> <p>NOTE: 20" AND LARGER TILES MUST BE INSTALLED WITH A 1/3 OFFSET.</p>
<p><input type="checkbox"/> G</p> <p>AVAILABLE WITH 12x12, 13x13, 16x16, 18x18, 20x20</p> <p>2" CUT TILE BORDER 12x12 SHOWN</p>	<p><input type="checkbox"/> H</p> <p>AVAILABLE WITH 12x12, 13x13, 16x16, 18x18, 20x20</p> <p>2" CUT TILE BORDER 12x12 SHOWN</p>	<p><input type="checkbox"/> J</p> <p>AVAILABLE WITH 12x12, 13x13, 16x16, 18x18, 20x20</p> <p>12x12 SHOWN</p> <p>NOTE: 20" AND LARGER TILES MUST BE INSTALLED WITH A 1/3 OFFSET.</p>
<p><input type="checkbox"/> K</p> <p>AVAILABLE WITH 12x12, 13x13, 16x16, 18x18, 20x20</p> <p>12x12 SHOWN</p>	<p><input type="checkbox"/> L</p> <p>AVAILABLE WITH 12x12, 13x13, 16x16, 18x18, 20x20</p> <p>12x12 SHOWN</p>	

ROOM LOCATION:	MASTER		
TILE SURROUND:	DT Concrete Grey 12x24		
GROUT:	LAT #7.8 Sterling Silver		
SHOWER FLOOR TILE:	M2 Mosaic Chair Ash 2x4		
ADDRESS:	651 ARROYO SIERRA	DocuSigned by:	PLAN: 1992W
SIGNATURE:	ARROYO VERDE 45	Shikinali Vohit	DATE: 9/20/2020

Drawings are representations only and may not match the installation based on materials selected.

STANDARD MASTER BATH TUB TILE DETAIL

A NOT AVAILABLE ON CURVED TUB SKIRT

10" SPLASH FIELD TILE (13x13 SHOWN)
SKIRT

AVAILABLE WITH
12x12, 13x13, 16x16,
18x18, 20x20

B NOT AVAILABLE ON CURVED TUB SKIRT

10" SPLASH FIELD TILE (18x18 SHOWN)
SKIRT

AVAILABLE WITH
12x12, 13x13, 16x16,
18x18, 20x20

C NOT AVAILABLE ON CURVED TUB SKIRT

10" SPLASH FIELD TILE (12x24 SHOWN)
SKIRT

AVAILABLE WITH
10x20, 12x24, 16x24

D NOT AVAILABLE ON CURVED TUB SKIRT

10" SPLASH FIELD TILE (13x13 SHOWN) w/ 1/2 OFFSET
SKIRT

AVAILABLE WITH
12x12, 13x13

E NOT AVAILABLE ON CURVED TUB SKIRT

10" SPLASH FIELD TILE (12x24 SHOWN) w/ 1/3 OFFSET
SKIRT

AVAILABLE WITH
10x20, 12x24, 16x24,
20x20

NOTE: 20" AND LARGER TILES MUST BE
INSTALLED WITH A 1/3 OFFSET.

F NOT AVAILABLE ON CURVED TUB SKIRT

10" SPLASH FIELD TILE (18x18 SHOWN) w/ 1/2 OFFSET
SKIRT

AVAILABLE WITH
16x16, 18x18

ACCENT MESH

HORIZONTAL VERTICAL
(Mesh Pieces No Larger Than 2" In Width)

10" SPLASH CONTINUE MESH ONTO WINDOWSILL
SKIRT

AVAILABLE ON
CURVED TUB SPLASH

ACCENT MESH

HORIZONTAL VERTICAL
(Mesh Pieces No Larger Than 2" In Width)

SKIRT

AVAILABLE ON
CURVED TUB SKIRT

ROOM LOCATION: **MASTER**

TILE SURROUND: **DT Concrete Gray 12x24**

GROUT: **LAT #178 Sterling Silver**

ADDRESS: **651 ARROYO SIERRA** DocuSigned by: **1992W**

SIGNATURE: **ARROYO VERDE 45** *Shikinali Wright* 9/20/2020

7228DA41787A49A...

Drawings are representations only and may not match the installation based on materials selected.

STANDARD HALL TUB DETAILS

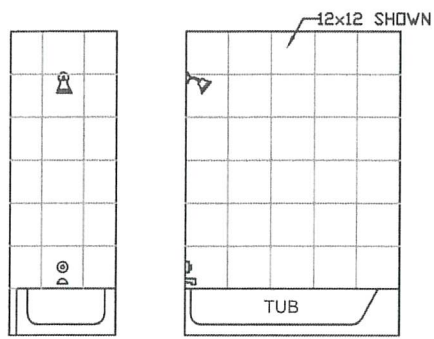
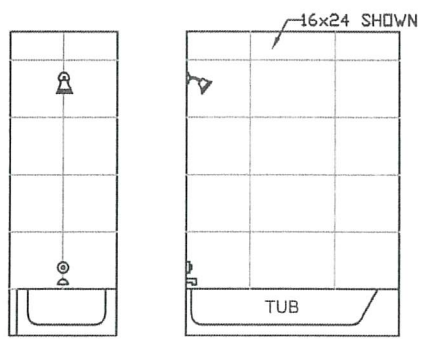
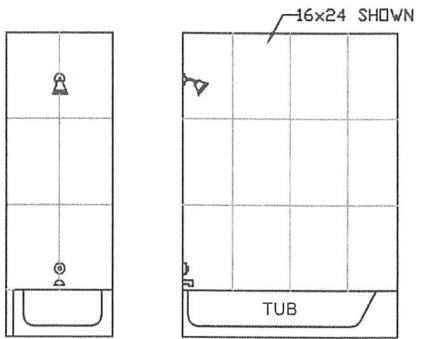
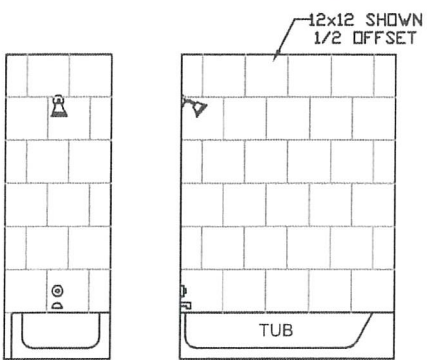
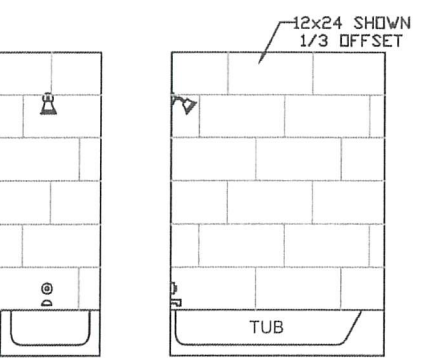
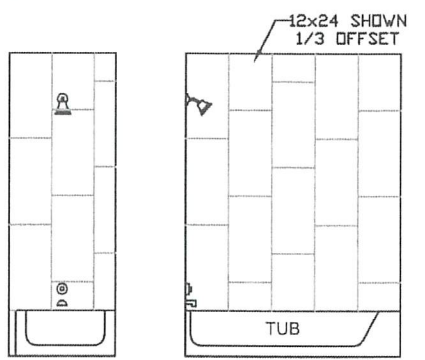
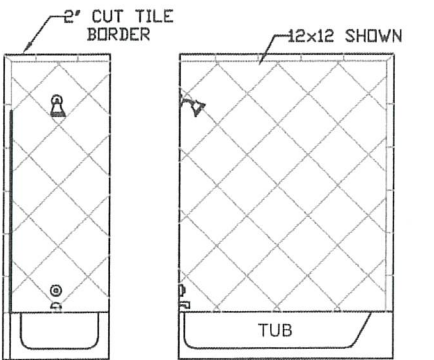
<p><input type="checkbox"/> A</p> <p>AVAILABLE WITH 12x12, 13x13, 16x16, 18x18, 20x20</p> 	<p><input type="checkbox"/> B</p> <p>AVAILABLE WITH 10x20, 12x24, 16x24</p> 	<p><input checked="" type="checkbox"/> C</p> <p>AVAILABLE WITH 10x20, 12x24, 16x24</p> 
<p><input type="checkbox"/> D</p> <p>AVAILABLE WITH 12x12, 13x13, 16x16, 18x18, 20x20</p>  <p>NOTE: 20" AND LARGER TILES MUST BE INSTALLED WITH A 1/3 OFFSET.</p>	<p><input checked="" type="checkbox"/> E</p> <p>AVAILABLE WITH 10x20, 12x24, 16x24</p>  <p>NOTE: 20" AND LARGER TILES MUST BE INSTALLED WITH A 1/3 OFFSET.</p>	<p><input type="checkbox"/> F</p> <p>AVAILABLE WITH 10x20, 12x24, 16x24</p>  <p>NOTE: 20" AND LARGER TILES MUST BE INSTALLED WITH A 1/3 OFFSET.</p>
<p><input type="checkbox"/> G</p> <p>AVAILABLE WITH 12x12, 13x13, 16x16, 18x18, 20x20</p> 		

ROOM LOCATION:	BATH #2		
TILE SURROUND:	DT Concrete Grey 12x24		
GROUT:	LAT #18 Sterling Silver		
ADDRESS:	651 ARROYO SIERRA	DocuSigned by:	PLAN: 1992W
SIGNATURE:	ARROYO VERDE 45	<i>Shikinali Voigt</i>	DATE: 9/20/2020

Drawings are representations only and may not match the installation based on materials selected.
 7228DA41787A49A
 YC - 1/8/2018

UPGRADE LEVEL 1 FLOOR PATTERNS

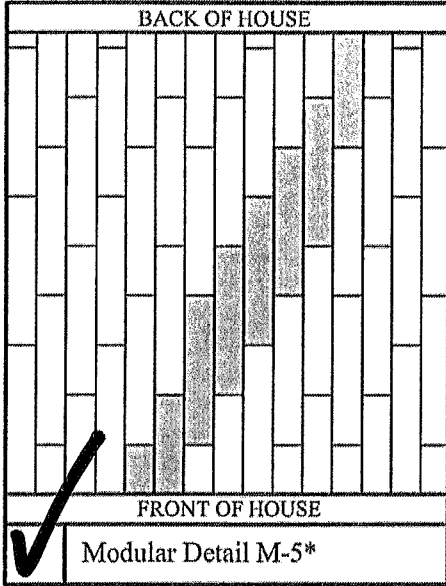

ALL PLANK SIZES
INSTALL AT
1/3 OFFSET

Modular Detail M-5*

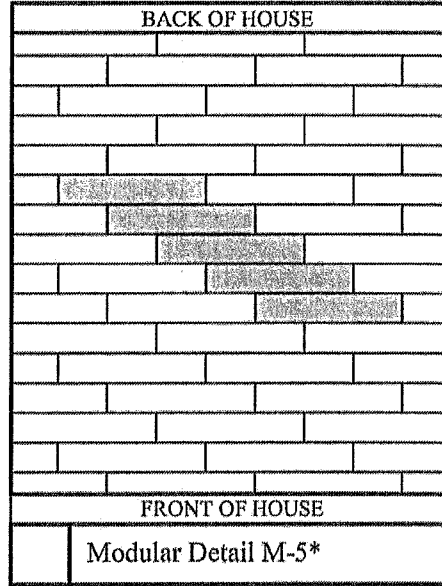

ALL PLANK SIZES
INSTALL AT
1/3 OFFSET

Modular Detail M-5*

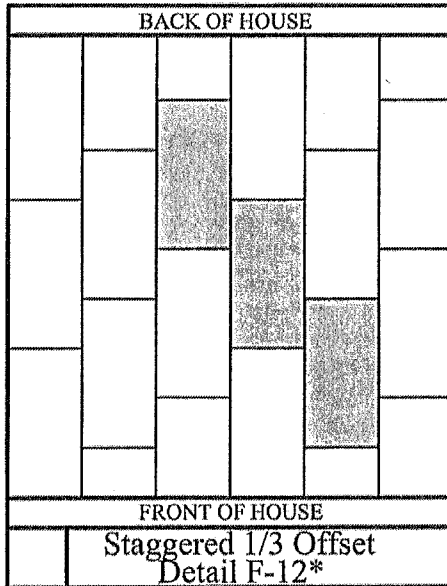

12"x24"
16"x24"
Install at 1/3 offset

Staggered 1/3 Offset
Detail F-12*

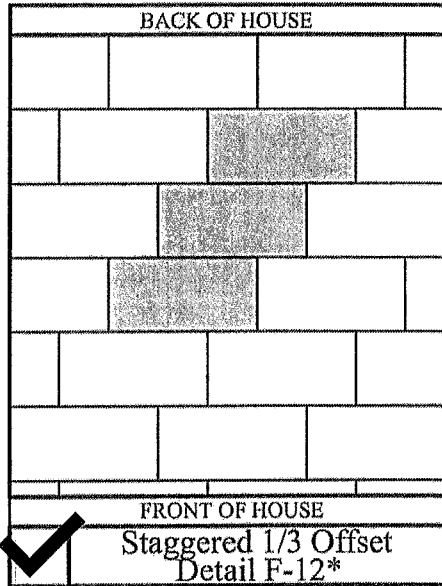

12"x24"
16"x24"
Install at 1/3 offset

Staggered 1/3 Offset
Detail F-12*

NOTES:

1. THE ABOVE FLOORING PATTERNS WILL BEGIN IN THE CORNER OF THE DESIGNATED ROOM, BASED ON THE BEST STARTING LOCATION DETERMINED BY THE TILE SETTER.
2. THE PATTERN WILL BE CONTAINED WITHIN THE STANDARD FLOOR BREAK AREAS NOTED ON THE PLAN.

* The above drawings are a graphic representation only, and may not reflect actual grout lines in the field.

COMMUNITY: ARROYO VERDE 45

ADDRESS: 651 ARROYO SIERRA

PLAN #: 1099W DATE: 9/20/2020

SIGNATURE: Shikinal Voigt
7228DA41787A49A...

INTERIOR DOOR STYLES

ARCH 2-PANEL
(IDARC)

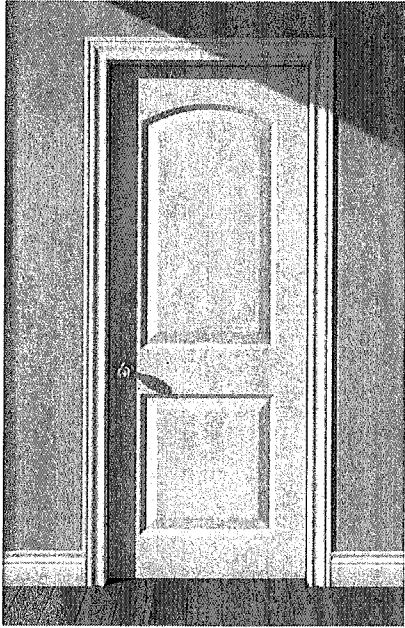

SQUARE 2-PANEL
(IDSQR)

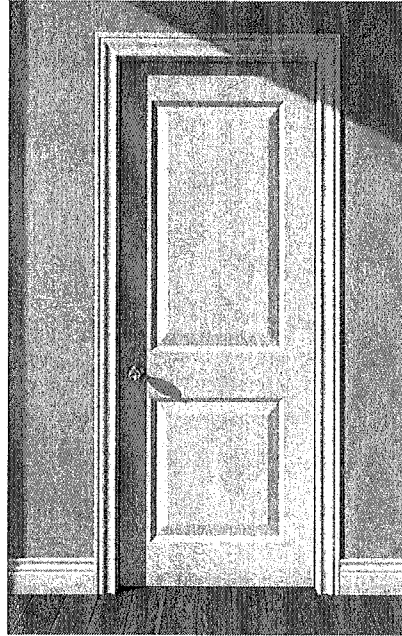

HORIZONTAL 5-PANEL
(IDHRZ)

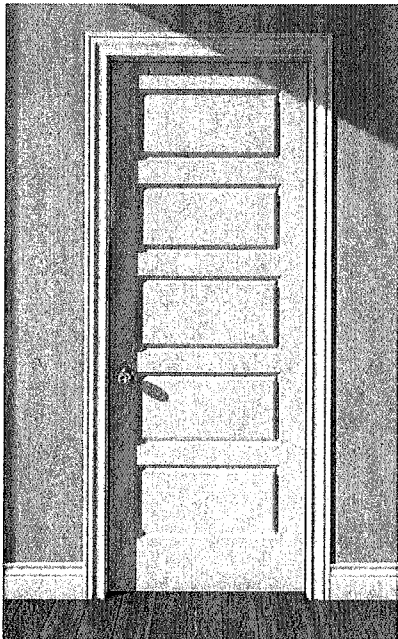

HORIZONTAL 6-PANEL
(IDHRZ)*

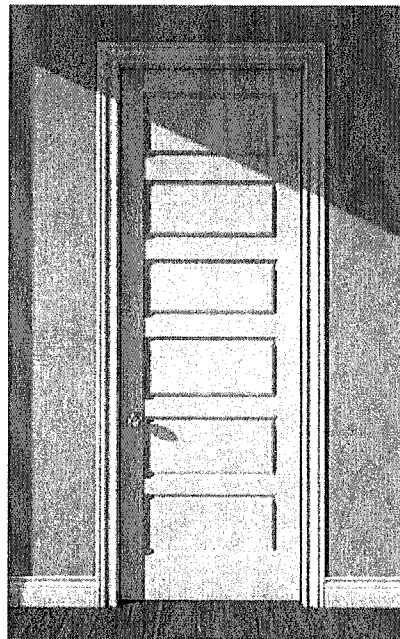

Do not use for first floor only, (INTDR) required

ADDRESS: 651 ARROYO SIERRA

SIGNATURE: ARROYO VERDE 45

Shikimahi Voight

PLAN: 1992W

DATE: 9/20/2020

7228DA41787A49A

Drawings are representations only and may not match the completed installation based on materials selected.

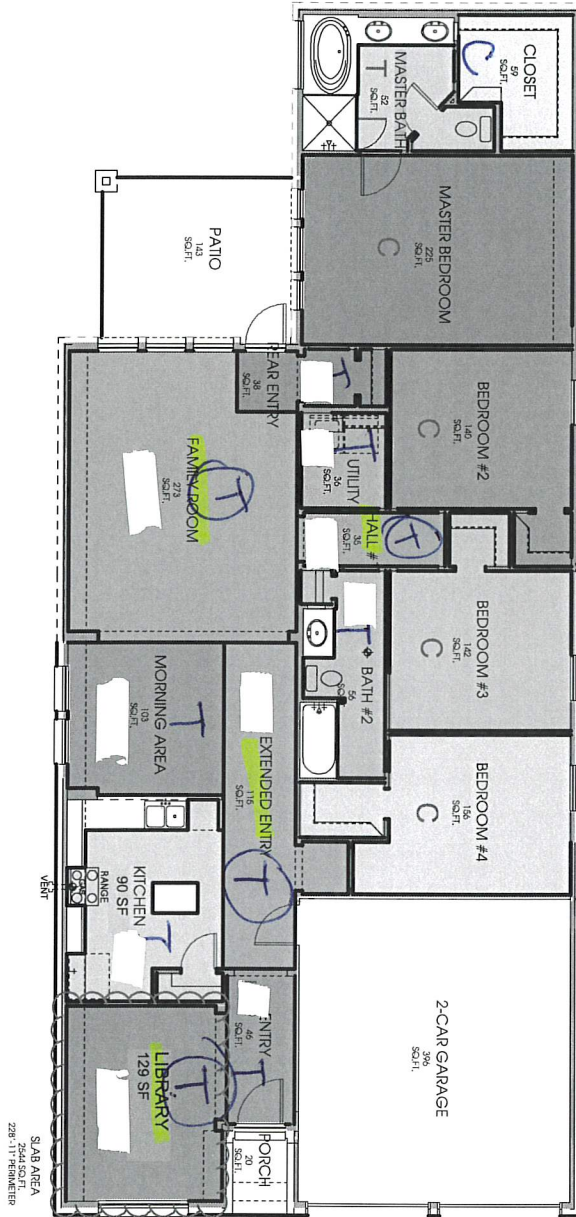

DS
NS

PLAN NO. 1992W
 SKETCH NO. 8.2.05
 DATE: 01/06/19
 DESIGNED BY: TCO
 APPROVED BY: [Signature]

FLOOR FINISHES ©
 E-2

SQUARE FOOTAGE:
 FIRST FLOOR: _____
 SECOND FLOOR: _____
 THIRD FLOOR: _____
 TOTAL: _____

PERRY HOMES™
 © · 2019 · PERRY HOMES™
 P.O. BOX 34396 HOUSTON, TEXAS 77234



THIS DRAWING NOT TO BE USED FOR CONSTRUCTION UNLESS SIGNATURE IS SHOWN ABOVE

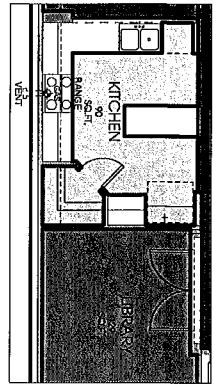

OPTIONAL HOME OFFICE
1/8" = 1'-0"

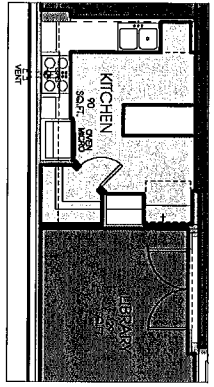

OPTIONAL HOME OFFICE W/UPGRADE KITCHEN
1/8" = 1'-0"

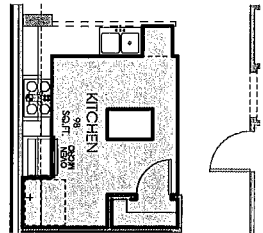

OPTIONAL UPGRADE KITCHEN
1/8" = 1'-0"

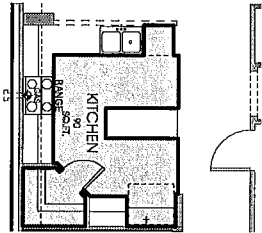

OPTIONAL ALTERNATE KITCHEN
1/8" = 1'-0"

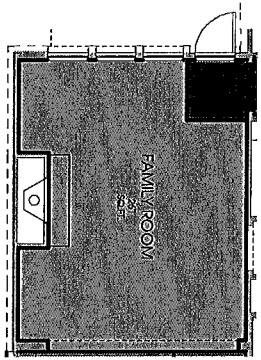

OPTIONAL FIREPLACE
1/8" = 1'-0"

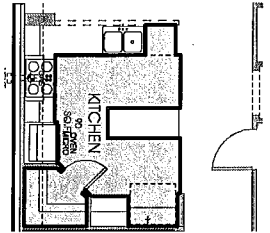

OPTIONAL ALTERNATE UPGRADE KITCHEN
1/8" = 1'-0"

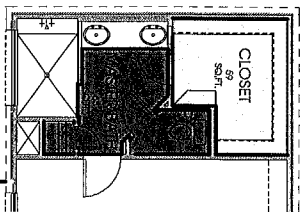

ALTERNATE MASTER BATH
1/8" = 1'-0"

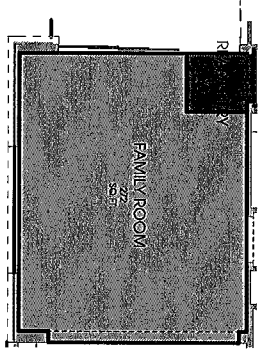

OPTIONAL SLIDING DOOR
1/8" = 1'-0"

DS
SV

PLAN No: 1992W
DATE: 04/13/11
SHEET No: 6.2
DESIGNED BY: [Signature]
DRAWN BY: [Signature]

FLOOR FINISHES

SQUARE FOOTAGE:
FIRST FLOOR: _____
SECOND FLOOR: _____
THIRD FLOOR: _____
TOTAL: _____

PERRY HOMES™
© 2010 PERRY HOMES™
P.O. BOX 34300 HOUSTON, TEXAS 77234



THIS DRAWING NOT TO BE USED FOR ANY RECONSTRUCTION OR CONSTRUCTION UNLESS SIGNATURE IS SHOWN ABOVE

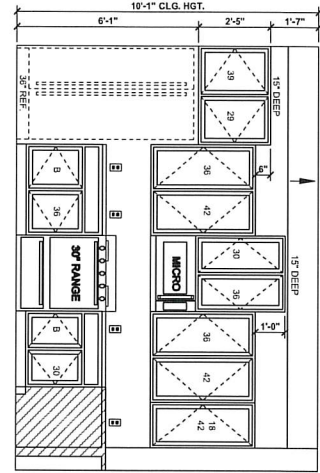

A KITCHEN
1/4" = 1'-0"

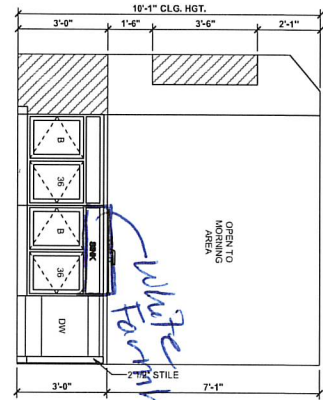

B KITCHEN
1/4" = 1'-0"

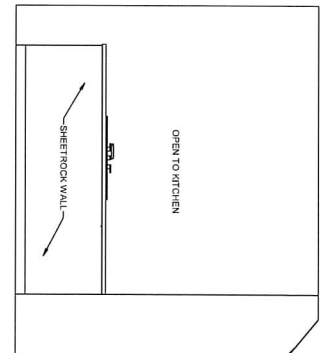

B1 KITCHEN
1/4" = 1'-0"

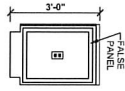

C ISLAND
1/4" = 1'-0"



D ISLAND
1/4" = 1'-0"

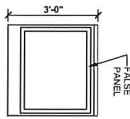

E ISLAND
1/4" = 1'-0"

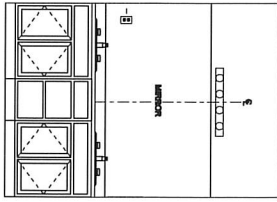

F MASTER BATH
1/4" = 1'-0"

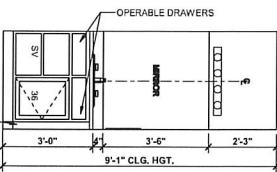

G BATH #2
1/4" = 1'-0"

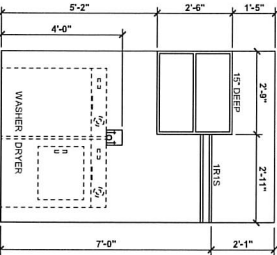

H UTILITY
1/4" = 1'-0"

DS
NS

*What is the
Floor Sink*

NOTE: ACTUAL CABINET SIZES
MAY VARY DEPENDING ON
MATERIAL & FIELD CONDITIONS

DATE: 01/06/19
DRAWN BY: SJC
REVISIONS:
1992W
5.1

INTERIOR
ELEVATIONS

SQUARE FOOTAGE:
FIRST FLOOR: _____
SECOND FLOOR: _____
THIRD FLOOR: _____
TOTAL: _____

PERRY HOMES™
© 2019 · PERRY HOMES™
P.O. BOX 34306 HOUSTON, TEXAS 77234



02/22/2019 9:33:33 AM

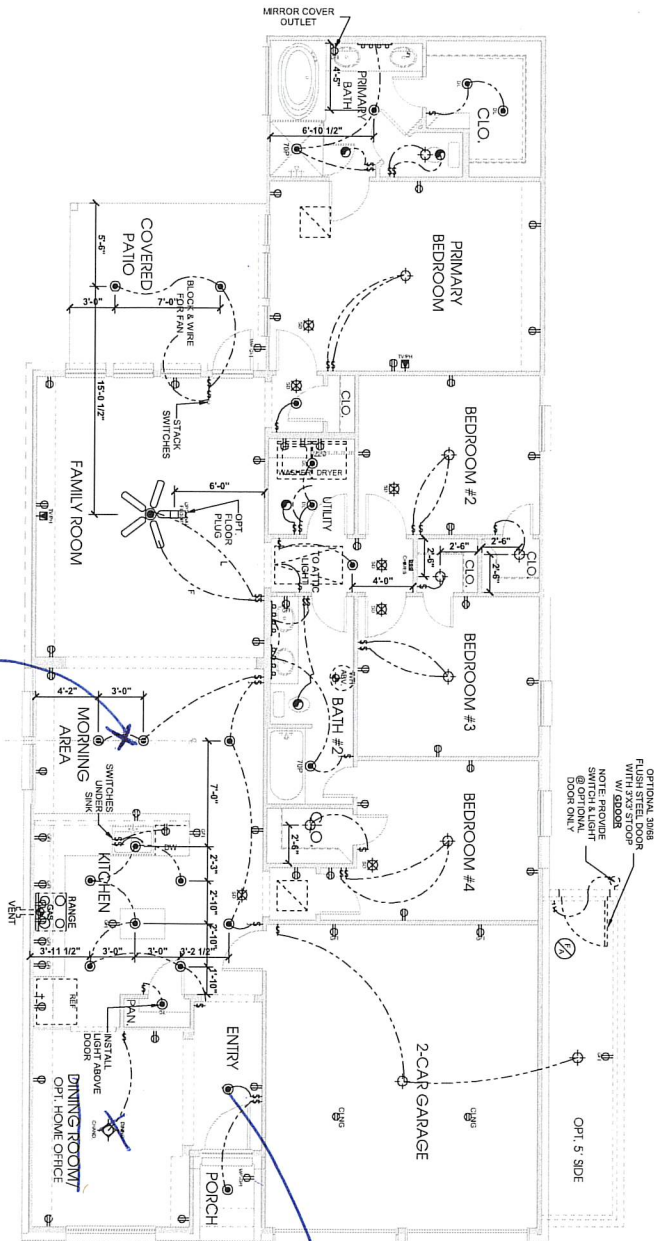

DS
NS

CHD 5/14

CHD 5/14

PLAN NO. 1992W
 SHEET NO. 8.2.02
 DATE: 03.06.13
 DESIGNED BY: CD
 DRAWN BY: VAS

**FIRST FLOOR
 ELECTRICAL @ E-2**

SQUARE FOOTAGE:
 FIRST FLOOR _____
 SECOND FLOOR _____
 THIRD FLOOR _____
 TOTAL _____

PERRY HOMES™
 © - 2019 - PERRY HOMES™
 P.O. BOX 34306 HOUSTON, TEXAS 77234

THIS DRAWING NOT TO BE USED FOR PERMITS, REVISIONS, OR CONSTRUCTION UNLESS SIGNATURE IS SHOWN ABOVE.
 REGISTERED ARCHITECT
 CHARLES C. PERRY
 8938
 STATE OF TEXAS

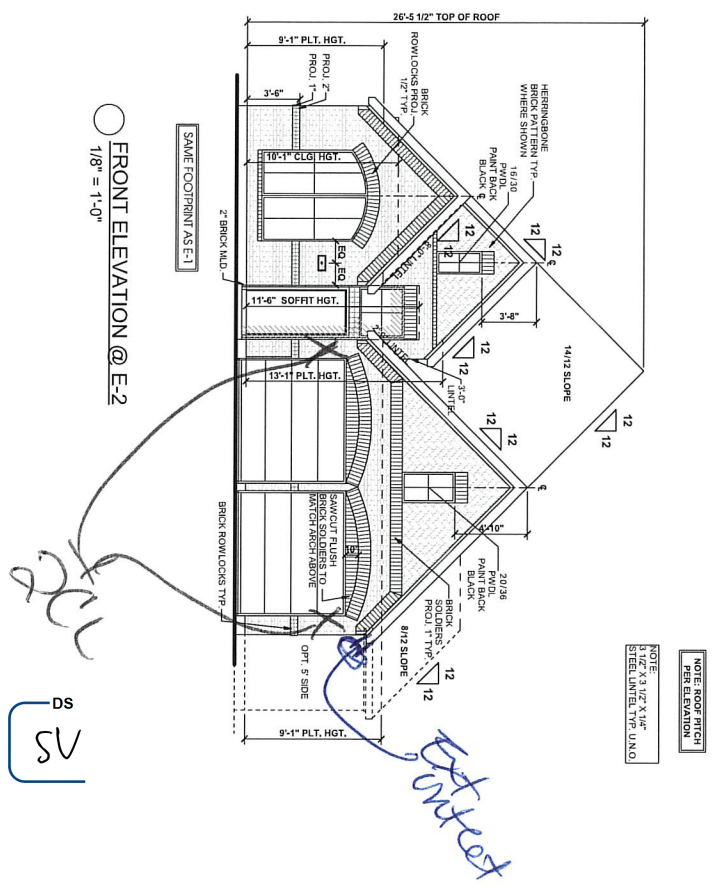

○ FRONT ELEVATION @ E-2
1/8" = 1'-0"

SCALE FOOTPRINT AS E-1

INTERIOR FINISH PER ELEVATION

NOTE:
1/2" X 3/4" X 1/4"
STEEL LINTEL TYP. U.N.O.

DS
SV

SQUARE FOOTAGE:
FIRST FLOOR: _____
SECOND FLOOR: _____
THIRD FLOOR: _____
TOTAL: _____

PERRY HOMES™
© - 2019 - PERRY HOMES™
P.O. BOX 34396 HOUSTON, TEXAS 77234



PLAN NO. 1992W
DATE: 08-06-19
DRAWN BY: JCD
CHECKED BY: JCD
8.2.00

FRONT ELEVATION @
E-2

THIS DRAWING NOT TO BE USED FOR REVISIONS, PERMITTING OR CONTRACTING WITHOUT THE SIGNATURE OF THE ARCHITECT.

08/06/2019 11:51:53 AM

R2020_8-31

BE INFORMED

Know Your OmegaStone™ Countertop

Congratulations on choosing OmegaStone™ for your new countertop. OmegaStone™ combines natural quartz with man-made materials, creating a unique countertop surface. With the correct care and maintenance, you can expect high quality performance out of your OmegaStone™ countertop material. Countertops will not be replaced due to any inherent characteristics listed below. Please initial each item and sign at the bottom.

Like quarried stone, OmegaStone™ has particulate concentrations and color variations. These concentrations and color variations are natural and add to the unique character of OmegaStone™. DS
SV

The perception of color, texture, patterns, etc. in a smaller sample may be different when the entire application is completed. For example, the color may be more or less intense, the particulate concentrations more or less pronounced, and the shading more or less obvious. Manufacturers discontinue colors from time to time. If this occurs, you will be notified so you may select another color. DS
SV

A transparency sheet was used in a demonstration during your selection process to serve as an example of the possible variation in grain, pattern, color and shading that could exist between OmegaStone™ pieces in your kitchen and throughout your home. Your initials indicate acknowledgement of this demonstration. DS
SV

Like quarried stone, it is impossible to do a seamless or a seemingly seamless installation of OmegaStone™. OmegaStone™ countertop seams and lamination lines are visible and can be felt. Countertop seams will be flush +/- 1/32" (the thickness of a credit card). Textured OmegaStone™ surfaces will have a much higher degree of deviation along the seams due to the designed unevenness of the material. Many colors have significant variety between pieces within a room, such that individual pieces within a room will vary in shading, coloring and pattern from each other. Please note that patterns and shading variation at seams locations will show more in this application due to the seaming of two pieces of countertop material coming together. The countertops or areas of the countertops will not be replaced due to these variations within or between the pieces of your installation. DS
SV

The size of a piece of OmegaStone™ is typically 118" x 54", so measurements which exceed these dimensions will always have a seam, and measurements of smaller dimensions might also have a seam. Seam location will vary house to house and homes of the same floor plan might not have the seams in the same location. Seam location will not be reviewed or confirmed. Large countertop areas, such as an island, will potentially have more seams than quarried stones due to its size limitations. DS
SV

To clean OmegaStone™, a damp cloth is usually all you need. To clean up sticky spots, a little liquid detergent can help. As with any countertop, it makes sense to clean up spills as soon as you can. DS
SV

To remove stubborn or dried spills we recommend using Bar Keeper's Friend, Formula 409, Greased Lightning, or Lysol. For very stubborn spills, a white scrub pad such as Scotch-Brite can be used without damaging your countertop. DS
SV

Avoid abrasive cleansers containing high alkaline/ph levels. Liquid bluing, nail polish remover and oil soaps also can damage your OmegaStone™ countertop. Avoid using chemicals which contain methylene chloride or trichlorethane, such as paint remover or furniture strippers. Also avoid highly acidic cleaners and food contact with your countertop, as it can cause the surface to etch. DS
SV

Do not use your counter surface as a cutting board. DS

OmegaStone™ is produced for interior applications only. SV

Overhangs in the excess of 12" require corbels, posts, or other supports to be installed by the builder. DS
SV

Dark colors require more maintenance than lighter colors. Finger prints, cleaning streaks, dried water spots, surface finish variations, etc., are more visible than on other colors. This is normal for dark colors, it is not a defect and cannot be changed. DS
SV

651 Arroyo Sierra - Arroyo Verde
Address and community where selections will be installed

DocuSigned by:
Shikinali Voight
Homeowner Signature

9/20/2020
Date

[Signature]
Design Consultant Signature

9/20/20
Date

R2020_9-1

BE INFORMED

Marlana Engineered Marble - Bathroom Countertop Applications

Congratulations on choosing Marlana Engineered Marble for your new countertops. Before you finalize your decision, please read this document to become more familiar with the characteristics of this product. Countertops will not be replaced due to any inherent characteristic listed below. Please initial each item and sign at the bottom.

Marlana Engineered Marble is comprised mainly of natural marble. Marble is a calcareous stone and is acid sensitive. Calcareous stones are readily dissolved in acid; therefore acidic products, such as lemon or tomato juice should not be used on marbles. Additionally, take care not to leave contact solution, toothpaste, acne medications, make up removers, nail polish removers and on the stone. These substances may cause the stone to etch - the surface finish will dull and change texture. DS
SV

The perception of color, texture, patterns, etc. in a smaller sample may be different when the entire application is completed. For example, the color may be more or less intense, the particulate concentrations more or less pronounced, and the shading more or less obvious. DS
SV

A transparency sheet was used in a demonstration during your selection process to serve as an example of the possible variation in grain, pattern, color and shading that could exist between Marlana pieces in your home. Your initials indicate acknowledgement of this demonstration. DS
SV

To clean Marlana Engineered Marble, a damp cloth is usually all you need. To clean sticky, stubborn spots or residue, a little neutral pH cleaner can help. Dish soap and water, a 50-50 mix of alcohol and water or spray on cleaners, such as Ammonia-Free Windex, will work well. DS
SV

Avoid abrasive cleaners containing high alkaline/pH levels and highly acidic or low pH chemicals. Always avoid using chemicals which contain methylene chloride or trichlorethane, such as paint remover or furniture strippers. As with any surface, it is always best to clean up any spills and residue as soon as you can. DS
SV

Like quarried stone, Marlana Engineered Marble seams are visible and can be felt. While the maximum size of a piece of Marlana Engineered Marble is 62"x95", seam placements will vary and runs are NOT guaranteed to be full sheets. When a filler piece is used, for any reason, the filler piece will be no smaller than 3" wide. The overall thickness of the Marlana material is 5/8" thick with a +/- 1/16" variance, please keep this in mind when selecting the finished edge treatment of your Marlana countertop. DS
SV

To accomplish radius applications such as tub skirts, tub splashes, etc. VERTICAL strips will be installed approximately 4" wide, beveled to allow us to make the radius. DS
SV

Marlana Engineered Marble does have the potential to burn, so hot electrical devices commonly used in the bathroom (i.e., curling irons, etc.) should not be set directly on Marlana countertops. DS
SV

Marlana Engineered Marble is sealed with a penetrating sealer to help prevent the absorption of stains into the stone. Due to the high marble content in Marlana Engineered Marble, it is very important that significant care should be taken to keep the surface both stain and etch free. It is recommended that all surfaces be resealed on a yearly basis. DS
SV

651 Arroyo Sierra - Arroyo Verde
Address and community where selections will be installed

DocuSigned by:

Shikilah Voight
Homebuyer Signature

9/20/2020
Date

[Signature]
Design Consultant Signature

9/20/20
Date

but not

variation in
or a non-
l on the

color and
ary. For
ferent in

ferences
onse, the
ly, grout

to time.
c. If this

REV 7.11.2016

Be Informed Know Your Carpet

Carpet is one of the most widely used floor coverings in the country, and for good reason. It is beautiful, durable, and available in many different textures, types, and colors. As with all floor coverings, there are characteristics of carpet that you need to know. While most Wisenbaker carpets have stain protectors, no carpet is stain proof.

^{DS} SV Seams will be visible. Seams will be more visible in a lighter colored carpet than in a darker one.
^{DS} Seams will be more visible in shorter pile heights than in longer pile heights.

^{DS} SV All carpet shows tracks. We offer some textured carpets that track "less", but not "track proof".

^{DS} SV Colors and shades do vary from one dye lot to another.

^{DS} SV Some carpet styles will shed after installation for a period of time. This "fuzz" is normal.

^{DS} SV Use an upright vacuum cleaner for routine cleaning. (at least twice a week under normal use).

^{DS} SV Hot water extraction (steam cleaning) is the industry preferred method of professional cleaning.

^{DS} SV Insist on truck mounted equipment.

^{DS} SV Application of **stain resist chemical** offered by in home cleaning companies WILL void any stain resist warranties.

^{DS} SV The industry has established realistic guidelines for tolerance levels. Please understand that the samples from which you are selecting are representative of, but not necessarily exactly what will be installed in your home.

^{DS} SV Please be aware that when seaming two different types of carpets together seams will be accentuated due to the seaming together of two types of colors, patterns and pile heights.

^{DS} SV The perception of color, texture, patterns etc. in a smaller sample may be different when the entire application is completed. For example, the color may be more or less intense, the texture more or less pronounced, and shading more or less obvious. Manufacturers discontinue colors and patterns from time to time. If this occurs, you will be notified that a reselection is required.

Refer to www.Wisenbaker.com for additional information.

651 Arroyo Seco - Arroyo Verde
Address and community where selections will be installed

^{DS} SV Shikinali Voight 9/20/2020
Homebuyer Signature Date

[Signature] 9/20/20
Design Consultant Signature Date