

12

- NOTES:
- SUBJECT TO APPLICABLE RESTRICTIVE COVENANTS LISTED IN ITEM NO. 1, SCHEDULE "B" OF TITLE COMMITMENT ISSUED BY TRADITION TITLE COMPANY UNDER GF NO. 11-50001999.
 - SURVEYOR HAS NOT ABSTRACTED SUBJECT PROPERTY. ABSTRACTING BY TITLE COMPANY ONLY. THERE MAY BE ADDITIONAL EASEMENTS, BUILDING LINES AND OTHER MATTERS OF RECORD NOT SHOWN HEREON.
 - SUBJECT TO AGREEMENT FOR ELECTRIC SERVICE PER H.C.C.F. NO. F189779.
 - SUBJECT TO BUILDING LINE RESTRICTIONS PER H.C.C.F. NO. F253600.
 - ONE STORY FRAME GARAGE IS OVER THE 3' BUILDING LINE AS SHOWN.
- IF CONSTRUCTION UPON OR A DIVISION OF SUBJECT TRACT IS PROPOSED AND IF TRACT LIES IN THE CITY OF HOUSTON OR ITS EXTRATERRITORIAL JURISDICTION, PLATTING AND OTHER REQUIREMENTS MAY APPLY PER CITY OF HOUSTON ORDINANCES.
 - BEARINGS SHOWN ARE BASED ON THE RECORDED PLAT.

LEGEND

- ELECTRIC BOX
- PROPERTY CORNER
- WOOD FENCE
- CHAINLINK FENCE



SUBJECT PROPERTY IS NOT LOCATED IN A FEDERAL INSURANCE ADMINISTRATION DESIGNATED FLOOD HAZARD AREA. LOCATED IN ZONE "X", AS PER MAP 48201C0615L, DATED: 6-18-07. THIS INFORMATION IS BASED ON GRAPHIC PLOTTING ONLY. WE DO NOT ASSUME RESPONSIBILITY FOR EXACT DETERMINATION.

LOT 11		SUBDIVISION NOTTINGHAM COUNTRY	
BLOCK 12	SECTION 4	RECORDATION VOL. 234, PG. 62, H.C.M.R.	
COUNTY HARRIS	STATE TEXAS	I HEREBY CERTIFY THAT THIS PLAT REPRESENTS THE RESULTS OF A SURVEY MADE ON THE GROUND ON THE 9th DAY OF SEPTEMBER, 2011.	

LENDER Co.	INTEGRITY MORTGAGE CORPORATION OF TEXAS
TITLE Co.	TRADITION TITLE COMPANY
PURCHASER	JASON L. EASTERLING
	LESLIE A. EASTERLING
ADDRESS	1146 DOMINION DRIVE
	KATY, TEXAS

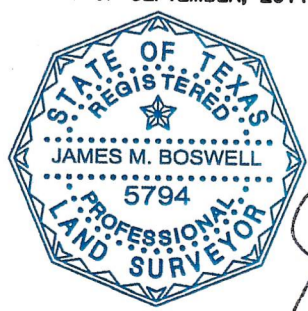

TEL. (713) 722-7541 FAX (713) 722-7613

JOB No.	11-24333	
G.F. No.	11-50001999	
FIELD WORK	09-09-11	RG
DRAFTED BY	09-12-11	WJ
CHECKED BY	09-12-11	JB
KEY MAP	486F	
REVISION	-	

MERIDIAN SURVEYING & MAPPING
 1080 W. SAM HOUSTON PKWY., N., STE. 113
 HOUSTON, TEXAS 77043
 COPYRIGHT 2011 MERIDIAN SURVEYING & MAPPING. ALL RIGHTS RESERVED.