

RATION TYPE
 T 21 11,900
 T 21 11,900

Olshan

Since 1933
Foundation Repair

NAME DANA HAYWARD
 ADD. 401 PECAN ST.
TOWNE 75860
 TEL 234-739-2019
 WKTEL _____
 DATE 11/05 MAP # _____

LEGEND

TERIOR PE POOL EQUIPMENT
 TERIOR G GAS LINE
 JILDERS PIERS -- FENCE
 REVIOUS WORK -- WALL CRACKS

[A/C] A/C UNIT
 SLOPE
 8 CLEAN OUT

1 STORY
 BRICK
 GRADE BEAM DEPTH

4 BREAK-OUTS
 CRAWL / CONV
 P&B / B&B

BUILDING DESCRIPTION

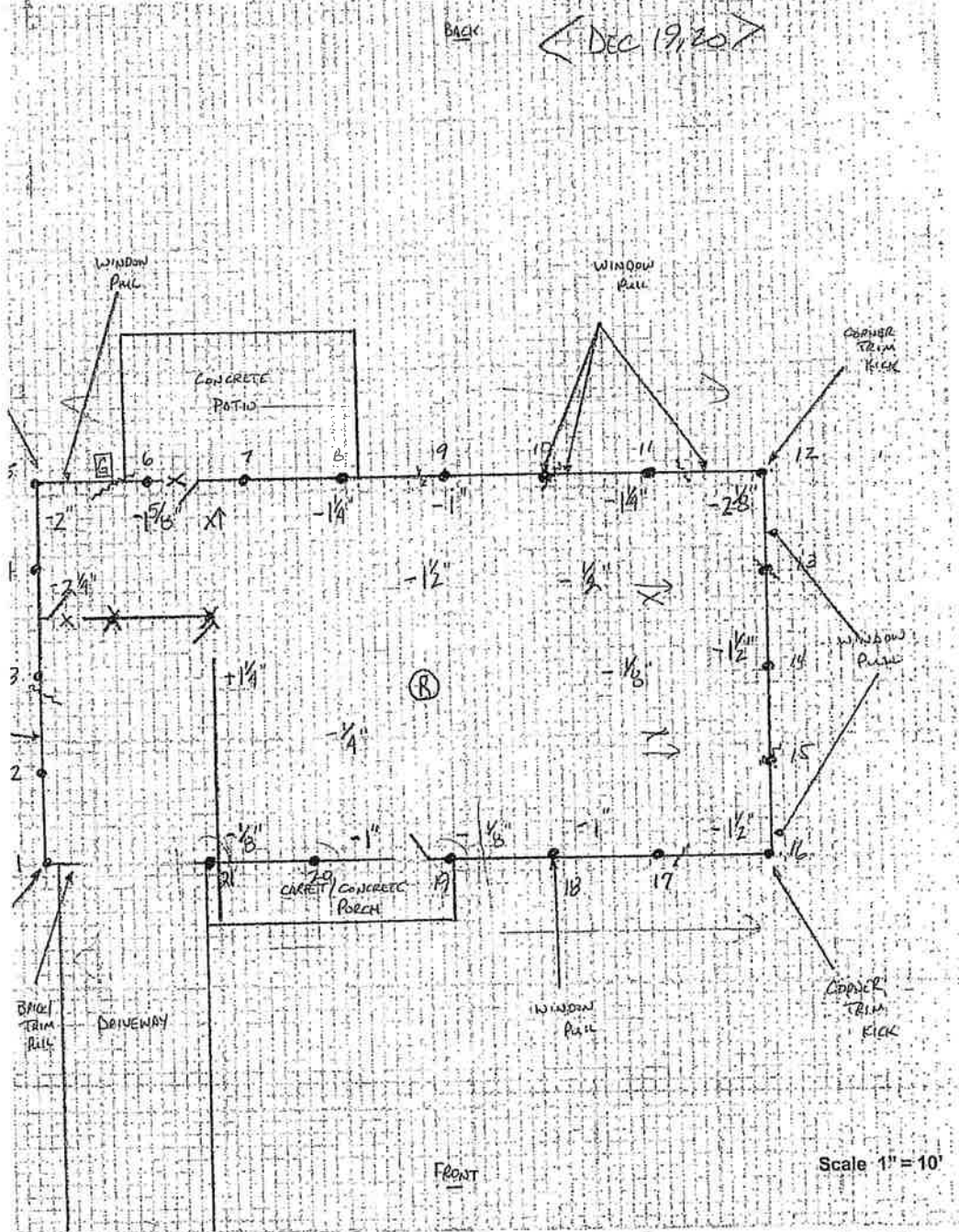

- | | | | | | | | |
|--|---|---|---|--|---|---|---|
| ata, GA
653-1000
In, TX
342-2141
more, MD
267-1222
n Rouge, LA
927-9377
mont, TX
838-5300
Ingham, AL
871-8780 | Cincinnati, OH
(513) 621-2221
Colo. Springs, CO
(719) 447-0400
Columbus, GA
(706) 889-3090
Columbus, OH
(614) 224-4100
Dallas, TX
(972) 238-1600
Dayton, OH
(937) 222-2600 | Denver, CO
(303) 467-1933
Evansville, IN
(812) 424-0400
Fort Smith, AR
(479) 849-8900
Houston, TX
(713) 223-1900
Huntsville, AL
(256) 534-4443
Indianapolis, IN
(317) 783-7300 | Jackson, MS
(601) 898-0403
Jonesboro, AR
(870) 943-1933
Kansas City, MO
(816) 333-8888
Lafayette, LA
(337) 408-9400
Lake Charles, LA
(337) 477-5246
Lexington, KY
(859) 335-1200 | Little Rock, AR
(501) 224-1933
Longview, TX
(903) 238-9391
Louisville, KY
(502) 988-1960
Memphis, TN
(901) 884-1933
Mobile, AL
(334) 682-1700
Monroe, LA
(318) 323-4383 | Montgomery, AL
(334) 613-9800
Nashville, TN
(615) 367-2800
New Orleans, LA
(504) 412-9800
Northern Virginia
(703) 833-2260
Oklahoma City, OK
(405) 841-6995
Omaha, NE
(402) 393-1933 | Paducah, KY
(270) 443-3223
Pensacola, FL
(850) 437-5200
San Antonio, TX
(210) 485-5758
Shreveport, LA
(318) 635-4800
St. Louis, MO
(314) 733-1600
Toxarkana, TX
(903) 791-1933 | Topeka, KS
(785) 357-1933
Tulsa, OK
(918) 584-6000
Tyler, TX
(903) 592-2750
Waco, TX
(254) 772-9449
Washington, DC
(202) 637-0001
Wichita, KS
(316) 943-1933 |
|--|---|---|---|--|---|---|---|