

x DD

20114 LARKSPUR LANDING
(50' R.O.W.)

- NOTE:
- Distances shown in parentheses were measured on the ground.
 - The following flood information was from a F.E.M.A. Map. We are not responsible for its accuracy.

- NOTE:
- Oil, gas & other mineral rights per Title Commitment.
 - Agreement with CenterPoint Energy Electric for installation, operation, and maintenance of underground/overhead electric distribution system, as recorded under C.F.No.2006111106 of R.P.R.O.F.&C.T.X.

COMMUNITY # 48157C PANEL # 0115 J

DATE OF REVISION 01/03/97
(OUTSIDE THE 100 YEAR FLOOD PLAIN) ZONE "X"

SCALE: 1"=20'

MVC\FINALS\WVE360102

Surveyed for PULTE HOMES on 06/06/06
 Showing Lot 36 Block 1 of WATERVIEW ESTATES
 Section 2 in FORT BEND County Texas according to the Map or Plat
 recorded in PLAT NO. 20050161 of the PLAT records of FORT BEND County.

REVISIONS	
10/09/06	FINAL
2/28/07	NAME CHANGE
W.O. No. 45301,51430	
G.F. No. 907793	

I hereby certify that this survey was made on the ground under my supervision and that it correctly represents the facts found at the time of the survey. There were no encroachments apparent on the ground except as shown hereon.



Buyer: DENISE L. JOHNSON
 Mortgage Co.: MERIDIAS CAPITAL
 Title Company: FIRST AMERICAN TITLE COMPANY

Hoffman Land Surveying, Ltd.,LLP

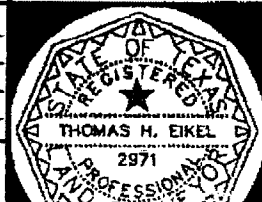

Floorplans Kendall

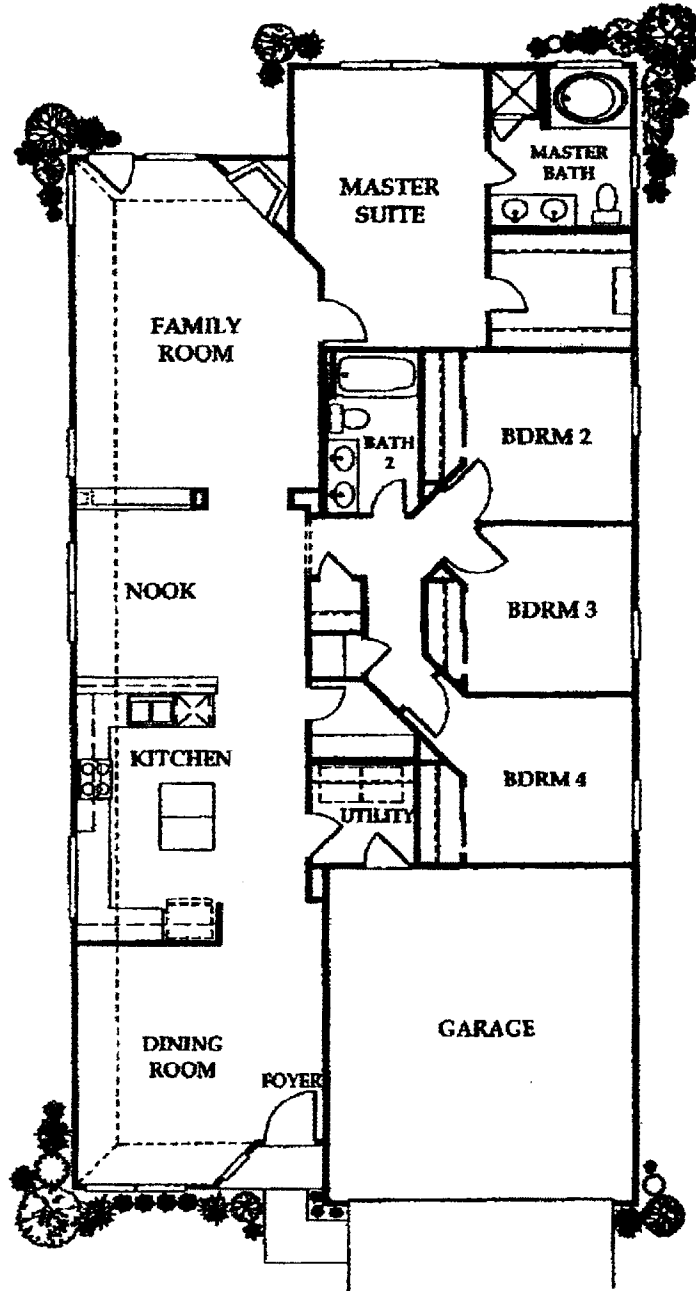

Floor Plan

H187ZM191AF10-43/09/10

