

Building Sketch

Borrower/Client	Carlos A Diaz			
Property Address	9201 Laura Ln			
City	Port Arthur	County	Jefferson	State TX Zip Code 77640
Lender	Mid America Mortgage			

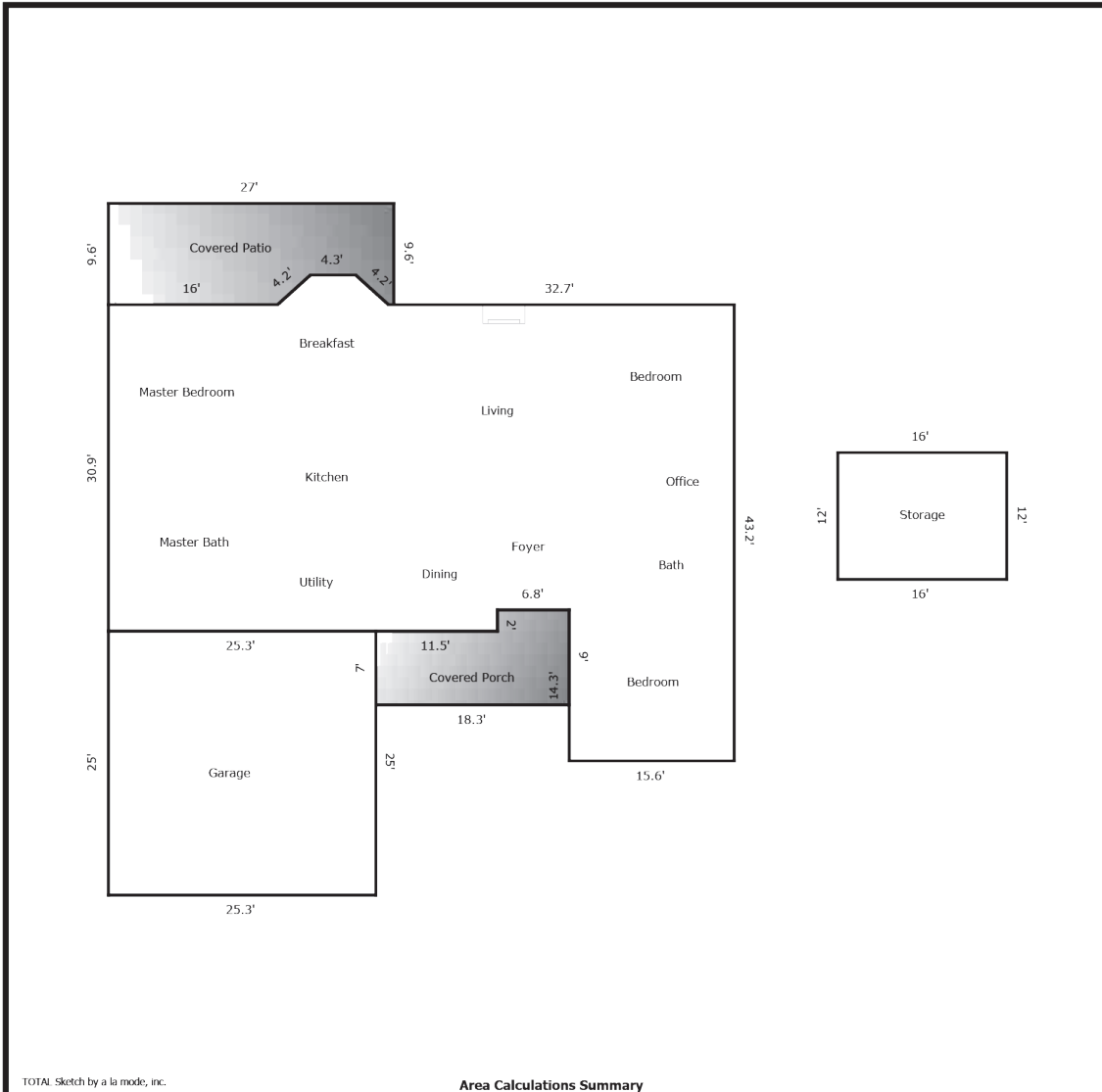

Area Calculations Summary

Living Area	Calculation Details	
First Floor	2028.3 Sq ft	$0.5 \times 3.1 \times 2.8 = 4.3$ $0.5 \times 2.8 \times 3.1 = 4.3$ $4.3 \times 2.8 = 12$ $15.6 \times 14.3 = 223.1$ $30.9 \times 36.8 = 1137.1$ $28.9 \times 22.4 = 647.4$
Total Living Area (Rounded):	2028 Sq ft	
Non-living Area		
Covered Patio	238.5 Sq ft	$27 \times 6.8 = 183.6$ $2.8 \times 16 = 44.8$ $0.5 \times 2.8 \times 3.1 = 4.3$ $2.8 \times 0.5 = 1.4$ $0.5 \times 2.8 \times 3.1 = 4.3$
Storage Bldg	192 Sq ft	$12 \times 16 = 192$
2 Car Attached	632.5 Sq ft	$25.3 \times 25 = 632.5$
Covered Porch	141.7 Sq ft	$9 \times 6.8 = 61.2$ $7 \times 11.5 = 80.5$