

FLOOD INSURANCE NOTE: By graphics plotting only, this property is in ZONE "X" of the Flood Insurance Rate Map, Community Panel No. 48201C0615L effective date of 06/18/07

AGREEMENT FOR ELECTRIC SERVICE CENTERPOINT ENERGY PER H.C.C.F. NO. X348138

**PLAT OF SURVEY  
LOT 17 BLOCK 2  
OAK RIDGE PLACE  
SECTION 6  
HARRIS COUNTY, TEXAS  
FILM CODE NO. 543115 H.C.M.R.**

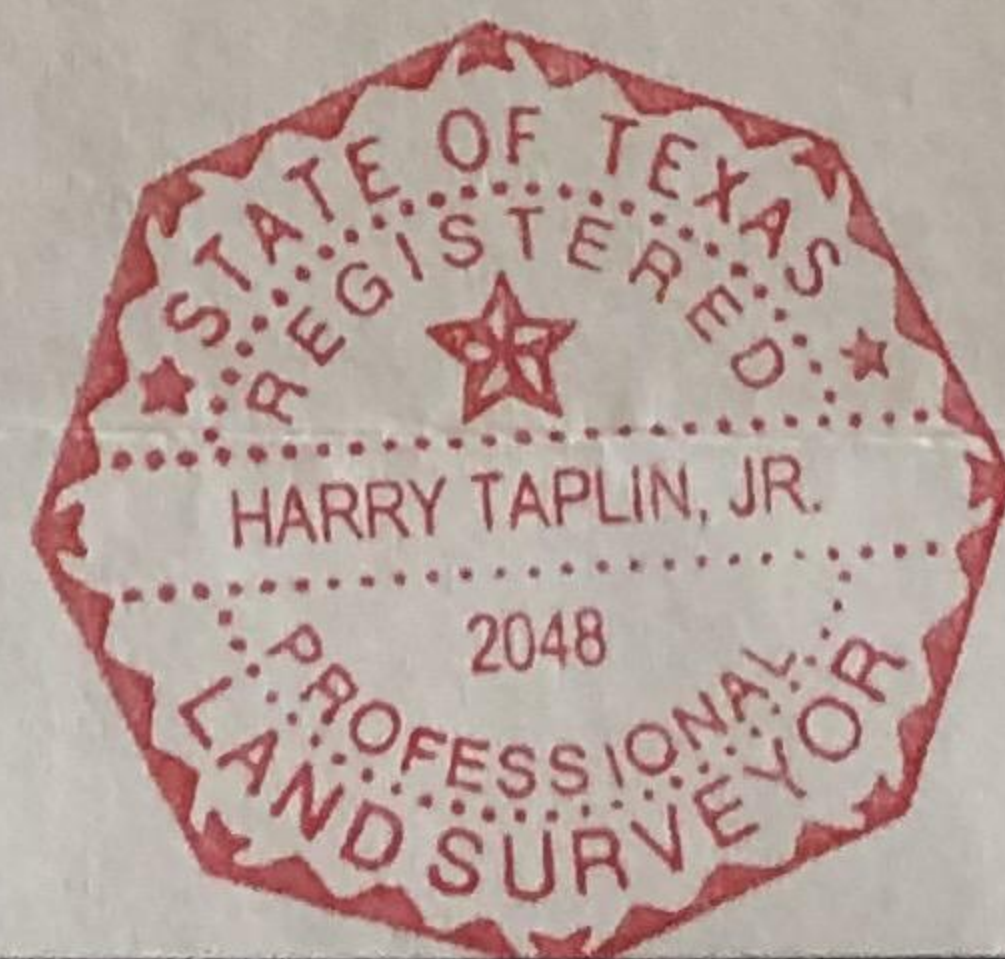

PURCHASER: ROSACLARA CASTRO

WALL STREET BANKER

ADDRESS: 2919 WESTERFIELD LANE

AMERICAN TITLE CO. GF 1456-08-1786

LONG LAKE, LTD.

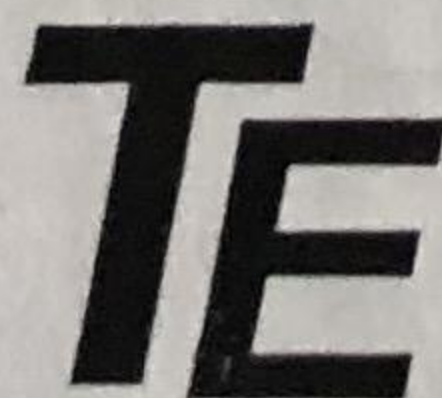

TAPLIN ENGINEERING, INC.

ENGINEERS - SURVEYORS

1011 HIGHWAY 6 SOUTH / SUITE 101

HOUSTON, TEXAS 77077

PHONE: 281-496-5896 FAX: 281-496-5898

I HEREBY CERTIFY THAT THIS SURVEY WAS MADE ON THE GROUND UNDER MY SUPERVISION AND THAT THIS PLAT CORRECTLY REPRESENTS THE FACTS AS FOUND AT THE TIME OF THE SURVEY.

*Harry Taplin, Jr.*  
REGISTERED PROFESSIONAL LAND SURVEYOR # 2048

SCALE: 1" = 20'

JOB NO.: ORP6-2-17

DRAWN DATE: 07/10/08

DRAWN BY: JLB

SURVEY DATE: 07/09/08

CHECKED BY: