

RESIDUE OF  
CALLED 481.4229 ACRES  
HANNOVER ESTATES, LTD.  
F.B.C.C.F. No. 2002140473

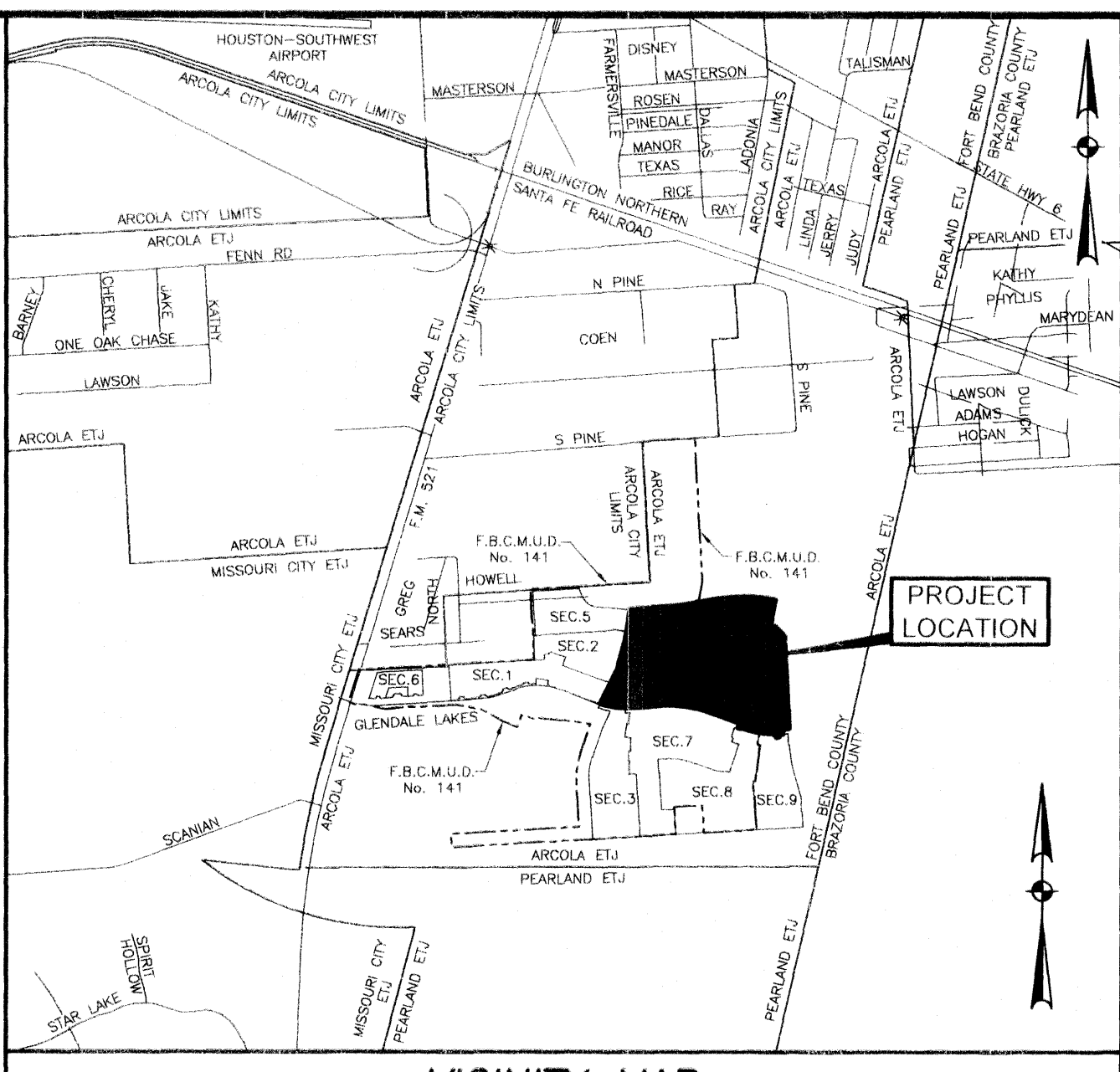

VICINITY MAP  
SCALE: N.T.S.

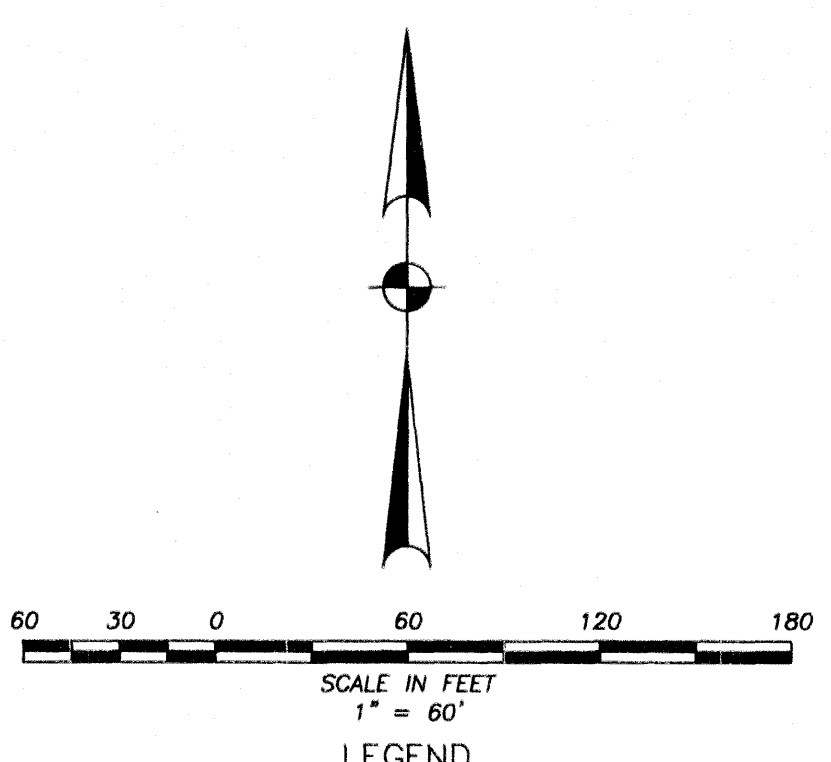

LEGEND

- AC = ACRE
- A.E. = AERIAL EASEMENT
- B.L. = BUILDING LINE
- F.B.C.C.F. = FORT BEND COUNTY CLERK'S FILE
- F.B.C.D.R. = FORT BEND COUNTY DEED RECORDS
- F.B.C.P.R. = FORT BEND COUNTY PLAT RECORDS
- LTD. = LIMITED
- NO. = NUMBER
- R = RADIUS
- R.O.W. = RIGHT-OF-WAY
- S.S.E. = SANITARY SEWER EASEMENT
- STIM.S.E. = STORM SEWER EASEMENT
- U.E. = UTILITY EASEMENT
- VOL. = VOLUME
- W.L.E. = WATER LINE EASEMENT
- X = EASTING COORDINATE
- Y = NORTHING COORDINATE
- ① = BLOCK NUMBER
- = SET 5/8-INCH IRON ROD W/MSG CAP (UNLESS OTHERWISE NOTED)
- ⊙ = FOUND 5/8-INCH IRON ROD W/MSG CAP (UNLESS OTHERWISE NOTED)
- = STREET NAME CHANGE
- = FORT BEND COUNTY MUNICIPAL UTILITY DISTRICT No. 141

MATCH LINE  
SEE SHEET 3 OF 4



RESIDUE OF  
CALLED 481.4229 ACRES  
HANNOVER ESTATES, LTD.  
F.B.C.C.F. No. 2002140473

29 pgs 2021072798

FILED AND RECORDED  
OFFICIAL PUBLIC RECORDS

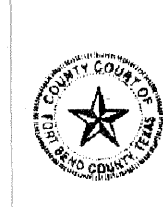

Laura Richard  
Laura Richard, County Clerk  
Fort Bend County Texas  
May 04, 2021 03:32:30 PM  
FEE: \$8817.00 EL

20210085

## GLENDALE LAKES SECTION 9

A SUBDIVISION OF 68.24 ACRES OF LAND  
LOCATED IN THE  
I. & G.N. RAILROAD CO. SURVEY, A-352  
FORT BEND COUNTY, TEXAS

113 LOTS 4 BLOCKS 10 RESERVES  
DATE: MARCH, 2021 SCALE: 1" = 60'

OWNER:  
JNC DEVELOPMENT, INC.,  
A TEXAS CORPORATION  
12309 MONTWOOD DRIVE  
EL PASO, TEXAS 79928  
915-855-1000  
MAGESH: BASHYAT

ENGINEER  
**r.g.miller**  
engineers

SURVEYOR  
**MILLER**  
SURVEY GROUP

16340 Park Ten Place - Suite 350  
Houston, Texas 77084  
(713) 461-9800

1760 WEST SAM HOUSTON PARKWAY NORTH, HOUSTON TEXAS 77043  
PHONE 713-413-1900 FAX 713-413-1944

TEXAS FIRM REGISTRATION NO. F-487  
JACK P. MILLER, P.E.

TEXAS FIRM REGISTRATION NO. 10047100  
BRIAN E. WILSON, R.P.L.S.

L:\3916\_FBCMUD\141\GLENDALE LAKES\3918-009\_GLENDALE LAKES, SEC 9\CAD\PLAT\3918-009-PLAT\_062320.DWG Apr. 20, 2021--9:30 AM TROY NIXON