

B.P. 8217 Class A

AM

MONTGOMERY COUNTY HEALTH DISTRICT  
APPLICATION FOR INSPECTION & PERMIT TO INSTALL SEPTIC SYSTEM

DATE 5-30-82 FEE PAID 75.00 xx PERMIT NUMBER 01003

NAME CARY Lee Gibbs PHONE AT HOME 458-383 PHONE AT WORK 537-5901

ADDRESS 9903 Deer TRAIL Lot 23 (19910 Turtle Dove - Magnolia TX 73555)

LOCATION OF PROPERTY TO BE INSPECTED: Turtle Creek Blk 2 Lot 5 Turtle Creek Ln

1488 to 149 - TL To Decker PRAIRIE T.L. go through STAGE

ROAD Sub. To Nickle SAWMILL Rd. TL. 1/4 m. TO Turtle Creek

Sub. 1st TO LEFT (Turtle Dove) 19910 Turtle Dove

TYPE OF BUILDING: MH NUMBER OF BATHS 2 NUMBER OF BEDROOMS 3

I hereby grant permission for the Montgomery County Health District personnel to enter upon the above described property for the purpose of performing the requested inspection and accept full responsibility for same. I understand that this permit is an evaluation of the soil at the above mentioned property and that the inspection of the septic system is just a statement of the amounts installed and that it was installed according to county standards. I understand that this is in no way a guarantee that the system will not fail or discharge; that will depend upon many factors including maintenance, water usage, amount of rainfall received on the property, etc. If the system fails or discharges, Montgomery County Health District or its employees will in no way be held responsible.

Cary Lee Gibbs  
SIGNATURE OF APPLICANT OR REPRESENTATIVE

DATE OF PERCOLATION TEST 6-29-82 DEPTH OF TESTS 18-21 RESULTS OF TEST 160

TEST PERFORMED BY Sandi Rice SOIL Silt to Red clay at 2"

DRAINAGE (GROUND WATER) fair

SOIL CONDITIONS & DRAINAGE:  
( ) FAVORABLE  
() UNFAVORABLE See diagram for Partial Evapotranspiration system. Owner should practice severe water conservation during periods of wet weather.  
( ) MARGINAL

REVIEWED BY Andy Martin TITLE DIRECTOR ENVIRONMENTAL HEALTH

BASIC SEPTIC SYSTEM REQUIREMENTS: Existing system has @ 500 gal SB2-TANKS

1. Septic Tank Size in Gallons: ( ) 750 ( ) 1000 ( ) 1250 ( ) Other \_\_\_\_\_
2. Fieldline Dimensions: 1000 sqft with partial Evapotranspirational SEE Attached. SYSTEM
3. Minimum distance between well and septic tank is 50'; between well and field line is 100'; and between field line and water line is 10' unless otherwise specified.

0010

COMMENTS: \_\_\_\_\_

FINAL INSPECTION DIAGRAM

TOTAL GALLONS INSTALLED: 1,000 INSTALLERS NAME Bary Gibbs  
 TOTAL SQUARE FEET INSTALLED: 1,268 sq. ft. INSTALLERS ADDRESS \_\_\_\_\_  
 MEETS MINIMUM COUNTY STANDARDS. see comments

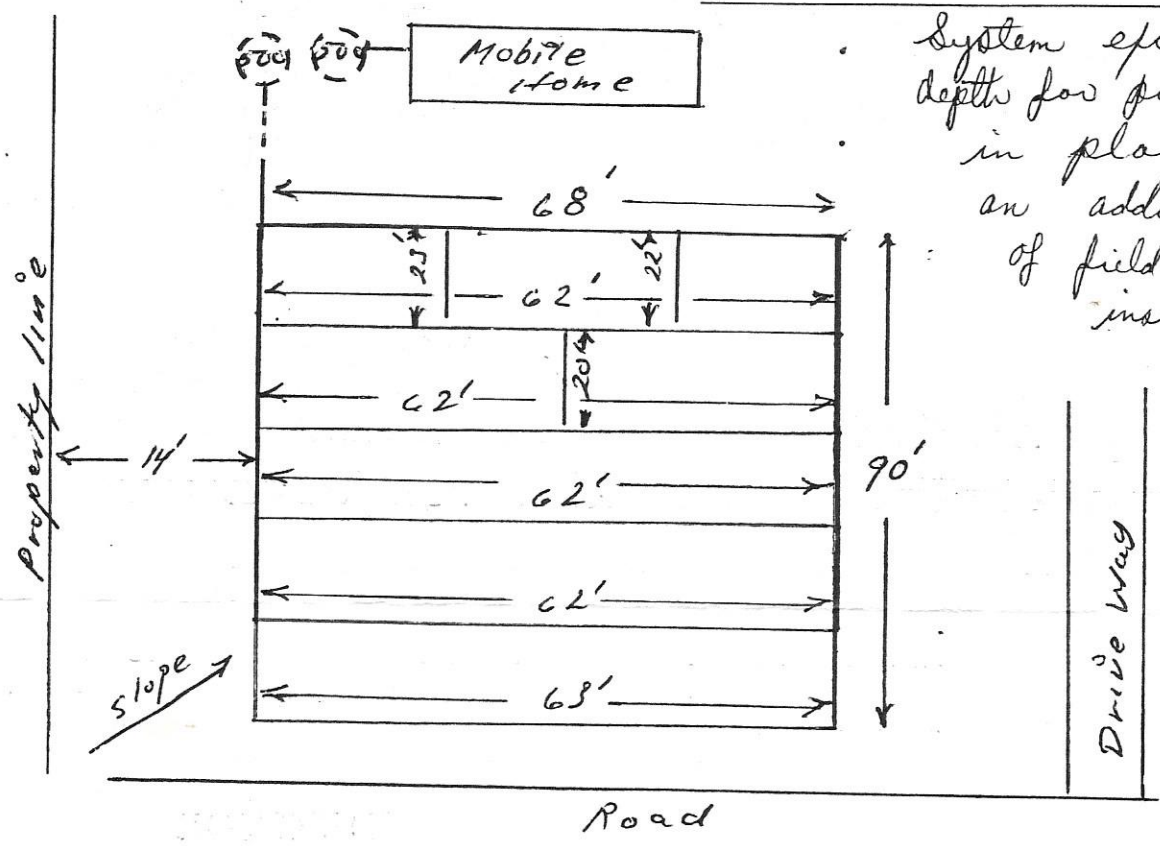

System exceeds trench depth for partial E.T. in places. However an additional 268 sq. ft. of field line was installed over the requirements. System meets standards with the above comments noted.

C. M.  
9-14-82

COMMENTS: P.V.C, 20", Gravel, 12", Hay, Dry Slopes to the back of the lot (1-6")  
Trench was deeper in places due to the slope of lot.

INSPECTED BY Randy Sparks & Don J. Maubens, P.S. DATE 9-10-82  
 VIEWED BY Cindy Maubens DATE 9-14-82