

Building Sketch

Borrower	NA				
Property Address	408 N 14th St				
City	Nederland	County	Jefferson	State	TX
Lender/Client	Kevin Herrington	Zip Code	77627		

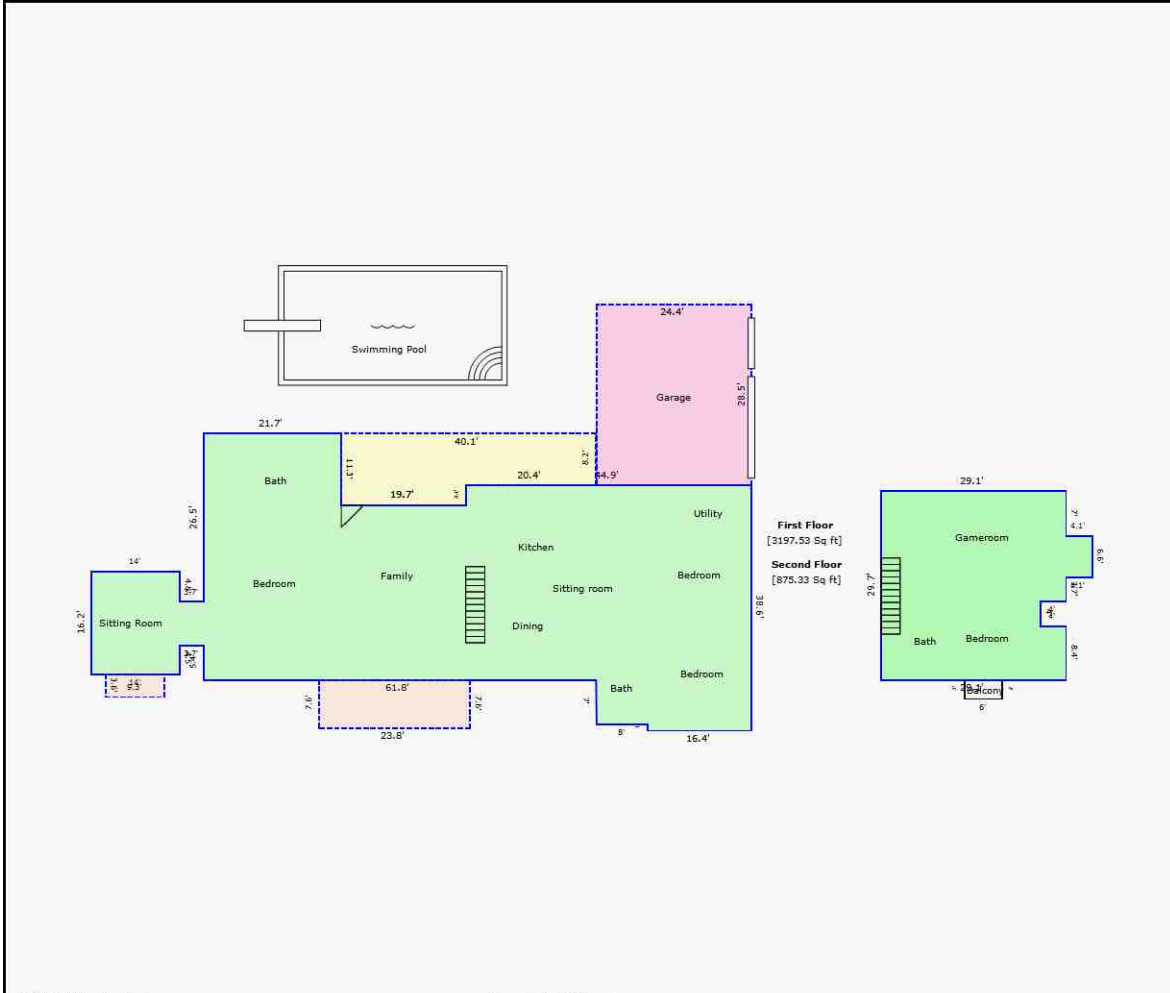

TOTAL Sketch by a la mode, inc.

Area Calculations Summary

Living Area	Area	Calculation Details
First Floor	3197.53 Sq ft	$16.2 \times 14 = 226.8$ $6.9 \times 3.7 = 25.53$ $38.8 \times 21.7 = 841.96$ $27.5 \times 19.7 = 541.75$ $44.9 \times 30.6 = 1373.94$ $8 \times 16.4 = 131.2$ $7 \times 8 = 56$ $0.5 \times 7 \times 0.1 = 0.35$
Second Floor	875.33 Sq ft	$29.7 \times 25.1 = 745.47$ $6.6 \times 4.1 = 27.06$ $4 \times 17.3 = 69.2$ $8.4 \times 4 = 33.6$
Total Living Area (Rounded):	4073 Sq ft	
Non-living Area		
3 Car Attached	695.4 Sq ft	$24.4 \times 28.5 = 695.4$
Balcony	18 Sq ft	$6 \times 3 = 18$
Cvrd Porch	180.88 Sq ft	$23.8 \times 7.6 = 180.88$
Cvd Patio	389.89 Sq ft	$11.3 \times 19.7 = 222.61$ $20.4 \times 8.2 = 167.28$
Cvrd Porch	33.48 Sq ft	$9.3 \times 3.6 = 33.48$