

James Dean Dandy Kiek B Rice
Folly Dandy Margaret J Rice

Ronald A. Miculka
Angela R. Miculka

- NOTES:
 1.) SUBJECT TO APPLICABLE RESTRICTIVE COVENANTS LISTED IN ITEM No. 1, SCHEDULE "B" OF TITLE COMMITMENT ISSUED BY STEWART TITLE CO. UNDER G.F. # 00113921
 2.) H.L. & P. AGREEMENT IN C.F. # K062334
 3.) BLDG. LINE RESTRICTIONS IN C.F. # H221560 & K132768
 4.) GARAGE IS NOT WITHIN THE 7'X 16' A.E.
 5.) CONC. PAD INTO THE B' U.E. AS SHOWN.

ABSTRACTING BY TITLE COMPANY.
 ALL BEARINGS SHOWN ARE REFERENCED PER RECORDED PLAT OF SAID SUBDIVISION.

LOT: 38		BLOCK: 6	SUBDIVISION: WINCHESTER COUNTRY TRAILS	SECTION: 3
COUNTY: HARRIS	STATE: TEXAS	RECORDATION: VOL. 328, PG. 80, H.C.M.R.	SURVEY: FIELD WORK: 04-28-00/BW	SCALE: 1"=20'
PURCHASER: RONALD A. MICULKA & ANGELA MICULKA		DRAFTING: 05-04-00/V.T.		KEY MAP: 409 G
ADDRESS: 8938 BENT SPUR LANE, HOUSTON, TEXAS				



ALLTEX
 REALTY SERVICES
 REAL ESTATE SURVEY DIVISION
 9610 LONGPOINT, SUITE 150
 HOUSTON, TEXAS 77055
 TEL: (713) 468-7707

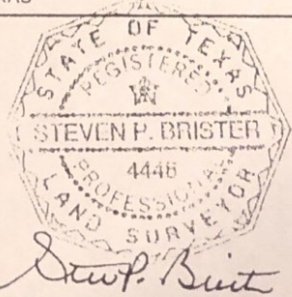

Steven P. Brister

I DO HEREBY CERTIFY THAT THIS SURVEY WAS THIS DAY MADE ON THE GROUND OF THE PROPERTY LEGALLY DESCRIBED HEREON IS

* SUBJECT PROPERTY -IS NOT- LOCATED IN A FEDERAL INSURANCE ADMINISTRATION DESIGNATED FLOOD HAZARD AREA ZONE "X" AS PER MAP 480287 PANEL 0440 J DATED: 11-06-96

* This information is based on graphic plotting only. We do not assume responsibility for exact determination.

MORT. CO.	CTX MTG.
TITLE CO.	STEWART TITLE CO.
G.F. No.	00113921
JOB No.	00-27320