

Building Sketch (Page - 1)

Borrower/Client	Henry Snow						
Property Address	43 Ponderosa Dr						
City	New Waverly	County	Walker	State	TX	Zip Code	77358
Lender	First Financial Bank						

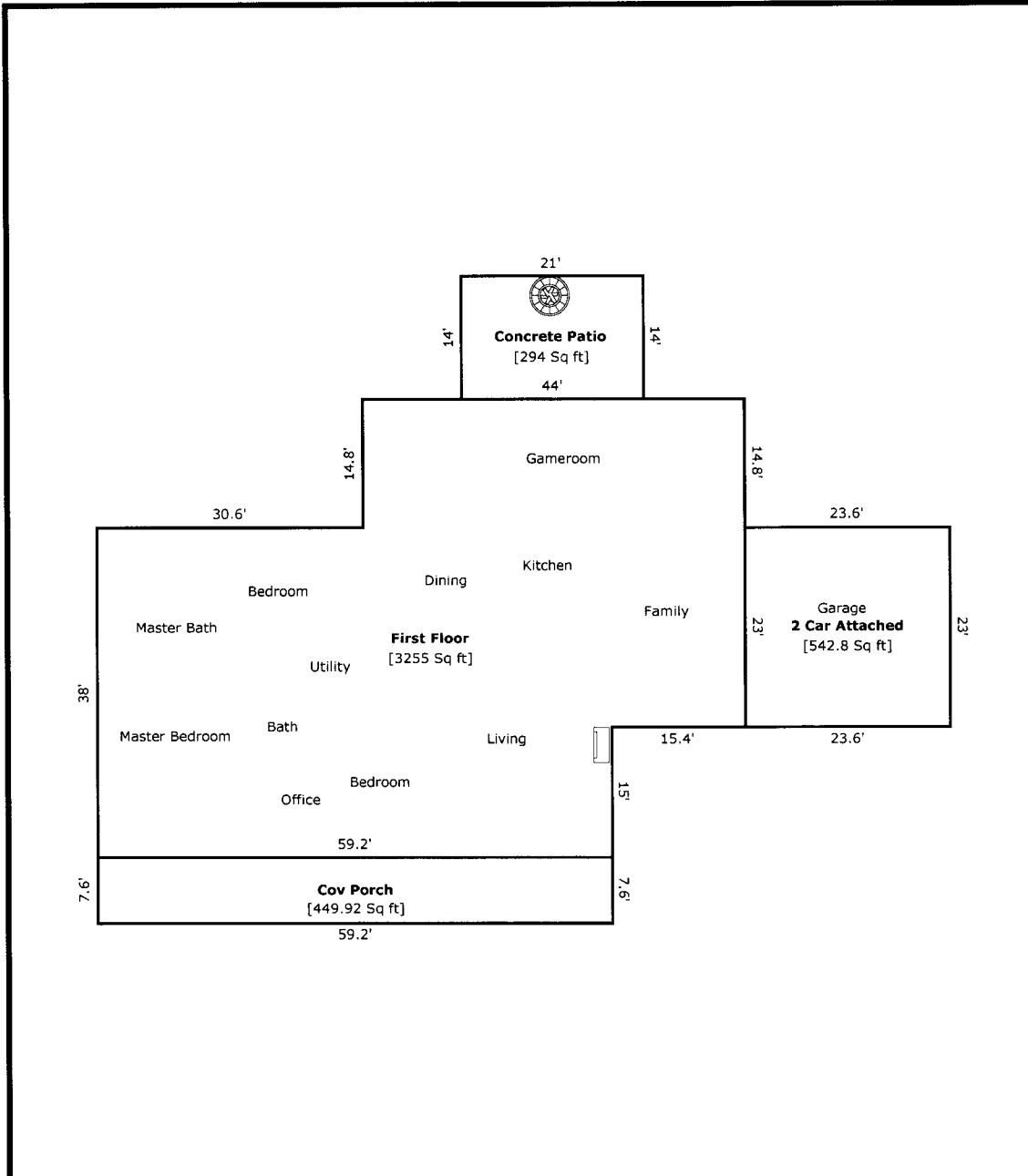

TOTAL Sketch by a la mode, inc.

Area Calculations Summary

Living Area	Area	Calculation Details
First Floor	3255 Sq ft	$38 \times 30.6 = 1162.8$ $44 \times 37.8 = 1663.2$ $15 \times 28.6 = 429$
Total Living Area (Rounded):	3255 Sq ft	
Non-living Area	542.8 Sq ft	$23.6 \times 23 = 542.8$
Cov Porch	449.92 Sq ft	$59.2 \times 7.6 = 449.92$
Concrete Patio	294 Sq ft	$21 \times 14 = 294$

Building Sketch (Page - 2)

Borrower/Client	Henry Snow				
Property Address	43 Ponderosa Dr				
City	New Waverly	County	Walker	State	TX
Lender	First Financial Bank	Zip Code	77358		

