



Foundation Service, Inc.

8538 Cedel • Houston, TX 77055-1119 • Fax (713) 465-3465 • Phone (713) 467-8981

July 07, 1997

M/M Chris Mathers
9013 Larston
Houston, TX 77055

RE: 9013 Larston
Houston, TX

Dear M/M Mathers:

Work on the above referenced property has recently been completed. AAA Foundation Service, Inc. installed twenty (20) exterior, steel, cast-in-place, deep bell bottom piers.

Enclosed you will find a drawing with the location of the piers. Please keep this drawing in a safe place for future reference.

AAA Foundation Service, Inc. takes pride in our work, therefore we take pride in your home. If there is anything we can do for you, please do not hesitate to contact us.

Sincerely,

Greg R. Covington
GRC/rnd

W97065

OWNER: M/M CHRIS MATHERS

ADDRESS: 9013 LARSTON
HOUSTON, TX 77055

DATE COMPLETED: JULY 03, 1997

LIFETIME SERVICE AGREEMENT

If any adjustments are necessary during the life of the structure due to settling of piers, AAA will adjust the piers installed under the terms of the Contract. The Service Agreement will be honored at NO CHARGE to the Homeowner for the first ten (10) years following the date of installation. After this initial period, if any adjustments are deemed necessary, AAA will perform such adjustments on above described piers at a rate of \$30.00 per pier. This Service Agreement applies only to the 20 piers installed by AAA Foundation Service, Inc. under the terms and provisions of this contract.

TRANSFERABILITY

This Service Agreement will transfer one time only. This agreement is assignable by the owner of this contract if written notification is received in this office by certified mail within 30 days of the closing date and a transfer fee of \$125.00 is paid. If this assignment is not properly made, this agreement is void.



Foundation Service, Inc.

8538 Cedel
Houston, Texas 77055

PHONE: (713) 467-8981 FAX: (713) 465-3465

OVER
41
YEARS
SERVING
HOUSTON

DRAWING NOT TO SCALE
PIER SPACING APPROXIMATE
ZONE LAYOUT APPROXIMATE

NAME Christ MATTERS HOME 465-1661 WORK 675-9000
ADDRESS 9013 LARSTON KEY MAP # 4504-Z # HOLES 20
CITY HOUSTON

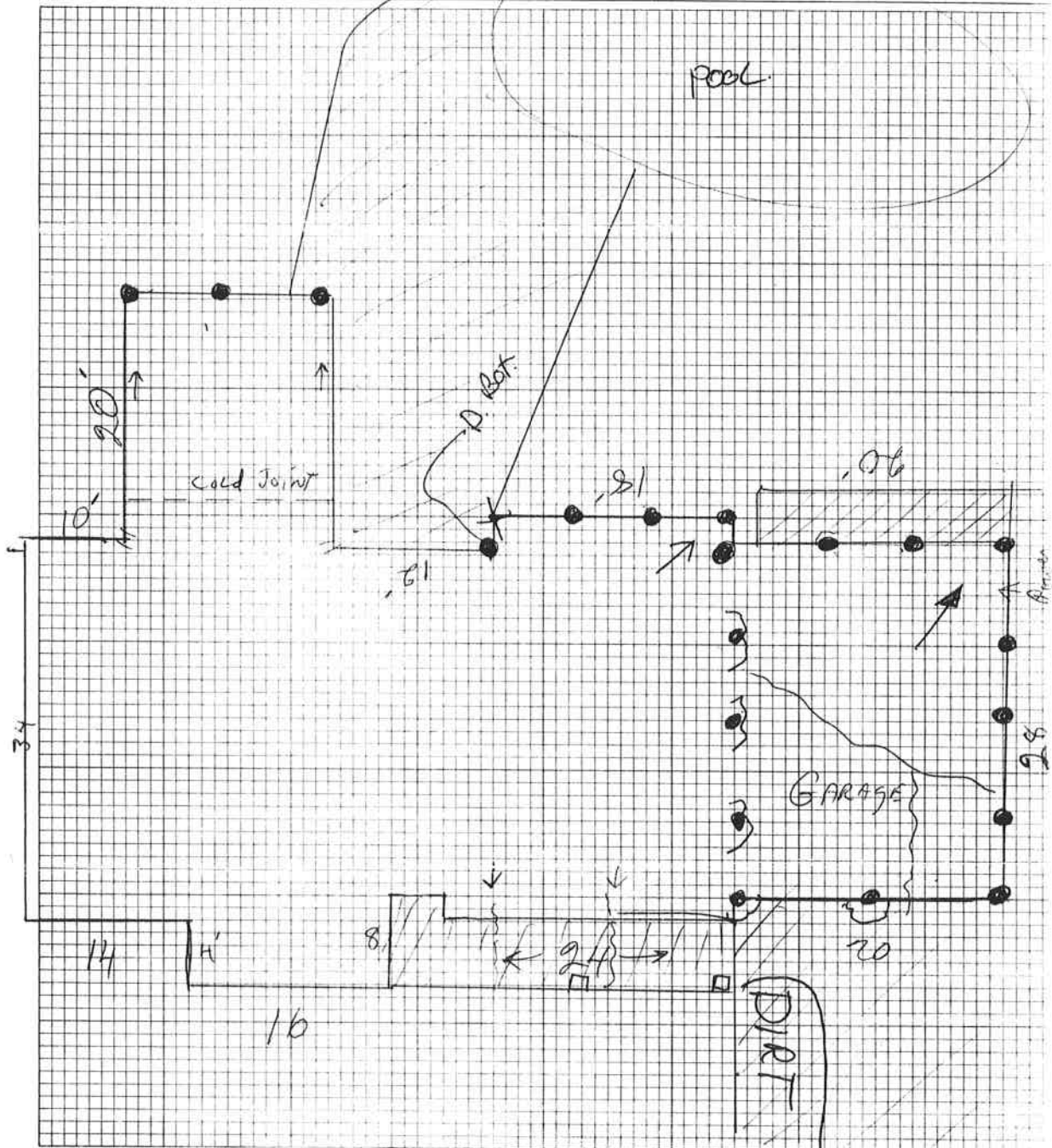

NOTES: _____

●	Proposed Exterior Pier		Slab Crack
●	Proposed Interior Pier		Brick Veneer Crack
○	Existing Exterior Pier		Separation @ Door/Window
△	Existing Interior Pier		Injection