



# SELLER'S DISCLOSURE NOTICE

©Texas Association of REALTORS®, Inc. 2019

Section 5.008, Property Code requires a seller of residential property of not more than one dwelling unit to deliver a Seller's Disclosure Notice to a buyer on or before the effective date of a contract. This form complies with and contains additional disclosures which exceed the minimum disclosures required by the Code.

CONCERNING THE PROPERTY AT 818 Chowning Rd., Houston, TX 77024

THIS NOTICE IS A DISCLOSURE OF SELLER'S KNOWLEDGE OF THE CONDITION OF THE PROPERTY AS OF THE DATE SIGNED BY SELLER AND IS NOT A SUBSTITUTE FOR ANY INSPECTIONS OR WARRANTIES THE BUYER MAY WISH TO OBTAIN. IT IS NOT A WARRANTY OF ANY KIND BY SELLER, SELLER'S AGENTS, OR ANY OTHER AGENT.

Seller  is  is not occupying the Property. If unoccupied (by Seller), how long since Seller has occupied the Property?  vacant since July 2021 for prep work for sale (approximate date) or  never occupied the Property

### Section 1. The Property has the items marked below: (Mark Yes (Y), No (N), or Unknown (U).)

This notice does not establish the items to be conveyed. The contract will determine which items will & will not convey.

Item	Y	N	U
Cable TV Wiring	X		
Carbon Monoxide Det.	X		
Ceiling Fans	X		
Cooktop	X		
Dishwasher	X		
Disposal	X		
Emergency Escape Ladder(s)		X	
Exhaust Fans	X		
Fences	X		
Fire Detection Equip.	X		
French Drain		X	
Gas Fixtures		X	
Natural Gas Lines	X		

Item	Y	N	U
Liquid Propane Gas:		X	
-LP Community (Captive)		X	
-LP on Property		X	
Hot Tub	X		
Intercom System		X	
Microwave	X		
Outdoor Grill		X	
Patio/Decking	X		
Plumbing System	X		
Pool		X	
Pool Equipment		X	
Pool Maint. Accessories		X	
Pool Heater		X	

Item	Y	N	U
Pump: <input type="checkbox"/> sump <input type="checkbox"/> grinder		X	
Rain Gutters	X		
Range/Stove	X		
Roof/Attic Vents	X		
Sauna		X	
Smoke Detector	X		
Smoke Detector - Hearing Impaired		X	
Spa		X	
Trash Compactor		X	
TV Antenna			X
Washer/Dryer Hookup	X		
Window Screens		X	
Public Sewer System	X		

Item	Y	N	U	Additional Information
Central A/C	X			<input checked="" type="checkbox"/> electric <input type="checkbox"/> gas number of units: <u>3</u>
Evaporative Coolers		X		number of units: _____
Wall/Window AC Units		X		number of units: _____
Attic Fan(s)		X		if yes, describe: _____
Central Heat	X			<input type="checkbox"/> electric <input checked="" type="checkbox"/> gas number of units: <u>3</u>
Other Heat		X		if yes describe: _____
Oven	X			number of ovens: <u>1</u> <input checked="" type="checkbox"/> electric <input type="checkbox"/> gas <input type="checkbox"/> other: _____
Fireplace & Chimney	X			<input checked="" type="checkbox"/> wood <input type="checkbox"/> gas logs <input type="checkbox"/> mock <input type="checkbox"/> other: _____
Carport		X		<input type="checkbox"/> attached <input type="checkbox"/> not attached
Garage	X			<input checked="" type="checkbox"/> attached <input type="checkbox"/> not attached
Garage Door Openers	X			number of units: <u>1</u> number of remotes: <u>2</u>
Satellite Dish & Controls			X	<input type="checkbox"/> owned <input type="checkbox"/> leased from _____
Security System			X	<input type="checkbox"/> owned <input type="checkbox"/> leased from _____
Solar Panels		X		<input type="checkbox"/> owned <input type="checkbox"/> leased from _____
Water Heater	X			<input type="checkbox"/> electric <input checked="" type="checkbox"/> gas <input type="checkbox"/> other: _____ number of units: <u>2</u>
Water Softener		X		<input type="checkbox"/> owned <input type="checkbox"/> leased from _____
Other Leased Item(s)			X	if yes, describe: _____

Underground Lawn Sprinkler	<input checked="" type="checkbox"/>	<input type="checkbox"/>	<input checked="" type="checkbox"/> automatic <input type="checkbox"/> manual	areas covered: <u>all green areas</u>
Septic / On-Site Sewer Facility	<input type="checkbox"/>	<input checked="" type="checkbox"/>	if yes, attach Information About On-Site Sewer Facility (TXR-1407)	

Water supply provided by:  city  well  MUD  co-op  unknown  other: \_\_\_\_\_

Was the Property built before 1978?  yes  no  unknown

(If yes, complete, sign, and attach TXR-1906 concerning lead-based paint hazards).

Roof Type: Composition Age: 7 yrs (2014) (approximate)

Is there an overlay roof covering on the Property (shingles or roof covering placed over existing shingles or roof covering)?  yes  no  unknown

Are you (Seller) aware of any of the items listed in this Section 1 that are not in working condition, that have defects, or are need of repair?  yes  no If yes, describe (attach additional sheets if necessary): \_\_\_\_\_

**Section 2. Are you (Seller) aware of any defects or malfunctions in any of the following? (Mark Yes (Y) if you are aware and No (N) if you are not aware.)**

Item	Y	N
Basement		<input checked="" type="checkbox"/>
Ceilings		<input checked="" type="checkbox"/>
Doors		<input checked="" type="checkbox"/>
Driveways		<input checked="" type="checkbox"/>
Electrical Systems		<input checked="" type="checkbox"/>
Exterior Walls		<input checked="" type="checkbox"/>

Item	Y	N
Floors		<input checked="" type="checkbox"/>
Foundation / Slab(s)		<input checked="" type="checkbox"/>
Interior Walls		<input checked="" type="checkbox"/>
Lighting Fixtures		<input checked="" type="checkbox"/>
Plumbing Systems		<input checked="" type="checkbox"/>
Roof		<input checked="" type="checkbox"/>

Item	Y	N
Sidewalks		<input checked="" type="checkbox"/>
Walls / Fences		<input checked="" type="checkbox"/>
Windows		<input checked="" type="checkbox"/>
Other Structural Components		<input checked="" type="checkbox"/>

If the answer to any of the items in Section 2 is yes, explain (attach additional sheets if necessary): \_\_\_\_\_

**Section 3. Are you (Seller) aware of any of the following conditions? (Mark Yes (Y) if you are aware and No (N) if you are not aware.)**

Condition	Y	N
Aluminum Wiring		<input checked="" type="checkbox"/>
Asbestos Components		<input checked="" type="checkbox"/>
Diseased Trees: <input type="checkbox"/> oak wilt <input type="checkbox"/>		<input checked="" type="checkbox"/>
Endangered Species/Habitat on Property		<input checked="" type="checkbox"/>
Fault Lines		<input checked="" type="checkbox"/>
Hazardous or Toxic Waste		<input checked="" type="checkbox"/>
Improper Drainage		<input checked="" type="checkbox"/>
Intermittent or Weather Springs		<input checked="" type="checkbox"/>
Landfill		<input checked="" type="checkbox"/>
Lead-Based Paint or Lead-Based Pt. Hazards		<input checked="" type="checkbox"/>
Encroachments onto the Property		<input checked="" type="checkbox"/>
Improvements encroaching on others' property	<input checked="" type="checkbox"/>	
Located in Historic District		<input checked="" type="checkbox"/>
Historic Property Designation		<input checked="" type="checkbox"/>
Previous Foundation Repairs		<input checked="" type="checkbox"/>
Previous Roof Repairs		<input checked="" type="checkbox"/>
Previous Other Structural Repairs		<input checked="" type="checkbox"/>
Previous Use of Premises for Manufacture of Methamphetamine		<input checked="" type="checkbox"/>

Condition	Y	N
Radon Gas		<input checked="" type="checkbox"/>
Settling	<input checked="" type="checkbox"/>	
Soil Movement		<input checked="" type="checkbox"/>
Subsurface Structure or Pits		<input checked="" type="checkbox"/>
Underground Storage Tanks		<input checked="" type="checkbox"/>
Unplatted Easements		<input checked="" type="checkbox"/>
Unrecorded Easements		<input checked="" type="checkbox"/>
Urea-formaldehyde Insulation		<input checked="" type="checkbox"/>
Water Damage Not Due to a Flood Event		<input checked="" type="checkbox"/>
Wetlands on Property		<input checked="" type="checkbox"/>
Wood Rot		<input checked="" type="checkbox"/>
Active infestation of termites or other wood destroying insects (WDI)		<input checked="" type="checkbox"/>
Previous treatment for termites or WDI		<input checked="" type="checkbox"/>
Previous termite or WDI damage repaired		<input checked="" type="checkbox"/>
Previous Fires		<input checked="" type="checkbox"/>
Termite or WDI damage needing repair		<input checked="" type="checkbox"/>
Single Blockable Main Drain in Pool/Hot Tub/Spa*		<input checked="" type="checkbox"/>

If the answer to any of the items in Section 3 is yes, explain (attach additional sheets if necessary): \_\_\_\_\_  
Eleven pilings were installed to remedy settling by Jericho Foundation in Nov 2012 (details attached)

\*A single blockable main drain may cause a suction entrapment hazard for an individual.

**Section 4. Are you (Seller) aware of any item, equipment, or system in or on the Property that is in need of repair, which has not been previously disclosed in this notice?**  yes  no If yes, explain (attach additional sheets if necessary): \_\_\_\_\_

**Section 5. Are you (Seller) aware of any of the following conditions?\*** (Mark Yes (Y) if you are aware and check wholly or partly as applicable. Mark No (N) if you are not aware.)

- |                          |                                     |   |
|--------------------------|-------------------------------------|---|
| <u>Y</u>                 | <u>N</u>                            |   |
| <input type="checkbox"/> | <input checked="" type="checkbox"/> | Present flood insurance coverage (if yes, attach TXR 1414).   |
| <input type="checkbox"/> | <input checked="" type="checkbox"/> | Previous flooding due to a failure or breach of a reservoir or a controlled or emergency release of water from a reservoir.   |
| <input type="checkbox"/> | <input checked="" type="checkbox"/> | Previous flooding due to a natural flood event (if yes, attach TXR 1414).   |
| <input type="checkbox"/> | <input checked="" type="checkbox"/> | Previous water penetration into a structure on the Property due to a natural flood event (if yes, attach TXR 1414).   |
| <input type="checkbox"/> | <input checked="" type="checkbox"/> | Located <input type="checkbox"/> wholly <input type="checkbox"/> partly in a 100-year floodplain (Special Flood Hazard Area-Zone A, V, A99, AE, AO, AH, VE, or AR) (if yes, attach TXR 1414). |
| <input type="checkbox"/> | <input checked="" type="checkbox"/> | Located <input type="checkbox"/> wholly <input type="checkbox"/> partly in a 500-year floodplain (Moderate Flood Hazard Area-Zone X (shaded)).  |
| <input type="checkbox"/> | <input checked="" type="checkbox"/> | Located <input type="checkbox"/> wholly <input type="checkbox"/> partly in a floodway (if yes, attach TXR 1414).  |
| <input type="checkbox"/> | <input checked="" type="checkbox"/> | Located <input type="checkbox"/> wholly <input type="checkbox"/> partly in a flood pool.  |
| <input type="checkbox"/> | <input checked="" type="checkbox"/> | Located <input type="checkbox"/> wholly <input type="checkbox"/> partly in a reservoir.   |

If the answer to any of the above is yes, explain (attach additional sheets as necessary): \_\_\_\_\_

\*For purposes of this notice:

"100-year floodplain" means any area of land that: (A) is identified on the flood insurance rate map as a special flood hazard area, which is designated as Zone A, V, A99, AE, AO, AH, VE, or AR on the map; (B) has a one percent annual chance of flooding, which is considered to be a high risk of flooding; and (C) may include a regulatory floodway, flood pool, or reservoir.

"500-year floodplain" means any area of land that: (A) is identified on the flood insurance rate map as a moderate flood hazard area, which is designated on the map as Zone X (shaded); and (B) has a two-tenths of one percent annual chance of flooding, which is considered to be a moderate risk of flooding.

"Flood pool" means the area adjacent to a reservoir that lies above the normal maximum operating level of the reservoir and that is subject to controlled inundation under the management of the United States Army Corps of Engineers.

"Flood insurance rate map" means the most recent flood hazard map published by the Federal Emergency Management Agency under the National Flood Insurance Act of 1968 (42 U.S.C. Section 4001 et seq.).

"Floodway" means an area that is identified on the flood insurance rate map as a regulatory floodway, which includes the channel of a river or other watercourse and the adjacent land areas that must be reserved for the discharge of a base flood, also referred to as a 100-year flood, without cumulatively increasing the water surface elevation more than a designated height.

"Reservoir" means a water impoundment project operated by the United States Army Corps of Engineers that is intended to retain water or delay the runoff of water in a designated surface area of land.

**Section 6. Have you (Seller) ever filed a claim for flood damage to the Property with any insurance provider, including the National Flood Insurance Program (NFIP)?\***  yes  no If yes, explain (attach additional sheets as necessary): No

\*Homes in high risk flood zones with mortgages from federally regulated or insured lenders are required to have flood insurance. Even when not required, the Federal Emergency Management Agency (FEMA) encourages homeowners in high risk, moderate risk, and low risk flood zones to purchase flood insurance that covers the structure(s) and the personal property within the structure(s).

**Section 7. Have you (Seller) ever received assistance from FEMA or the U.S. Small Business Administration (SBA) for flood damage to the Property?**  yes  no If yes, explain (attach additional sheets as necessary): No

**Section 8. Are you (Seller) aware of any of the following? (Mark Yes (Y) if you are aware. Mark No (N) if you are not aware.)**

- | <u>Y</u>                            | <u>N</u>                            |  |
|-------------------------------------|-------------------------------------|--|
| <input type="checkbox"/>            | <input checked="" type="checkbox"/> | Room additions, structural modifications, or other alterations or repairs made without necessary permits, with unresolved permits, or not in compliance with building codes in effect at the time.   |
| <input checked="" type="checkbox"/> | <input type="checkbox"/>            | Homeowners' associations or maintenance fees or assessments. If yes, complete the following:<br>Name of association: <u>Williamsburg Village (10 houses on Chowning Rd only) Mgr: jcburns33@gmail.com</u><br>Manager's name: <u>Jamie Burns</u> Phone: <u>504-606-7153</u><br>Fees or assessments are: \$ <u>250</u> per <u>year</u> and are: <input checked="" type="checkbox"/> mandatory <input type="checkbox"/> voluntary<br>Any unpaid fees or assessment for the Property? <input type="checkbox"/> yes (\$ <u>          </u> ) <input checked="" type="checkbox"/> no<br>If the Property is in more than one association, provide information about the other associations below or attach information to this notice. |
| <input type="checkbox"/>            | <input checked="" type="checkbox"/> | Any common area (facilities such as pools, tennis courts, walkways, or other) co-owned in undivided interest with others. If yes, complete the following:<br>Any optional user fees for common facilities charged? <input type="checkbox"/> yes <input type="checkbox"/> no If yes, describe: <u>          </u>  |
| <input type="checkbox"/>            | <input checked="" type="checkbox"/> | Any notices of violations of deed restrictions or governmental ordinances affecting the condition or use of the Property.  |
| <input type="checkbox"/>            | <input checked="" type="checkbox"/> | Any lawsuits or other legal proceedings directly or indirectly affecting the Property. (Includes, but is not limited to: divorce, foreclosure, heirship, bankruptcy, and taxes.)   |
| <input type="checkbox"/>            | <input checked="" type="checkbox"/> | Any death on the Property except for those deaths caused by: natural causes, suicide, or accident unrelated to the condition of the Property.  |
| <input type="checkbox"/>            | <input checked="" type="checkbox"/> | Any condition on the Property which materially affects the health or safety of an individual.  |
| <input type="checkbox"/>            | <input checked="" type="checkbox"/> | Any repairs or treatments, other than routine maintenance, made to the Property to remediate environmental hazards such as asbestos, radon, lead-based paint, urea-formaldehyde, or mold.<br>If yes, attach any certificates or other documentation identifying the extent of the remediation (for example, certificate of mold remediation or other remediation).   |
| <input type="checkbox"/>            | <input checked="" type="checkbox"/> | Any rainwater harvesting system located on the Property that is larger than 500 gallons and that uses a public water supply as an auxiliary water source.  |
| <input type="checkbox"/>            | <input checked="" type="checkbox"/> | The Property is located in a propane gas system service area owned by a propane distribution system retailer.  |
| <input type="checkbox"/>            | <input checked="" type="checkbox"/> | Any portion of the Property that is located in a groundwater conservation district or a subsidence district.   |

If the answer to any of the items in Section 8 is yes, explain (attach additional sheets if necessary): \_\_\_\_\_

**Section 9.** Seller  has  has not attached a survey of the Property.

**Section 10.** Within the last 4 years, have you (Seller) received any written inspection reports from persons who regularly provide inspections and who are either licensed as inspectors or otherwise permitted by law to perform inspections?  yes  no If yes, attach copies and complete the following:

Inspection Date	Type	Name of Inspector	No. of Pages

*Note: A buyer should not rely on the above-cited reports as a reflection of the current condition of the Property. A buyer should obtain inspections from inspectors chosen by the buyer.*

**Section 11.** Check any tax exemption(s) which you (Seller) currently claim for the Property:

- Homestead  Senior Citizen  Disabled
- Wildlife Management  Agricultural  Disabled Veteran
- Other: \_\_\_\_\_  Unknown

**Section 12.** Have you (Seller) ever filed a claim for damage, other than flood damage, to the Property with any insurance provider?  yes  no

**Section 13.** Have you (Seller) ever received proceeds for a claim for damage to the Property (for example, an insurance claim or a settlement or award in a legal proceeding) and not used the proceeds to make the repairs for which the claim was made?  yes  no If yes, explain: \_\_\_\_\_

**Section 14.** Does the Property have working smoke detectors installed in accordance with the smoke detector requirements of Chapter 766 of the Health and Safety Code?\*  unknown  no  yes. If no or unknown, explain. (Attach additional sheets if necessary): \_\_\_\_\_

*\*Chapter 766 of the Health and Safety Code requires one-family or two-family dwellings to have working smoke detectors installed in accordance with the requirements of the building code in effect in the area in which the dwelling is located, including performance, location, and power source requirements. If you do not know the building code requirements in effect in your area, you may check unknown above or contact your local building official for more information.*

*A buyer may require a seller to install smoke detectors for the hearing impaired if: (1) the buyer or a member of the buyer's family who will reside in the dwelling is hearing-impaired; (2) the buyer gives the seller written evidence of the hearing impairment from a licensed physician; and (3) within 10 days after the effective date, the buyer makes a written request for the seller to install smoke detectors for the hearing-impaired and specifies the locations for installation. The parties may agree who will bear the cost of installing the smoke detectors and which brand of smoke detectors to install.*

Seller acknowledges that the statements in this notice are true to the best of Seller's belief and that no person, including the broker(s), has instructed or influenced Seller to provide inaccurate information or to omit any material information.

 9/26/21  
Signature of Seller Date

Printed Name: Sibok Kim

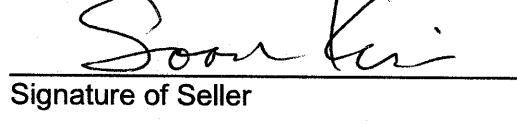
 9/26/21  
Signature of Seller Date

Printed Name: Soon Kim

**ADDITIONAL NOTICES TO BUYER:**

- (1) The Texas Department of Public Safety maintains a database that the public may search, at no cost, to determine if registered sex offenders are located in certain zip code areas. To search the database, visit [www.txdps.state.tx.us](http://www.txdps.state.tx.us). For information concerning past criminal activity in certain areas or neighborhoods, contact the local police department.
- (2) If the Property is located in a coastal area that is seaward of the Gulf Intracoastal Waterway or within 1,000 feet of the mean high tide bordering the Gulf of Mexico, the Property may be subject to the Open Beaches Act or the Dune Protection Act (Chapter 61 or 63, Natural Resources Code, respectively) and a beachfront construction certificate or dune protection permit may be required for repairs or improvements. Contact the local government with ordinance authority over construction adjacent to public beaches for more information.
- (3) If the Property is located in a seacoast territory of this state designated as a catastrophe area by the Commissioner of the Texas Department of Insurance, the Property may be subject to additional requirements to obtain or continue windstorm and hail insurance. A certificate of compliance may be required for repairs or improvements to the Property. For more information, please review *Information Regarding Windstorm and Hail Insurance for Certain Properties* (TXR 2518) and contact the Texas Department of Insurance or the Texas Windstorm Insurance Association.
- (4) This Property may be located near a military installation and may be affected by high noise or air installation compatible use zones or other operations. Information relating to high noise and compatible use zones is available in the most recent Air Installation Compatible Use Zone Study or Joint Land Use Study prepared for a military installation and may be accessed on the Internet website of the military installation and of the county and any municipality in which the military installation is located.
- (5) If you are basing your offers on square footage, measurements, or boundaries, you should have those items independently measured to verify any reported information.

(6) The following providers currently provide service to the Property:

Electric: <u>TXU Energy</u>	phone # <u>855-310-0988</u>
Sewer: <u>City of Hedwig Village</u>	phone # <u>713-461-4797</u>
Water: <u>Memorial Village Water Authority</u>	phone # <u>713-465-8318</u>
Cable: _____	phone #: _____
Trash: <u>Texas Pride Disposal</u>	phone # <u>281-342-8178</u>
Natural Gas: <u>CenterPoint Energy</u>	phone # <u>713-659-2111</u>
Phone Company: _____	phone #: _____
Propane: _____	phone #: _____
Internet: _____	phone #: _____

(7) This Seller's Disclosure Notice was completed by Seller as of the date signed. The brokers have relied on this notice as true and correct and have no reason to believe it to be false or inaccurate. **YOU ARE ENCOURAGED TO HAVE AN INSPECTOR OF YOUR CHOICE INSPECT THE PROPERTY.**

The undersigned Buyer acknowledges receipt of the foregoing notice.

\_\_\_\_\_  
Signature of Buyer    Date

Printed Name: \_\_\_\_\_

\_\_\_\_\_  
Signature of Buyer    Date

Printed Name: \_\_\_\_\_



9430 White Chapel  
Houston, TX 77074

Phone # 713-772-7522  
Fax # 713-772-7432

meagan@trustjericho.com  
www.trustjericho.com

# Statement

Date
11/14/2012

To:
Soon Kim 818 Chowning Houston, TX 77024

			Amount Enc.
Date	Transaction	Amount	Balance
10/14/2011	Balance forward		0.00
11/01/2012	INV #991. Due 11/01/2012.	3,850.00	3,850.00
11/05/2012	--- Exterior Piling, 11 @ \$350.00 = 3,850.00 PMT #1729.	-3,850.00	0.00
		<b>Total Amount Due</b>	<b>Current Amount Due</b>
		\$0.00	0.00



# JERICHO FOUNDATION REPAIRS

ADDRESS 818 Chowning KEY MAP 490 L  
NAME Sibok Kim PHONE 713-825-5909  
CALCULATED BY Tim Duffy DATE 11-2-12

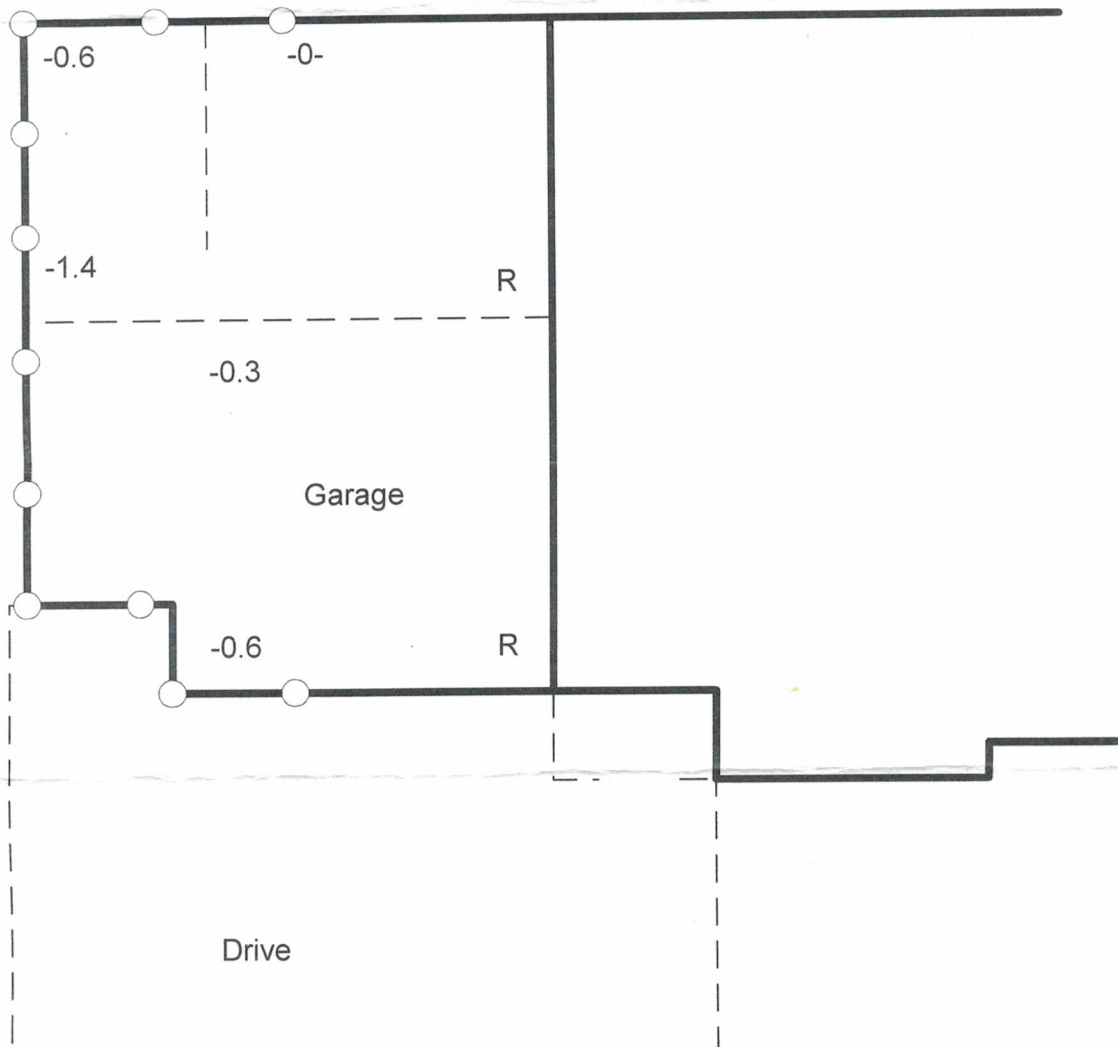



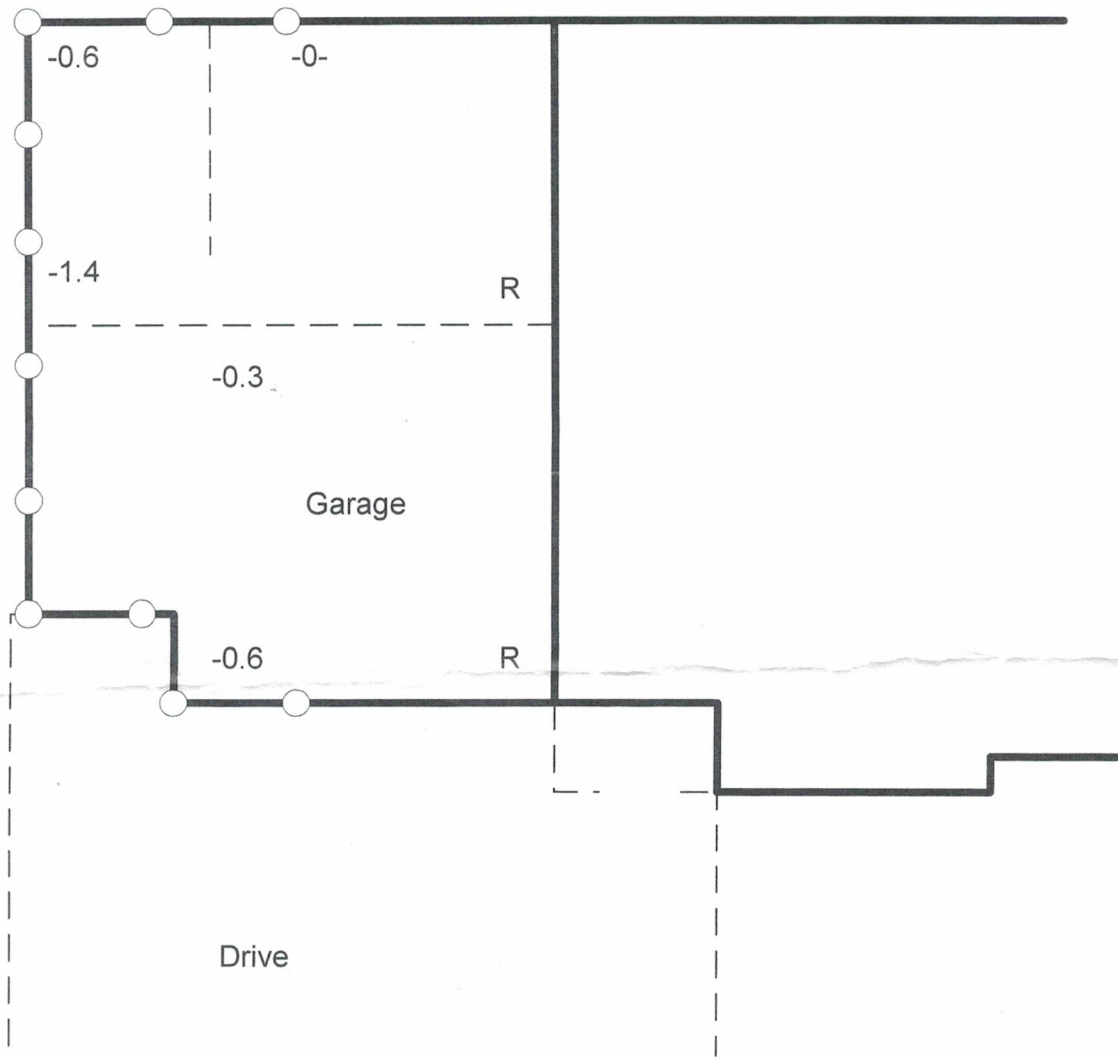

Final Elevations Taken  
11-2-12

**EXTERIOR PILINGS - 11**  
**INTERIOR PILINGS -**  
**ADJUSTMENTS -**  
**TUNNELING -**  
**TOTAL COST - \$3,850**

- = NEW PILING
- = OLD PILING
- = ADJUSTED PILING

SCALE	<u>1" = 10'</u>
STORY	<u>TWO</u>
BRICK	<u>YES</u>

[WWW.JERICHOFUNDATIONREPAIRS.COM](http://WWW.JERICHOFUNDATIONREPAIRS.COM)

9430 WHITE CHAPEL HOUSTON, TX 77074 PHONE: 713-772-7522 FAX: 713-772-7432

## JERICO FOUNDATION REPAIR WARRANTY

**JERICO FOUNDATION REPAIRS, INC.** warrants to Sibok and Soon Kim that should movement occur at the property known as 818 Chowning Road in the City of Houston, Texas in the area repaired by **JERICO FOUNDATION REPAIRS, INC.** in November of 2012, that **JERICO FOUNDATION REPAIRS, INC.** will adjust the foundation at no cost, ONLY in the areas originally underpinned by Jericho, to bring it back to the elevations shown on the attached drawing.

*This lifetime warranty covers only the areas underpinned by Jericho provided that:*

1. The structure has not been altered, modified, or additions made to it without prior written approval of Jericho.
2. The structure has not suffered fire, flood\*, or storm damage. \*Flood damage shall include water or sewer leaks under or adjacent to the foundation.
3. In the event change of ownership occurs, assignment of this warranty to a new owner or owners must be accomplished within thirty (30) days of the transfer of title. Assignments made will be in accordance with the procedures in effect at the time of transfer. The transfer fee is subject to change.

**SHOULD ASSIGNMENT NOT BE PROPERLY MADE, THIS WARRANTY IS VOID.**

*Written notice of change of ownership provided by a copy of the deed of trust or other closing document, along with payment of a \$200.00 transfer fee, should be made payable to Jericho Foundation Repairs, Inc. and sent to: 9430 White Chapel, Houston, Texas 77074*

*Transfer information may be faxed to (713) 772-7432 or emailed to [sylvia@trustjericho.com](mailto:sylvia@trustjericho.com)*

*We accept cash, checks, M/C, Visa and Discover.*



Tim P. Duffy, President

November 9, 2012

Date



**ADDENDUM FOR SELLER'S DISCLOSURE OF INFORMATION ON LEAD-BASED PAINT AND LEAD-BASED PAINT HAZARDS AS REQUIRED BY FEDERAL LAW**

CONCERNING THE PROPERTY AT 818 Chowning Rd, Houston  
 (Street Address and City)

**A. LEAD WARNING STATEMENT:** "Every purchaser of any interest in residential real property on which a residential dwelling was built prior to 1978 is notified that such property may present exposure to lead from lead-based paint that may place young children at risk of developing lead poisoning. Lead poisoning in young children may produce permanent neurological damage, including learning disabilities, reduced intelligence quotient, behavioral problems, and impaired memory. Lead poisoning also poses a particular risk to pregnant women. The seller of any interest in residential real property is required to provide the buyer with any information on lead-based paint hazards from risk assessments or inspections in the seller's possession and notify the buyer of any known lead-based paint hazards. A risk assessment or inspection for possible lead-paint hazards is recommended prior to purchase."

**NOTICE: Inspector must be properly certified as required by federal law.**

**B. SELLER'S DISCLOSURE:**

- 1. PRESENCE OF LEAD-BASED PAINT AND/OR LEAD-BASED PAINT HAZARDS (check one box only):
  - (a) Known lead-based paint and/or lead-based paint hazards are present in the Property (explain): \_\_\_\_\_
  - (b) Seller has no actual knowledge of lead-based paint and/or lead-based paint hazards in the Property.
- 2. RECORDS AND REPORTS AVAILABLE TO SELLER (check one box only):
  - (a) Seller has provided the purchaser with all available records and reports pertaining to lead-based paint and/or lead-based paint hazards in the Property (list documents): \_\_\_\_\_
  - (b) Seller has no reports or records pertaining to lead-based paint and/or lead-based paint hazards in the Property.

**C. BUYER'S RIGHTS (check one box only):**

- 1. Buyer waives the opportunity to conduct a risk assessment or inspection of the Property for the presence of lead-based paint or lead-based paint hazards.
- 2. Within ten days after the effective date of this contract, Buyer may have the Property inspected by inspectors selected by Buyer. If lead-based paint or lead-based paint hazards are present, Buyer may terminate this contract by giving Seller written notice within 14 days after the effective date of this contract, and the earnest money will be refunded to Buyer.

**D. BUYER'S ACKNOWLEDGMENT (check applicable boxes):**

- 1. Buyer has received copies of all information listed above.
- 2. Buyer has received the pamphlet *Protect Your Family from Lead in Your Home*.

**E. BROKERS' ACKNOWLEDGMENT:** Brokers have informed Seller of Seller's obligations under 42 U.S.C. 4852d to: (a) provide Buyer with the federally approved pamphlet on lead poisoning prevention; (b) complete this addendum; (c) disclose any known lead-based paint and/or lead-based paint hazards in the Property; (d) deliver all records and reports to Buyer pertaining to lead-based paint and/or lead-based paint hazards in the Property; (e) provide Buyer a period of up to 10 days to have the Property inspected; and (f) retain a completed copy of this addendum for at least 3 years following the sale. Brokers are aware of their responsibility to ensure compliance.

**F. CERTIFICATION OF ACCURACY:** The following persons have reviewed the information above and certify, to the best of their knowledge, that the information they have provided is true and accurate.

_____ Buyer	_____ Date	<u>[Signature]</u> Seller	<u>9/26/21</u> Date
_____ Buyer	_____ Date	<u>[Signature]</u> Seller	<u>9/26/21</u> Date
_____ Other Broker	_____ Date	<u>[Signature]</u> Listing Broker	<u>9/26/21</u> Date

The form of this addendum has been approved by the Texas Real Estate Commission for use only with similarly approved or promulgated forms of contracts. Such approval relates to this contract form only. TREC forms are intended for use only by trained real estate licensees. No representation is made as to the legal validity or adequacy of any provision in any specific transactions. It is not suitable for complex transactions. Texas Real Estate Commission, P.O. Box 12188, Austin, TX 78711-2188, 512-936-3000 (<http://www.trec.texas.gov>)



# Information About Brokerage Services

11-2-2015

Texas law requires all real estate license holders to give the following information about brokerage services to prospective buyers, tenants, sellers and landlords.

## TYPES OF REAL ESTATE LICENSE HOLDERS:

- A **BROKER** is responsible for all brokerage activities, including acts performed by sales agents sponsored by the broker.
- A **SALES AGENT** must be sponsored by a broker and works with clients on behalf of the broker.

## A BROKER'S MINIMUM DUTIES REQUIRED BY LAW (A client is the person or party that the broker represents):

- Put the interests of the client above all others, including the broker's own interests;
- Inform the client of any material information about the property or transaction received by the broker;
- Answer the client's questions and present any offer to or counter-offer from the client; and
- Treat all parties to a real estate transaction honestly and fairly.

## A LICENSE HOLDER CAN REPRESENT A PARTY IN A REAL ESTATE TRANSACTION:

**AS AGENT FOR OWNER (SELLER/LANDLORD):** The broker becomes the property owner's agent through an agreement with the owner, usually in a written listing to sell or property management agreement. An owner's agent must perform the broker's minimum duties above and must inform the owner of any material information about the property or transaction known by the agent, including information disclosed to the agent or subagent by the buyer or buyer's agent.

**AS AGENT FOR BUYER/TENANT:** The broker becomes the buyer/tenant's agent by agreeing to represent the buyer, usually through a written representation agreement. A buyer's agent must perform the broker's minimum duties above and must inform the buyer of any material information about the property or transaction known by the agent, including information disclosed to the agent by the seller or seller's agent.

**AS AGENT FOR BOTH - INTERMEDIARY:** To act as an intermediary between the parties the broker must first obtain the written agreement of each party to the transaction. The written agreement must state who will pay the broker and, in conspicuous bold or underlined print, set forth the broker's obligations as an intermediary. A broker who acts as an intermediary:

- Must treat all parties to the transaction impartially and fairly;
- May, with the parties' written consent, appoint a different license holder associated with the broker to each party (owner and buyer) to communicate with, provide opinions and advice to, and carry out the instructions of each party to the transaction.
- Must not, unless specifically authorized in writing to do so by the party, disclose:
  - that the owner will accept a price less than the written asking price;
  - that the buyer/tenant will pay a price greater than the price submitted in a written offer; and
  - any confidential information or any other information that a party specifically instructs the broker in writing not to disclose, unless required to do so by law.

**AS SUBAGENT:** A license holder acts as a subagent when aiding a buyer in a transaction without an agreement to represent the buyer. A subagent can assist the buyer but does not represent the buyer and must place the interests of the owner first.

## TO AVOID DISPUTES, ALL AGREEMENTS BETWEEN YOU AND A BROKER SHOULD BE IN WRITING AND CLEARLY ESTABLISH:

- The broker's duties and responsibilities to you, and your obligations under the representation agreement.
- Who will pay the broker for services provided to you, when payment will be made and how the payment will be calculated.

**LICENSE HOLDER CONTACT INFORMATION:** This notice is being provided for information purposes. It does not create an obligation for you to use the broker's services. Please acknowledge receipt of this notice below and retain a copy for your records.

PRD, Inc.	0236882	young@prdinc.com	(713) 789-0220
Licensed Broker/Broker Firm Name or Primary Assumed Business Name	License No.	Email	Phone
Young Park	0236882	young@prdinc.com	(713) 256-5766
Designated Broker of Firm	License No.	Email	Phone
Young Park	0236882	young@prdinc.com	(713) 256-5766
Licensed Supervisor of Sales Agent/ Associate	License No.	Email	Phone
Soon Kim	0329647	sibokkim@yahoo.com	(713) 825-5909
Sales Agent/Associate's Name	License No.	Email	Phone

Buyer/Tenant/Seller/Landlord Initials

AK SK

9/26/2021

Date

Regulated by the Texas Real Estate Commission

Information available at [www.trec.texas.gov](http://www.trec.texas.gov)  
IABS 1-0  
TAR 2501