

PIRATES BEACH
 SECTION 8
 Vol 18, Pg 105
 MRGC

NOTES:
 NO RECORDS SEARCH CONTRACTED.
 SURVEY PREPARED FROM TITLE
 COMPANY SPECIFICATIONS PROVIDED
 BY CLIENT AS PER STEWART TITLE, OF
 #09208739. CLIENT RELIES SOLELY ON
 TITLE COMPANY SPECIFICATIONS AS TO
 RECORD EASEMENTS, RESTRICTIONS,
 ROADWAYS, RIGHTS-OF-WAY, BUILDING
 LINES, ENCUMBRANCES, ETC.;
 CLIENT AND TITLE COMPANY HOLD
 TLTS, INC. HARMLESS FROM RESPONSIBILITY
 FOR SAME

- Restrictions as per recorded plat unless otherwise noted
- True ground distances shown
- Bearings assumed as platted
- Vol 1810, Pg 179, OCCGC
- 8' side building lines
- 5' deck, porch & overhangs
- Survey monuments reconciled w/numerous previous surveys

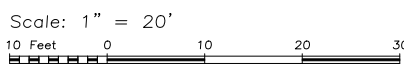

LAND TITLE SURVEY OF A TRACT OF LAND being Lot 4, in Block 16, of PIRATES BEACH, SECTION 2, a subdivision in Galveston County, Texas, according to the map or plat thereof, recorded in Volume 1616, Page 67 and transferred to Plat Record 8, Map No. 1, both in the Office of the County Clerk of Galveston County, Texas.

Subject property: 4111 Pirates Drive
 Galveston County, Texas
 To Erik Groeneveld, Courtney Groeneveld
 and Alta Vista Development, LLC;
 I hereby certify that this survey was made on the ground under my direct supervision and that this plat correctly represents the facts found at the time of the survey.

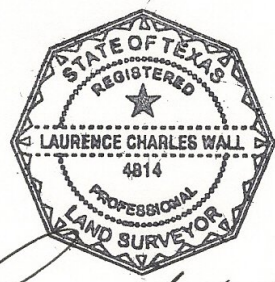

Laurence C. Wall

Laurence C. Wall
 RPLS #4814
 July 21, 2015

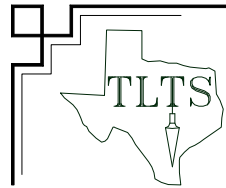

TLTS, Inc.
 TEXAS LAND TITLE SURVEYORS
 1801 Moody Avenue
 Galveston, Texas 77550
 (409) 765-8883