

# N

# 1827 Waters Branch Dr. - Jackson Plan SIENNA 45' - Heritage Park - Section 29A

## NEW HOME COMING SOON!

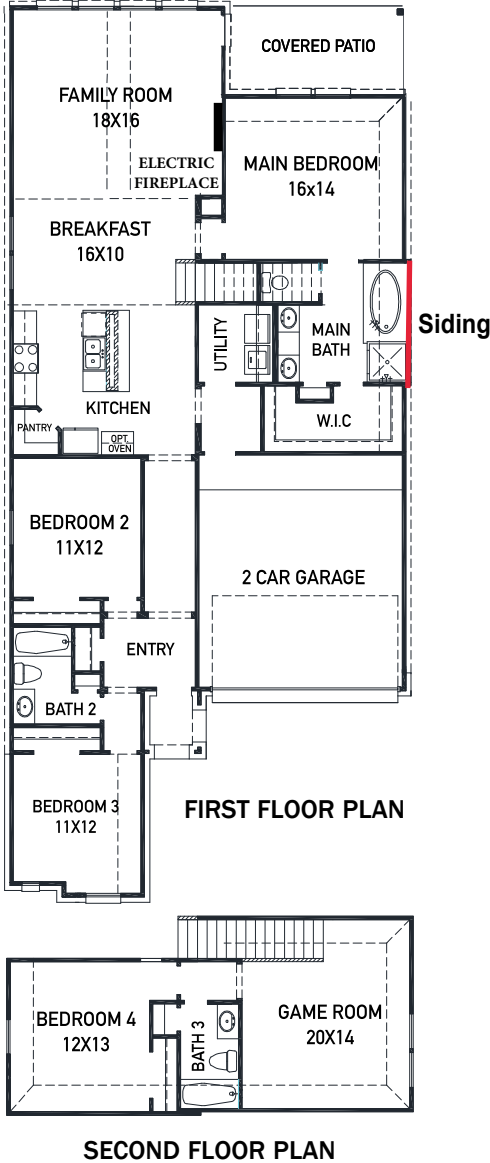

- Upgraded front elevation w/ brick on 1st floor sides/back
- Built in appliances w/ a 36" 5 burner gas cook-top
- Modern 42" kitchen cabinetry w/ hardware
- Quartz countertops in the kitchen & bathrooms
- Elegant hardwood floors in the main living areas
- Upgraded 8 ft. front door
  
- **THE NEWMARK STANDARD IN SIENNA**
- Open cell spray foam insulation
- 16 seer dual stage HVAC system
- Full sprinkler system & sod
- Full rain gutters
- Environments for living builder
- 3rd party inspections (Foundation, frame, energy, final)

### FEATURES

- 2 Story - Apx: 2297 sqft.
- 4 Bedrooms - 3 Bathrooms
- 2 Car Garage
- 45 x 131 Homesite - 5927 sqft.
- Estimated Completion: Feb. 2022

REV 8/20 (451J)



These drawings are conceptual only and are for the convenience of reference. They should not be relied upon as representations, express or implied, of the final detail of the residences. The builder expressly reserves the right to make modifications, revisions, and changes it deems desirable in its sole and absolute discretion. Dimensions and square footages are approximate and may vary with actual construction.

**NEWMARK**  
HOMES

[newmarkhomes.com](http://newmarkhomes.com)