

AUSTIN

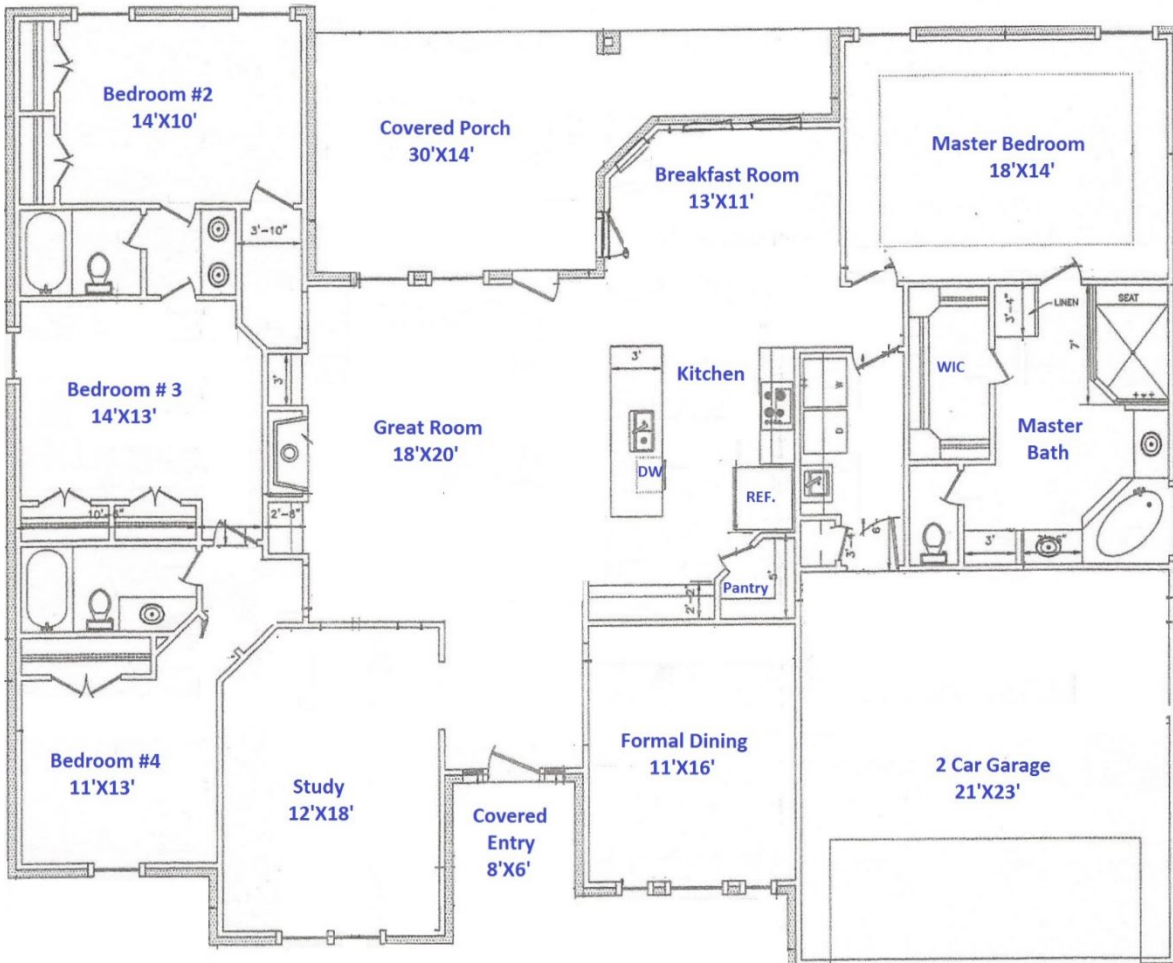

- Sq. Footage - 2,675'
- Bedrooms - 4
- Bathrooms - 3
- Garage - 2
- Formal Dining
- Study



FLOOR PLANS AND ELEVATIONS ARE SUBJECT TO CHANGE AT BUILDERS DISCRETION.
 DIMENSIONS ARE APPROXIMATE.