

## Building Sketch

|                  |                                   |               |          |                |
|------------------|-----------------------------------|---------------|----------|----------------|
| Borrower         | Roderick Hardeman                 |               |          |                |
| Property Address | 1214 Larks Trace Ln               |               |          |                |
| City             | Houston                           | County Harris | State TX | Zip Code 77090 |
| Lender/Client    | Carrington Mortgage Services, LLC |               |          |                |

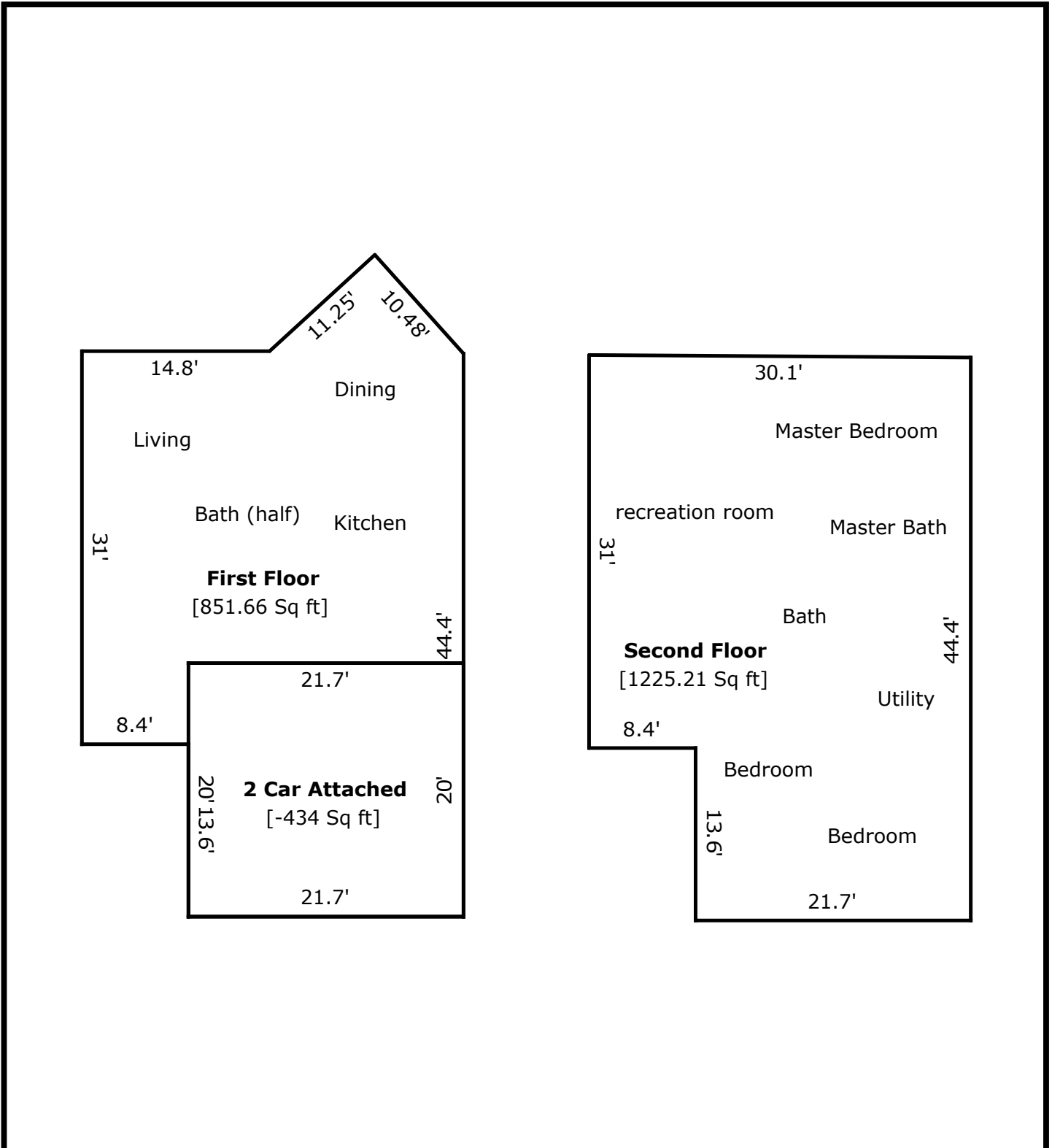

TOTAL Sketch by a la mode, inc.

### Area Calculations Summary

| Living Area                         | Area              | Calculation Details   |
|-------------------------------------|-------------------|---|
| 2 Car Attached                      | -434 Sq ft        | $20 \times 21.7 = 434$  |
| First Floor                         | 1285.66 Sq ft     | $0.5 \times 15.12 \times 7.6 = 57.46$<br>$0.5 \times 0.18 \times 0.2 = 0.02$<br>$29.92 \times 0.2 = 5.98$<br>$30.1 \times 30.8 = 927.08$<br>$21.7 \times 13.6 = 295.12$ |
| Second Floor                        | 1225.21 Sq ft     | $21.7 \times 13.6 = 295.12$<br>$30.1 \times 30.8 = 927.08$<br>$0.5 \times 30.1 \times 0.2 = 3.01$   |
| <b>Total Living Area (Rounded):</b> | <b>2077 Sq ft</b> |   |