

FLOORPLAN SKETCH

Client: Michael & Courtney Guerin
 Property Address: 20311 Cortina Valley Dr
 City: Cypress

File No.: 20311 Cortina Valley
 Case No.:
 State: Tx Zip: 77433

Sketch

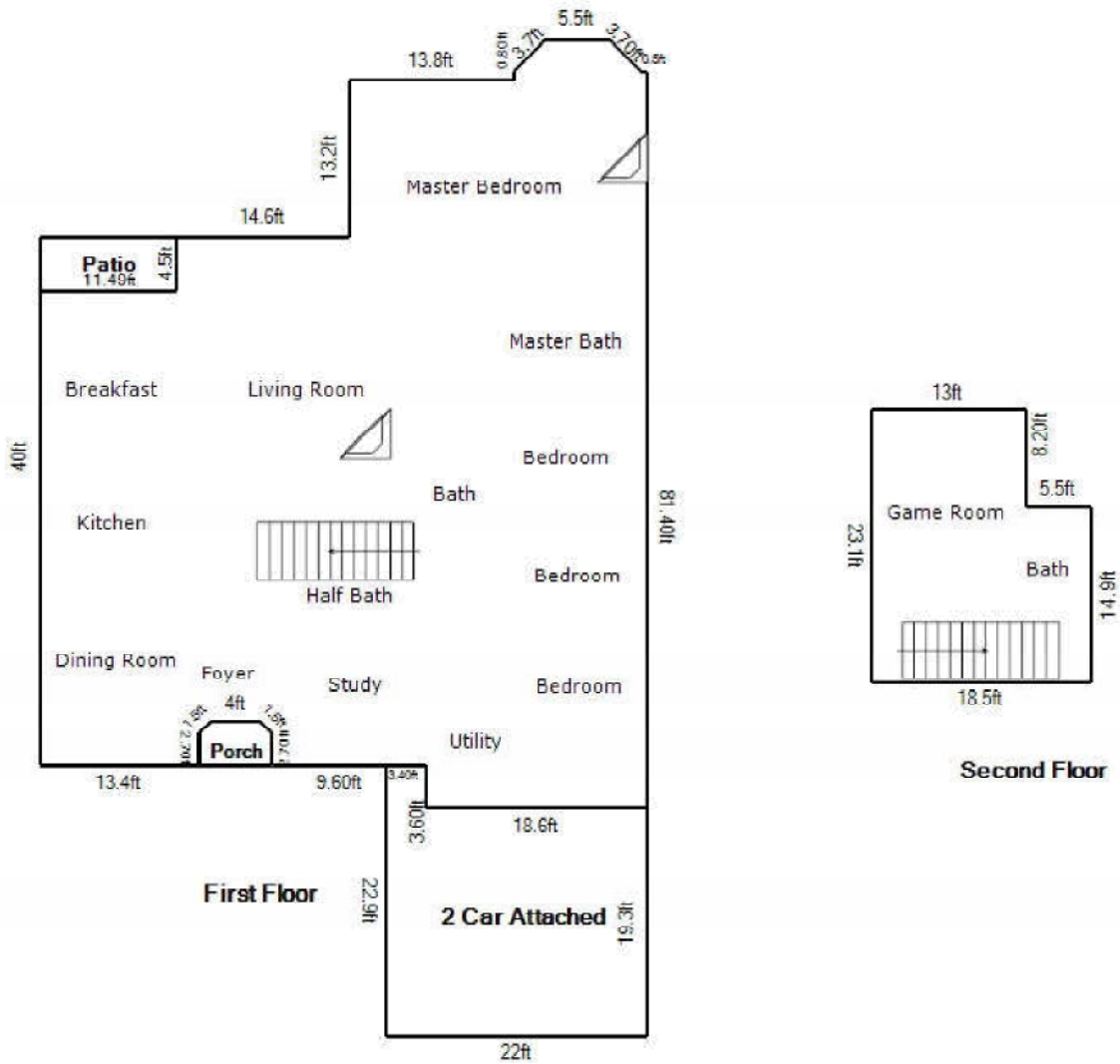

Living Area		Area Calculation			
First Floor	3065.76 ft ²	First Floor			x 1.00 = 3065.76 ft ²
2 Car Attached	-436.84 ft ²	Δ	81.40ft x 0.5ft	0.50 =	20.36 ft ²
Second Floor	302.25 ft ²	Δ	12.69ft x 41.00ft	0.50 =	265.19 ft ²
Nonliving Area		Δ	2.70ft x 2.70ft	0.60 =	3.84 ft ²
Patio	51.70 ft ²	Δ	4.01ft x 13.2ft	0.50 =	26.45 ft ²
Porch	21.90 ft ²	Δ	3.7ft x 0.80ft	0.35 =	1.05 ft ²
		Δ	3.70ft x 5.5ft	0.35 =	7.19 ft ²
		Δ	8.53ft x 4.30ft	0.47 =	17.29 ft ²
		Δ	5.32ft x 6.90ft	0.35 =	12.97 ft ²
		Δ	9.79ft x 13.79ft	0.48 =	64.63 ft ²
		Δ	10.76ft x 19.10ft	0.32 =	65.32 ft ²
		Δ	22.9ft x 22ft	0.50 =	251.0 ft ²
		Δ	43.68ft x 1.5ft	0.24 =	15.44 ft ²
		Δ	42.37ft x 4ft	0.48 =	81.48 ft ²
		Δ	41.46ft x 11.30ft	0.49 =	231.50 ft ²
		Δ	31.76ft x 81.40ft	0.34 =	889.88 ft ²
		Δ	28.25ft x 44.60ft	0.45 =	567.08 ft ²
		Δ	40.05ft x 40ft	0.02 =	38.23 ft ²
		□	4.5ft x 1.91ft	1.00 =	8.60 ft ²
		Δ	1.91ft x 40.05ft	0.50 =	38.23 ft ²
		□	11.49ft x 40ft	1.00 =	459.55 ft ²
		2 Car Attached		x -1.00 =	-436.84 ft ²
		□	3.80ft x 3.40ft	1.00 =	12.24 ft ²
		□	19.3ft x 22ft	1.00 =	424.60 ft ²
		Second Floor		x 1.00 =	382.25 ft ²
		□	8.20ft x 13ft	1.00 =	106.6 ft ²
		□	14.9ft x 18.5ft	1.00 =	275.65 ft ²
Total Living Area (rounded):	3011 ft²				