

N 43° 55' 10" E
20.00

Found 1/2" from Rod

ARTHUR LOTT SURVEY A-254 AUSTIN COUNTY, TEXAS

S 45° 58' 54" E

372.66

1.700 Ac.
1001147 1700 AC
402/164 DRACT

PG B
Found 1/2" from Rod

N 09° 04' 50" W

10' wide gravel Drive

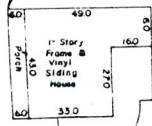

Wood Deck

Frame & Vinyl Siding Storage

Gravel Drive

1.810 AC.
402/164 DRACT
403/749 DRACT

0.110 Ac.
Portion of called 1.496 Ac.
403/749 DRACT

LONG BRANCH ROAD
1.255
0.228 Ac. 1001147 1700 AC
402/164 DRACT
0.228 Ac. 1001147 1700 AC
402/164 DRACT
Electric Service Line

Electric Service Line

1.390 Ac.
Residue of called 1.496 Ac.
403/749 DRACT

Scale 1" = 40'

N 46° 02' 52" W

72.00

103.00

This tract does not lie within the Flood Hazard Zone according to the D.H.U.D., F.I.A., Flood Hazard Boundary Map, H-01-46, Page 10, Community No. 486704, effective date February 25, 1977

*John Stepp
Sgt. H
12-2-2003*

I, Glen S. Alexander, Registered Public Surveyor, do hereby certify that the plat and/or the description shown hereon accurately represents the results of an on the ground survey made under my direction and supervision on Aug 12, 1986, and all corners are as shown hereon. There are no encroachments, conflicts, or protrusions apparent on the ground except as shown.

This survey was performed in connection with the transaction described in G.F. No. 16,984 of Belville Abstract & Title Company.

USE OF THIS SURVEY FOR ANY OTHER PURPOSE OR BY OTHER PARTIES SHALL BE AT THEIR OWN RISK AND THE UNDERSIGNED SURVEYOR IS NOT RESPONSIBLE FOR ANY LOSS RESULTING THEREFROM.

Glen S. Alexander

Glen S. Alexander - Registered Public Surveyor #4194

ROBERT ALLEN TINNIN, ETUX

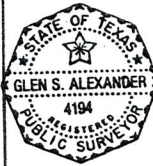

PLEDGER AND ASSOCIATES, INC.
REUE LAND SURVEYORS

1500 S. Day St. 22 N. Bell St.
P. O. Box 1736 P. O. Box 831
Brenham, Tex. 77833 Belville, Tex. 77448

GLEN S. ALEXANDER	COUNTY AUSTIN	FIELD CREW R.M.
R.P.S. No. 4194	SURVEY ARTHUR LOTT, A-254	COMPUTATIONS G.A.
DATE AUG 12, 1986	QTY	DRAFTING L.H.
UPDATE	ADDITION LONG BRANCH	WORK ORDER 0795