

Authey
Wm. Au

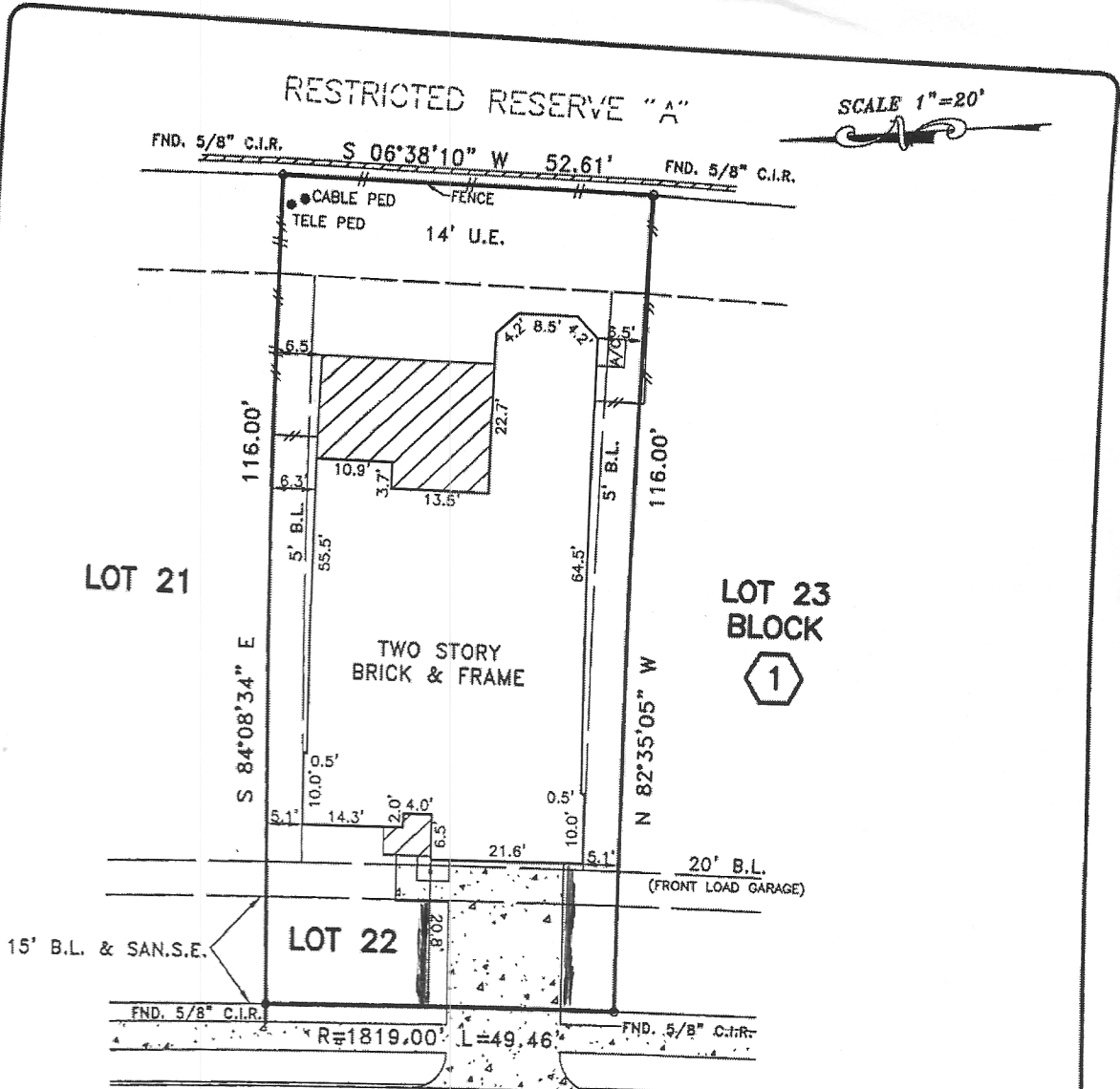

NOTES:

- ALL BEARINGS AND STREET ARE BASED ON RECORDED PLAT.
 - SURVEYOR DID NOT ABSTRACT PROPERTY. SURVEY BASED ON LEGAL DESCRIPTIONS SUPPLIED BY TITLE COMPANY. EASEMENTS, BUILDING LINES, ETC., SHOWN ARE AS IDENTIFIED BY GF NO. 1891753-H078 OF FIRST AMERICAN TITLE INSURANCE COMPANY.
 - THE FINDINGS AND OPINIONS OF SOUTH TEXAS SURVEYING ASSOCIATES, INC. REFLECTED HEREON ARE PRIVILEGED, CONFIDENTIAL AND INTENDED FOR THE USE OF THE INDIVIDUAL OR ENTITY FOR WHOM THIS WORK WAS PREPARED. IT IS UNDERSTOOD THAT THE USE OF, RELIANCE ON, OR REPRODUCTION OF SAME, IN WHOLE OR IN PART, BY OTHERS WITHOUT THE EXPRESS WRITTEN CONSENT OF SOUTH TEXAS SURVEYING ASSOCIATES, INC. IS PROHIBITED AND WITHOUT THE EXPRESS WRITTEN WARRANTY, EXPRESS OR IMPLIED, SOUTH TEXAS SURVEYING ASSOCIATES, INC. SHALL BE HELD HARMLESS AGAINST AND THAT NO LICENSE HAS BEEN CREATED, DAMAGES OR EXPENSES RESULTING FROM SUCH UNAUTHORIZED USE, RELIANCE OF REPRODUCTION. COPYRIGHT 2014. ALL RIGHTS RESERVED.
- This survey is being provided solely for the use of the current parties and no license has been created, express or implied, to copy the survey except as is necessary in conjunction with the original transaction.*

PLAT OF LOT 22, BLOCK 1 OF LEGENDS RANCH, SECTION 11
 ACCORDING TO THE MAP OR PLAT RECORDED IN CABINET Z, SHEET
 2937-2938 OF THE MAP RECORDS OF MONTGOMERY COUNTY, TEXAS.

PROPERTY LIES WITHIN FLOOD ZONE "X", ACCORDING TO F.I.R.M. MAP NO. 48339C 0685F, DATE 12-19-98, BY GRAPHING PLOTTING ONLY, WE DO NOT ASSUME RESPONSIBILITY FOR EXACT DETERMINATION. BEFORE ANY DEVELOPMENT PLANNING, DESIGN, OR CONSTRUCTION IS STARTED, THE COMMUNITY, CITY AND COUNTY IN WHICH SUBJECT TRACT EXISTS SHOULD BE CONTACTED. SAID ENTITIES MAY IMPOSE LARGER FLOOD PLAIN AND FLOODWAY AREAS THAN SHOWN BY F.I.R.M. MAPS THAT WILL AFFECT DEVELOPMENT.

PROPERTY SUBJECT TO SUBDIVISION COVENANTS, CONDITIONS AND RESTRICTIONS.

I hereby certify that this survey was made on the ground and that this plat correctly represents the facts found at the time of survey showing any improvements, from legal descriptions supplied by client. There are no encroachments apparent on the ground, except as shown. This survey is only certified for boundary and this transaction only. Surveyor did not abstract property. Easements, building lines, etc. shown are as identified by:

GF 1891753-H078 of FIRST AMERICAN TITLE INSURANCE COMPANY.



Fred W. Lawton, Registered Professional Land Surveyor No. 2321

ADDRESS: 29524 SALEM FIELDS DRIVE LENDER:
 CITY: SPRING, TEXAS ZIP: 77386
 PURCHASER:
 JOB NO: K834551 DATE: 03-21-14 SCALE: 1"=20'-00" REVISION: Key Map 253X

SOUTH TEXAS SURVEYING ASSOCIATES, INC.
 11281 Richmond Ave, Suite J-101 Houston, Texas 77082
 TEL. (281) 556-6918 FAX (281) 556-9331
 Copyright 2013 South Texas Surveying Associates, Inc. FIRM NUMBER: 10046490 M.C.