

- NOTES:
- RECORD EASEMENTS, RESTRICTIONS, ROADWAYS, RIGHTS-OF-WAY, ETC. AS PER RECORDED PLAT ONLY. OTHER RESTRICTIONS MAY APPLY.
 - True ground distances shown
 - Bearings assumed as platted
 - Survey monuments reconciled with previous surveys of Lots 529 and 530
 - City of Bayou Vista Ordinances Chapter 3 - Building codes
 - :30' setback from center of road (assumed center of asphalt roadway)
 - :20' setback from bulkhead (assumed inside wall of bulkhead)
 - :5' side setbacks (AC platforms & eaves excepted)
 - Vol 1235, Pg 603, OCCGC
 - :10' HL&P along front line

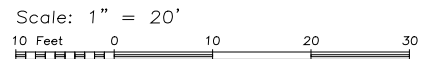

LAND TITLE SURVEY OF A TRACT OF LAND being Lot 96 of BAYOU VISTA ADDITION NO. 3, an addition in Galveston County, Texas, according to the plat thereof recorded in Volume 254A, Page 79 and transferred to Plat Record 3, Map No. 32 both of the Map Records of Galveston County, Texas.

Subject property: 96 Bayou Vista Drive
 Galveston County, Texas
 To Adrian McMillian;
 I hereby certify that this survey was made on the ground under my direct supervision and that this plat correctly represents the facts found at the time of the survey.

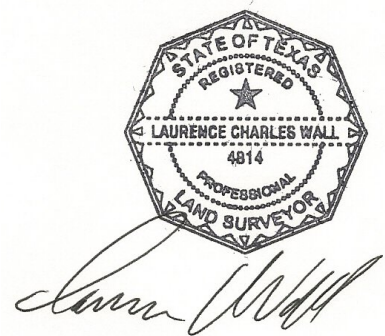

Laurence C. Wall
 RPLS #4814
 March 9, 2012

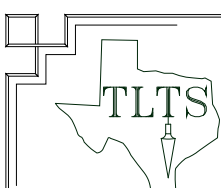

TLTS, Inc.
 TEXAS LAND TITLE SURVEYORS
 1801 Moody Avenue
 Galveston, Texas 77550
 (409) 765-8883