

## Building Sketch

Borrower	Claudia Y & Scott C Rohr			
Property Address	1015 W 31st St			
City	Houston	County Harris	State TX	Zip Code 77018
Lender/Client	GSF Mortgage Corporation			

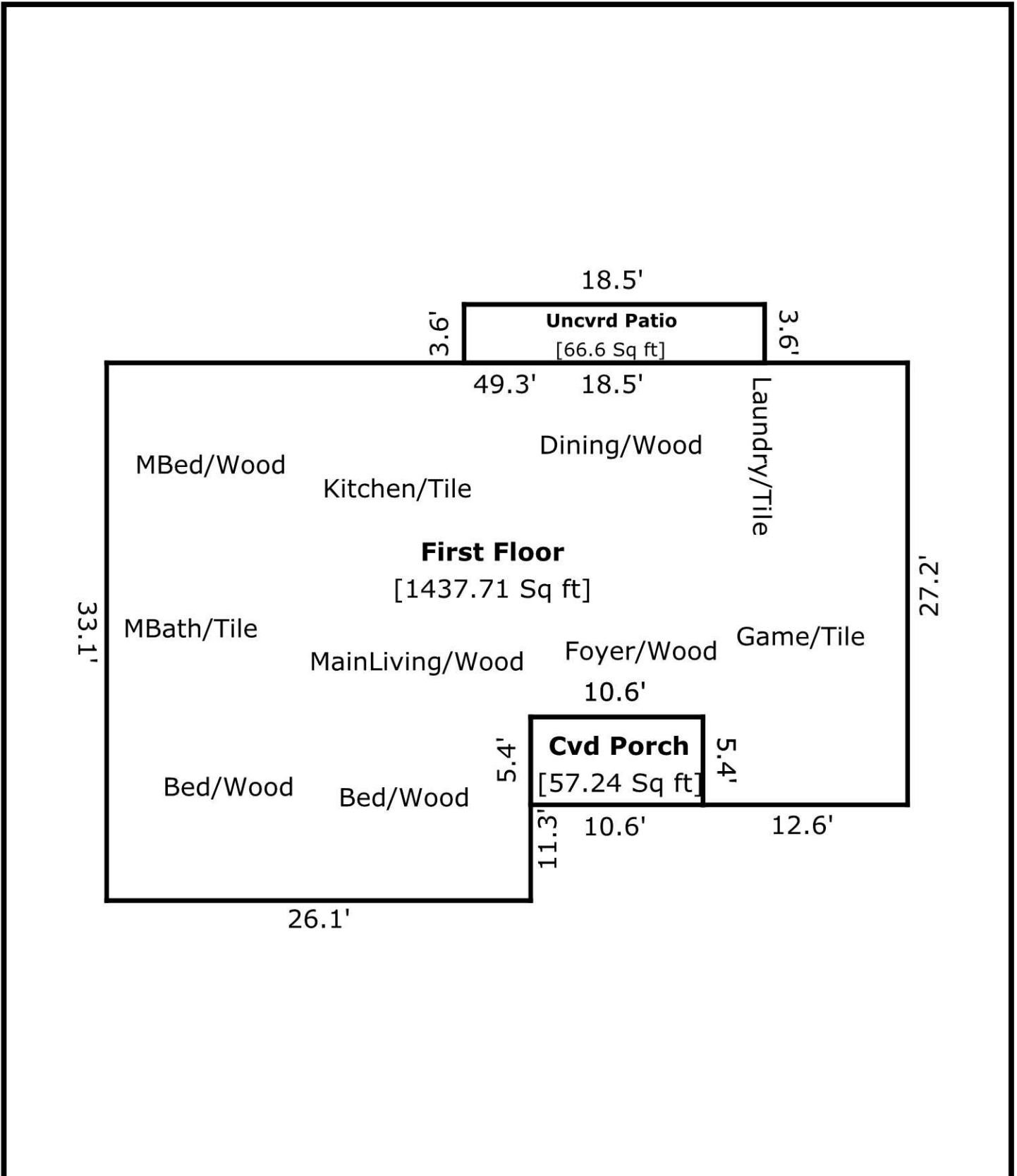

TOTAL Sketch by a la mode, inc.

### Area Calculations Summary

Living Area	Area	Calculation Details
First Floor	1437.71 Sq ft	$33.1 \times 26.1 = 863.91$ $23.2 \times 21.8 = 505.76$ $5.4 \times 12.6 = 68.04$
<b>Total Living Area (Rounded):</b>	<b>1438 Sq ft</b>	
Non-living Area	Area	Calculation Details
Cvd Porch	57.24 Sq ft	$5.4 \times 10.6 = 57.24$
Uncvr'd Patio	66.6 Sq ft	$18.5 \times 3.6 = 66.6$