

S 89°35'28" E
329.85'

Homer Gilbert
246/437

2.498
ACRES
9.498 AC
20145768

WBL 9.498 AC
329.91'
N 00°35'09" W

GILBERT ROAD

POINT OF
BEGINNING
1/2" IR
SWC 9.498 AC

60' R/W 155/745 & 181/459

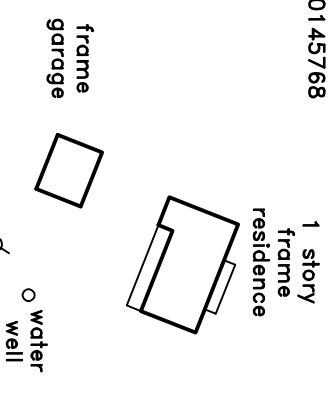

S 00°35'09" E
329.91'

103.56'

EBL 9.498 AC

Kelso
20 AC
04-181

HENRY W. FARLEY
A-113

Rcvd. 1 lge & labor as 1834 immigrant
served with Liberty Volunteers J-O 1835
& D35 - Feb. 36 - bound for Alamo, but
failed to reach defenders in time

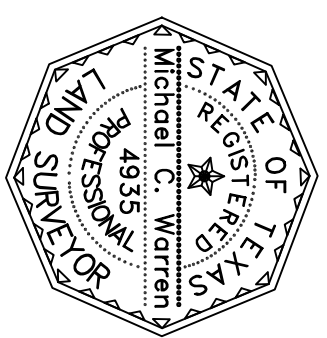
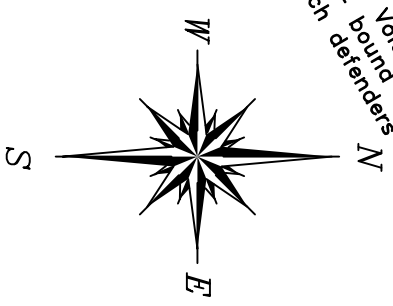

I hereby certify that this survey was made
on the ground under my supervision and that this
drawing correctly represents the facts found
29 June 2018

Michael C. Warren
Registered Professional Land Surveyor No. 4935

QUADRANT SOLUTIONS
& BEARIN' TREE SEMINARS
FOR LAND SURVEYORS
TBP L'S C.E.U.'S
P.O. 1343 WILLIS, 77378
(936) 856-8989
PROJECT NO.: 481418A

LAND TITLE SURVEY
FOR: JOE BRAWNER & MARY BRAWNER
401 GILBERT ROAD
SHEPHERD, TEXAS 77371
BEING a 2.498 acre tract of land
situated in the Henry W. Farley League,
Abstract No. 113, San Jacinto County,
Texas, part of that 9.498 acre tract
described in deed dated October 16,
2014 from Paula Calhoun aka Poteet
to Chad Brauner, recorded under Clerk's
File No. 20145768, Page 24700 of the
Official Public Records of San Jacinto
County, Texas.